



## RPI Now Offers Parts to Fit Sterrad NX & 100S Sterilizers

Planned Maintenance continues to be a driving factor in keeping equipment on line and productive.

In 2014 we were asked to investigate the possibility of developing the Planned Maintenance Kits for Sterrad sterilizers, models NX and 100S. As the requests for the parts and PM Kits

grew, so did our enthusiasm and now we are pleased to offer three new Planned Maintenance Kits.

We now offer the PM-2 Kit (RPI Part #SDK003) to fit the NX. This annual maintenance Kit addresses the basic wear items such as shelf supports, electrode spacers, lamp assembly, and filters – along with several other service parts. (The only item not included in the RPI major PM Kit at this time is the catalytic converter, however, we are in the process of developing

*Continued on the back page*

## RPI Continues Support for the Midmark® 411 (75L) Power Exam Tables

When Midmark® recently discontinued support for the 411 (75L) Power Exam Tables, RPI was contacted by many upset service technicians looking for ways to help the hundreds of clinics and doctor's offices that currently own and love their 411's.

So, we carefully reviewed the tables and developed an action plan based on the parts our customers needed most.

*Continued on the back page*

**For some great Service Tips on the Sterrad NX & 100S, you will find them on page 3.**

## More New Parts to Fit Dental Vacuum Units

*By Mark Micucci, RPI Product Development*

Adding to RPI's ever increasing line of parts for Dental Vacuum Systems, RPI is proud to announce yet another set of new parts to help you service your customers' dry and wet ring vacuum systems.

For the DentalEZ® line of Dry Vacuum Systems, RPI now offers the Filter Kits to fit the Badger, Bulldog and Bison Series units.

For the Badger Units, RPI offers a Filter Kit that includes both the large and small 5 micron Filter Elements. Just ask for RPI Part #VPK110.

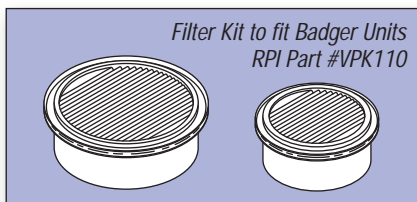

For the Bulldog 550 & QT Series, RPI offers RPI Part #VPK113, the Filter Kit that includes the Oil Filter Element, the 3 micron Filter Element and the medium size 5 micron Filter Element.



And for the Bison Series, ask for the RPI Part #VPK117 Filter Kit, which includes the Oil Filter Element, the medium size 5 micron Filter Element and the larger 5 micron Filter Element.

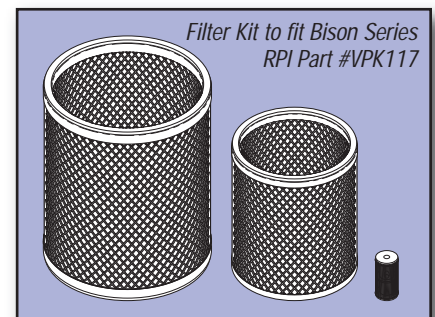

As with all RPI Filter Kits, all parts are also sold separately.

For the separator tanks, RPI offers the Separator Lid Gaskets for both sizes of Midmark® PowerMax and PowerMax G separator tanks, along with the CAS (Cyclone Action Separator) Cover Gasket to fit the Air Techniques units.

Also, for the Air Techniques CAS systems, the Drain Assembly is available as a complete Kit, along with the Drain Valve by itself. The Gasket to fit the DentalEZ® 4000/8000 DryMax Flange is also now available.

*Continued on the back page*

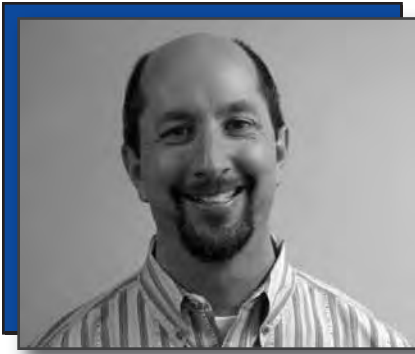

*Ira Lapidés  
CEO & President  
Replacement Parts Industries, Inc.*

## FROM THE DESK OF THE PRESIDENT

In our Spring, 2016 newsletter, I wrote about our plan to transition to new enterprise software, converting from our 30 plus year old software to a new, modern, and more capable platform. On July 5th of this year, we went live on our new software, which includes all of our accounting, sales order, customer, inventory, supplier, and all of our other modules. It was an enormous task, but everyone here was up to the challenge, and the transition went fairly well.

As to be expected, there were a few hitches, and we are continuing to work to get the software where we need it to be to allow us to continue to provide you with excellent service and parts. The inventory side of things ended up with a couple of unexpected snags, and our backorders spiked for a little while, but we are in much better shape now and will continue to work to make improvements in that area to minimize backorders as much as possible. We will be adding additional software modules over time and streamlining processes as we are always looking for ways to improve, and as always, your feedback and suggestions are always welcome.

I must thank all of our customers for your patience during this transition, as I know we fell short a few times from our normal level of service. I sincerely apologize if this caused you any problems. We tried to anticipate all potential issues, but with a software conversion it is sometimes impossible to catch everything in advance. We will do everything possible to maintain the level of service and parts availability that you are accustomed over these many years, and hopefully, make some nice improvements that will benefit you down the road.

On a different note, many of you might also be aware of the docket that the FDA opened for comment this past April regarding definitions and clarification of terms such as refurbisher, remarketer, remanufacturer, and service, and asking for feedback on the potential for regulation of refurbishers and servicers of medical equipment (remarketers and remanufacturers are already regulated by the FDA).

This drew quite a response from the medical equipment, service, and healthcare industries, and parties from all corners submitted feedback to the FDA. The comments were quite varied, and it would be worth your time to visit the FDA website to read some of the feedback they received and keep up to date on this important matter. The FDA also held an informational conference the end of October with interested parties to discuss these issues, so we will see what comes of this.

The FDA took a look at this issue back in the late 1990's and came away with the decision not to regulate these additional areas. Excellent data was provided by the ECRI Institute back then, and now again in 2016 evidencing a lack of issues with OEM or aftermarket service. It will be interesting to see what the FDA decides to do this time around, but if they decide to move toward regulation, the ramifications will be quite significant and I believe quite damaging to our industry as a whole. However possible, get informed on this issue and get involved. It will have significant impact on your job and your business.

We wish you happy holidays, and the very best to you in the coming New Year!

## THE RPI FAMILY

Hello my name is Jocelyn.

I grew up here in the San Fernando Valley where I graduated from San Fernando High School. I'm the youngest of four children.

I am a mother to a beautiful baby girl named Elizabeth. We spend our time playing dress up and having tea parties with her stuffed animals.

My daughter amazes me everyday. I've watched her grow from wearing dirty diapers to now wanting to do everything on her own (without Mommy's or Daddy's help). She is my world.

In my spare time I enjoy hiking with my friends, because it takes me out of my comfort zone.

I also enjoy the spectacular areas that this part of California offers. My favorite spot is Malibu with the beautiful hills and blue ocean views.

I also love visiting my family. And since they are close by, I get to spend time with all my loved ones including my niece and nephews.

We spend most of our family nights playing board games and watching movies while enjoying fresh baked cookies. I think that the best way to end the weekend is with the familia.

I have been working at RPI in the Shipping and Warehouse Department since 2014. It is a pleasure to work with Brian, my Supervisor, and the rest of the crew.

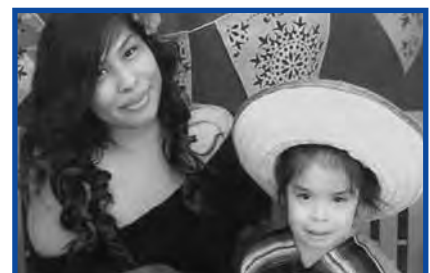

*Jocelyn Villeda  
Shipping & Warehouse*

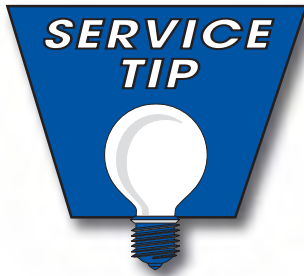

# Sterrad NX & 100S

## Service Tips and Helpful Hints

By Phil Goldstein and Chris Jacobs, RPI Product Development

**B**elow you will find useful tips to help make life a little easier when servicing the Sterrad NX scope reprocessor. There is valuable information from simple time savers to service tips that can keep you safe when removing parts from the unit during servicing.

- While removing the top cover, if the machine has been on for a while, be careful of the door closing mechanism. It is very hot along with several valves that are part of the vaporizer/condenser assembly.

- When installing a new conical screen filter or oil mist filter, make sure to note the direction of the two large clamps (side by side) that allow access to both filters. It is easiest to remove and place these two clamps back together at the same time, using the clamp associated with the conical filter as a point of reference. Also note the direction of the shaft leading to the oil mist filter. There is one side of this shaft that is short and one that is just slightly longer. The shaft must be placed with the shorter side attaching to the clamp.

- If cassettes that were placed in the machine ejected immediately, those cassettes are no longer usable even if they were never punctured. This is due to the barcode reader. There is a way to clear the memory for the barcode reader so you may use those cassettes again. Here's what to do: The keyboard must be connected to the machine. At the login screen, press **CRTL+ALT+M**, you will see a command prompt "sh-2.06b#" in the upper left corner. Type in **cd /idew** (include the space after cd) and press **ENTER**. Then type in **ls -a** (the first letter is a lower case L and include the space after ls) and press **ENTER**. You will

see all the files in the /idew directory and will see a specific file called ".laser.dat". You will need to type **rm .laser.dat** (include the space after rm) and press **ENTER**. This will remove the laser file and you can check to see it's removed by typing the **ls -a** and press **ENTER**. Now that you have removed the file, press **CRTL+ALT+M** and reboot the system. Now login as service and insert a cassette. After inserting the cassette there will be an error message saying "invalid cassette database, please call ASP" then the unit will eject the cassette. Press **Additional Utilities, Service Functions**, and then **Cassette**. Press the **RESET** button on the lower right of the screen. This is the final step in clearing your barcode reader's memory. This process removes the system's memory for cassettes which allows unused cassettes that were ejected during testing of the machine to be reused. It is not to allow the use of expired cassettes. If you are unable to use the unused cassettes repeat the steps listed above and try again.

- Many of the door sensor problems can be caused by the smallest of particles getting on the door locking mechanism's sensor. Use a small Q-tip® or microfiber cloth on the sensor to remove any particles, and the errors should not appear.

- When replacing the catalytic converter, oil mist filter, the conical screen filter or any part of the vacuum pump assembly that involves removing the three large clamp assemblies, take note as to which direction the straight lever on the clamp is facing. Facing the straight lever towards the back of the NX allows the least interference between the clamps and your hands. If you remove both tubes (conical screen filter to vacuum pump control and oil mist filter to pump) at the same time, start with the outside clamp on the conical screen filter assembly then remove the clamp on the oil mist filter. Reassembly is

just the opposite. This actually allows you to attach the last clamp over the pump assembly from an unobstructed position through the opening in the sterilizer housing.

- When removing an old sterile air HEPA filter and installing a new one, use both hands. Steady the vent valve assembly with one hand while removing and installing the filter capsule with the other hand.

- Prior to disassembling any portion of the hydrogen peroxide monitor and detector assembly, make sure the surrounding area is clean and free of any air born dirt or dust. A can of compressed air works well. Clean lint free gloves are advised when handling the optical windows.

- Be careful when replacing the delivery valve. Always wear rubber gloves and inspect the area just below the delivery valve for leaks. The 59% hydrogen peroxide solution is toxic and it will burn your skin. You will notice an immediate oxidation reaction and your skin will turn white.

- When replacing the vacuum pump oil in the compressor, you will notice that RPI supplies a yorker cap with the bottle to make refilling a little easier.

These are just a few tips from us here at RPI, and if you would like more information about this unit, please give our tech support team a call at (800) 221-9723 option 5 or extension 135. Also if there is anything you would like to share with us about these units, you can always email us at [techsupport@rpi-parts.com](mailto:techsupport@rpi-parts.com). For a complete list of all of the RPI parts to fit the Sterrad NX and 100S, please see the center pages of this newsletter or visit the RPI website at [www.rpiparts.com](http://www.rpiparts.com).

# WHAT'S NEW

The following new parts are now in stock,



## DENTAL EQUIPMENT

### More Parts to fit Dental Vacuum Units

**DRAIN ASSEMBLY**  
RPI Part #VPA121  
OEM Part #54660

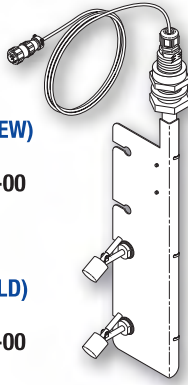

VPA125

**FLOAT ASSEMBLY (NEW)**  
RPI Part #VPA125  
OEM Part #002-1448-00  
• 2 Floats

**FLOAT ASSEMBLY (OLD)**  
RPI Part #VPA126  
OEM Part #015-2067-00  
• 3 Floats

**FILTER ELEMENT**  
RPI Part #VPE111  
OEM Part #004691SP

**FILTER ELEMENT**  
RPI Part #VPE112  
OEM Part #004876SP

**FILTER ELEMENT**  
RPI Part #VPE114  
OEM Part #003550SP

**FILTER ELEMENT**  
RPI Part #VPE115  
OEM Part #003548SP

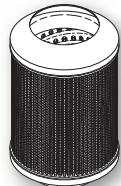

VPE115

**OIL FILTER ELEMENT**  
RPI Part #VPE116  
OEM Part #310705

**FILTER ELEMENT**  
RPI Part #VPE118  
OEM Part #003549SP

**GASKET (SEPARATOR LID)**  
RPI Part #VPG106  
OEM Part #053-1616-00

**GASKET (SEPARATOR LID)**  
RPI Part #VPG107  
OEM Part #053-2159-00

**FLANGE GASKET**  
RPI Part #VPG108  
OEM Part #65950000

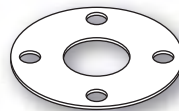

VPG108

**CAS COVER GASKET**  
RPI Part #VPG109  
OEM Part #54619

**FILTER KIT**  
RPI Part #VPK110  
OEM Part #005301SP

**FILTER KIT**  
RPI Part #VPK113  
OEM Part #003740

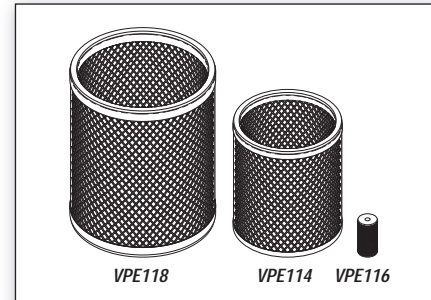

VPK117

**FILTER KIT**  
RPI Part #VPK117  
OEM Part #003750

**FLOAT SWITCH (FAIL-SAFE)**  
RPI Part #VPS129  
OEM Part #62950600

**FLOAT SWITCH (DIFFERENTIAL)**  
RPI Part #VPS130  
OEM Part #62950500

**VACUUM RELIEF VALVE**  
RPI Part #VPV124  
OEM Part #029-3811-00

**VACUUM RELIEF VALVE (PLATFORM)**  
RPI Part #VPV141  
OEM Part #77002144



## TABLE TOP STERILIZERS

### Parts to fit Midmark® • Ritter® UltraClave® M9 & M11 Sterilizers

**DOOR MOTOR ASSEMBLY**  
RPI Part #MIA180  
OEM Part #002-0790-00  
Models: M9-020 thru -022  
& M11-020 thru -022

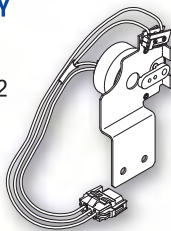

MIA180

**MAIN HARNESS**  
RPI Part #MIH238  
OEM Part #015-1554-00 (Main Harness)/  
015-1640-00 (Hi Limit Jumper)  
Models: M9-020 thru -022 (Serial # prefixes  
RN, RP, RR & V), M9D-020 thru -022 (Serial #  
prefixes RW, RX & V), M11-020 thru -022  
(Serial # prefixes RS, RT, RV & V) & M11D-020  
thru -022 (Serial # prefixes RY, RZ & V)

**PRINTER CARTRIDGE**  
RPI Part #MIC226  
OEM Part #053-0505-00  
Models: M9-001 thru -019, M9-020 thru -022,  
M11-001 thru -019 & M11-020 thru -022

**STEAM BLOCK KIT**  
RPI Part #MIK236  
OEM Part #002-1244-01  
Models: M9-020 thru -022 &  
M9D-020 thru -022

**STEAM BLOCK KIT**  
RPI Part #MIK237  
OEM Part #002-1244-02  
Models: M11-020 thru -022 &  
M11D-020 thru -022

**LABEL (PRESSURE RELIEF VALVE WARNING)**  
RPI Part #MIL260  
OEM Part #061-0309-00/061-0309-01  
Models: M9-001 thru -019 & M11-001 thru -019

**LABEL (DOOR WARNING)**  
RPI Part #MIL261  
OEM Part #061-0381-00/061-0532-00  
Models: M9-001 thru -019 & M11-001 thru -019

**SNAP CLIP**  
RPI Part #RPC957  
OEM Part #042-0182-00  
Models: M9-020 thru -022, M9D-020 thru -022,  
M11-020 thru -022 & M11D-020 thru -022

# FROM RPI

ready to ship the day your order is received!



## SCOPE PROCESSING SYSTEMS

### New Line of Parts to fit Sterrad NX & 100S Sterilization Systems

#### PM-2 KIT

RPI Part #SDK003  
OEM Part #100798-02

Model: NX

Includes:

- (1) UV Lamp Assembly (RPI Part #SDA006),
- (5) Thermistor Assembly (RPI Part #SDA007),
- (1) Air Filter (Base) (RPI Part #SDF001),
- (1) Oil Mist Filter (Red) (RPI Part #SDF002),
- (1) Conical Screen Filter (RPI Part #SDF017),
- (1 pc) Air Filter (RPI Part #SDF025),
- (1 pkg of 2) Handle (Shelf Extension) (RPI Part #SDH011),
- (1) Feedthru Screw Washer Kit (RPI Part SDK012),
- (1) Optical Window Kit (RPI Part #SDK014),
- (1 pkg of 2) Upper Shelf Support (RPI Part #SDS008),
- (1 pkg of 2) Lower Shelf Support (RPI Part #SDS009),
- (1 pkg of 6) Spacer (Electrode) (RPI Part #SDS013),
- (1 pkg of 2) Sleeve Gasket (RPI Part #SDS015),
- (1) Door Seal (RPI Part #SDS018),
- (1) Delivery Valve (RPI Part #SDV010),
- (1) Sterile Air (HEPA) Filter (RPI Part #SSF011),
- (2) Vacuum Pump Oil (RPI Part #RPL926),
- (1 pc) Absorbent Pad (RPI Part #RPP958),
- (18" lg.) Tubing (Clear 3/8" ID PVC) (RPI Part #RPT646),
- (1) Bottle (1 liter/32 fl. oz.) (RPI Part #RPB939),
- (1) Thermal Grease (ThermalCote™) (RPI Part #RPG938)

#### PM-1 KIT

RPI Part #SDK020  
OEM Part #05-06899-1-100

Model: 100S

Includes:

- (1) Oil Mist Filter (Red) (RPI Part #SDF002),
- (1) Vacuum Pump Oil (RPI Part #RPL926),
- (1) Bottle (1 Liter / 32 fl. oz.) (RPI Part #RPB939),
- (1 pc) Absorbent Pad (RPI Part #RPP958)
- (18" lg.) Drain Tubing (Clear 3/8" ID PVC) (RPI Part #RPT646)

#### PM-2 KIT

RPI Part #SDK021  
OEM Part #05-06899-2-200

Model: 100S

Includes :

- (1) Sterile Air (HEPA) Filter (RPI Part #SSF011),
- (1) Door Seal (RPI Part #SDS018),
- (1) Oil Mist Filter (RPI Part #SDF022),
- (1 pkg of 18) Spacer (Electrode) (RPI Part #SDS023),
- (1 pkg of 2) Shelf Stop Kit (RPI Part #SDK024)

#### UV LAMP ASSEMBLY

RPI Part #SDA006  
OEM Part #40-52125-001  
Model: NX

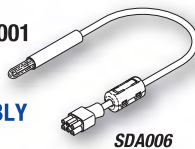

#### THERMISTOR ASSEMBLY

RPI Part #SDA007  
OEM Part #40-52136-001  
Model: NX

#### AIR FILTER (BASE)

RPI Part #SDF001  
OEM Part #25-52153-001  
Model: NX

#### OIL MIST FILTER (RED)

RPI Part #SDF002  
OEM Part #25-08560-001  
Models: NX & 100S

#### CONICAL SCREEN FILTER

RPI Part #SDF017  
OEM Part #100147-01  
Model: NX

#### OIL MIST FILTER

RPI Part #SDF022  
OEM Part #25-04351-001  
Model: 100S

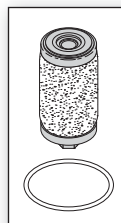

#### AIR FILTER

RPI Part #SDF025  
OEM Part #25-50703-001  
Model: NX

#### HANDLE (SHELF EXTENSION)

RPI Part #SDH011  
OEM Part #33-05440-0-002  
Model: NX

#### FEEDTHRU SCREW WASHER KIT

RPI Part #SDK012  
OEM Part #109522-01  
Model: NX

#### OPTICAL WINDOW KIT

RPI Part #SDK014  
OEM Part #32-51413-0-001/22-00537-209  
Model: NX

#### SHELF STOP KIT

RPI Part #SDK024  
OEM Part #33-02069-0-001  
Model: 100S



#### UPPER SHELF SUPPORT

RPI Part #SDS008  
OEM Part #33-53558-0-001  
Model: NX

#### LOWER SHELF SUPPORT

RPI Part #SDS009  
OEM Part #33-51152-0-001  
Model: NX

#### SPACER (ELECTRODE)

RPI Part #SDS013  
OEM Part #33-51158-0-001  
Model: NX

#### SLEEVE GASKET

RPI Part #SDS015  
OEM Part # (No OEM Part # Available)  
Model: NX

#### DOOR SEAL

RPI Part #SDS018  
OEM Part #22-00537-385  
Models: NX & 100S

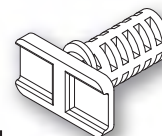

#### ELECTRODE SPACER

RPI Part #SDS023  
OEM Part #33-00888-0-001  
Model: 100S

SDS023

#### DELIVERY VALVE

RPI Part #SDV010  
OEM Part #28-53786-001  
Model: NX

#### STERILE AIR FILTER

RPI Part #SSF011  
OEM Part #25-51198-001  
Model: NX

#### BOTTLE (1 Liter/32 fl. oz.)

RPI Part #RPB939  
OEM Part # (No OEM Part # Available)  
Models: NX & 100S

#### THERMAL GREASE (THERMALCOTE™)

RPI Part #RPG938  
OEM Part # (No OEM Part # Available)  
Models: NX & 100S

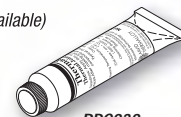

RPG938

#### VACUUM PUMP OIL

RPI Part #RPL926  
OEM Part #37-00579-003  
Model: NX

#### ABSORBANT PAD

RPI Part #RPP958  
OEM Part # (No OEM Part # Available)  
Models: NX & 100S

#### TUBING (CLEAR 3/8" - ID PVC)

RPI Part #RPT646  
OEM Part # (No OEM Part # Available)  
Models: NX & 100S



Sherry Lapides  
Vice President, Customer Relations  
Replacement Parts Industries, Inc.

8 to 4  
NO MORE

Over the course of the almost 45 years that RPI has been in business, I have met a few of our many customers on their home turf. Some of these meetings have been memorable, to say the least.

One customer who comes to mind had a service company on Long Island. Al and I arranged to meet him and his wife for drinks and dinner in New York City. This was probably in the early 1990's. We went to the lounge at the top of the World Trade Center, had drinks, watched the sunset, admired the view and then decided to go back down to go for dinner. And then the unthinkable happened. The elevator lurched to a stop and a disembodied voice came through the speaker: "Don't worry, folks. We'll have this little problem fixed in a moment." Picture it – we're stuck in a crowded elevator filled with people who have had too much to drink, around 90 floors up, and someone is telling us not to worry. And my husband doesn't like elevators or heights. Luckily the lights stayed on, and after about 15 minutes we were back on the ground floor, much relieved.

One of the most unforgettable people we met is a man named Ivan Frank. Ivan had a service company in the Denver area, specializing in the repair of centrifuges. But he also repaired lots of other types of medical equipment as well as cars and airplanes.

For years Ivan would take a bag of pitted olives and a centrifuge to local schools and show the students how to make olive oil and how, in the olden days, Jews used olive oil to light their Chanukah menorahs. We saw Ivan at several industry meetings, including MERA, and we became good friends. Ivan called me on the phone recently. He is not in good health now, but we had a great time reminiscing about "the good old days" and how he had been a consultant for RPI. Ivan is a wonderful person, and an industry icon.

Another good memory is of a customer we met in Maryland years ago. He had a great vehicle for moving large pieces of equipment and setting up a mobile parts and service shop. He used a horse trailer! It was low to the ground, had a ramp, wasn't too big, and fit in his back yard. It even had windows.

Many of RPI's customers are into the second or even the third generation now, as is RPI. I don't travel to meetings now. I know Ira and his staff look forward to meeting as many of you as possible and sharing more good memories. Thank you all for making this possible. Happy holidays! And may the new year bring you the best of all happiness and good health.



## TECH TALK

By Mark Micucci  
RPI Product Development

### How to Check a Start Capacitor To See If It's Dead or Not

If your motor makes a humming noise, but will not start, you need to check the Start Capacitor. The following test will tell you if the capacitor is completely dead or not.

Here's what to do to check the Start Capacitor, but first, be sure to read the **Warning** below.

**Warning. Do not touch the terminals of any capacitor with your bare hands or any un-insulated tool as this will likely cause the capacitor to discharge through you which may cause electrical shock, burns or even death!**

**Step 1:** Before testing the Start Capacitor, remove it from the system by carefully disconnecting the electrical leads one at a time. **Adhere to the Warning.**

**Step 2:** Once it is removed from the system, you now need to safely discharge the capacitor by using an insulated screwdriver to bridge the two terminals to create a short which will discharge the electricity that is stored inside the capacitor. **Important:** When discharging the capacitor, a spark will appear or you will hear a loud bang. Both of these conditions are normal. (Keep in mind that another safe way to discharge any capacitor is to place a 1K ohm 5 watt resistor across the terminal leads.) **Adhere to the Warning.**

**Step 3:** Set your Digital or Analog meter to at least 1K ohms. Touch the two terminals on the capacitor with each of the test leads.

- If you have a Digital Meter, you should notice that the meter will display some numbers for a few seconds and then it will return to OL (Open Line). It should do this every time you reverse the electrical leads.
- If you have an Analog Meter, your needle will swing to 0 ohms and then swing back to infinity every time you reverse the electrical leads.

If you notice this change in the electrical readings, then the Start Capacitor is not dead, but it still may be the problem, so further trouble-shooting is necessary.

If there is no change in the electrical readings, then the Start Capacitor is dead and must be replaced.

Keep in mind that this test will not tell you if your Start Capacitor is in poor, weak or marginal condition. In fact, if you have a poor, weak or marginal Start Capacitor, the only way to read the capacitance or micro-Farad's is to use a meter that reads direct capacitance.

# Introducing The Door Motor Assembly to fit Midmark® M9/M11 (And Service Tips Too!)

By Neil Blagman,  
RPI Product Development

Used to automatically unlatch the door at the end of the sterilization cycle, RPI is pleased to introduce the Door Motor Assembly (RPI Part #MIA180) to fit the Midmark® M9-020 thru -022 and the M11-020 thru -022.

The drive is a bidirectional 120VAC synchronous motor with a permanently attached actuator lever over-molded onto the main drive shaft. Sold as a complete module including wiring and mounting bracket for easy replacement, the RPI Door Motor Assembly needs no adjustment or calibration once mounted to the chamber bracket.

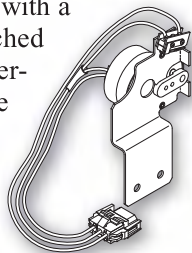

Door Motor  
Assembly  
RPI Part #MIA180

**SERVICE TIP #1:** When installing the Door Motor Assembly, make sure that the bent drive rod is inserted into the correct marked hole of the actuator arm based on the size of the chamber (9 or 11). **Do not attempt to move the actuator arm by hand – the actuator arm will automatically reset to the home position as soon as 120VAC power is applied.**

**SERVICE TIP #2:** When replacing the Door Motor Assembly, check the integrity and function of the door lever and tighten, lubricate, or if badly worn, replace the Door Lever Pivot Bushing (RPI Part #MIK201).

If you have any questions about the Door Motor Assembly or the door latching system in the Midmark M9/M11, feel free to contact RPI's Technical Support staff either through email at techsupport@rpiparts.com or on the phone at 800-221-9723 Ext. 135 and we will be happy to help.

## Parts to fit Vernitron Autoclaves Stock up Now Before They are Gone!

The following Vernitron autoclave parts will no longer be available by the end of the year. We still have a few of these parts in stock, but they are selling quickly. Stock up now before they are gone.

RPI Part #	OEM Part #	Description
<b>VRF001</b>	100115	Rubber Foot
<b>VFR002</b>	103171	Suction Cup Foot
<b>VRG003</b>	201708	Door Gasket
<b>VRG004</b>	205181	Door Gasket
<b>VRG005</b>	103085	Door Gasket

**Don't worry, we will continue to offer the following parts to fit Vernitron autoclaves:**

RPI Part #	OEM Part #	Description
<b>AMH018</b>	P040894-091 & 300016	Heating Element Assembly
<b>AMS035</b>	P045325-091	Rocker Switch
<b>NAV008</b>	34269116 & 3114-097	Safety Valve (35 PSI)
<b>PCB134</b>	017985 & 117327	Electrical Terminal Bushing
<b>PCC004</b>	9390401, 004288, 33071, 6001C & H98159	Power Cord Without Connectors (13A @ 125VAC, 8 ft.)
<b>PCN136</b>	004076	Speednut

Please make a note in sterilizer section of your catalog (Section 10, pages 1800-1801).

## New Dental Compressor PM Kits

RPI is proud to announce that two new Compressor PM Kits have been added to the impressive line of other Compressor PM Kits. For a complete list of all the Compressor PM kits that RPI carries, please visit the RPI website at [www.rpiparts.com](http://www.rpiparts.com).

For Midmark, RPI offers the CMK198 to fit the current production version with three motors of the P32 Oil-less Dental Air Compressors. This Kit includes: (3) Replacement Filter Elements (RPI Part CME004), Coalescing Filter Element (RPI Part #CMK025), PM Sticker and PM Checklist.

Please note that RPI also has available the PM Kit for the earlier, two motor version of the P32. It's RPI Part #CMK155 and it includes: (2) Replacement Filter Elements (RPI Part #CME004), Coalescing Filter Element (RPI Part #CMK025), PM Sticker and PM Checklist.

Air Techniques has recently released the AirStar 40 & AirStar 40 NEO and RPI has the PM Kit to fit these models. Ask for RPI Part #CMK199. It includes (3) Air Filter Element Kit (RPI Part #CMK065), the Filter Elements (RPI Part #CME102 and RPI Part #CME103), PM Sticker and PM Checklist

PM Kit RPI Part #CMK198 fits the current production version of the Midmark P32 Oil-less Dental Air Compressors with three motors.

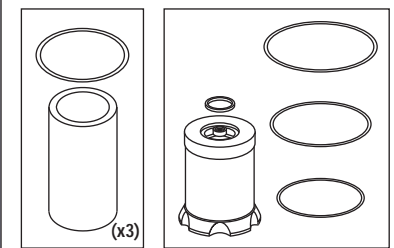

PM Kit RPI Part #CMK199 fits the recently released Air Techniques AirStar 40 and AirStar 40 NEO.

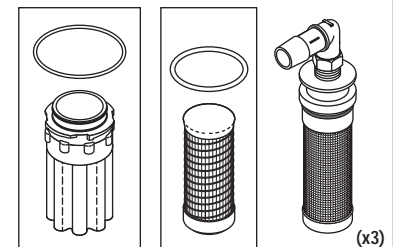



**replacement parts industries, inc.**

"The Alternate Source®"

P.O. Box 5019, Chatsworth, CA 91313-5019

PRSRST STD  
US Postage  
PAID  
Van Nuys, CA  
Permit #2399

*Especially for . . .*

## A BIG RPI Welcome To ...

Sherman, Angel, Jocelyn, and Livan, our newest members of the Shipping and Warehouse Department. Sergio is new with our Configuration Management Team. Corina is part of the Marketing Team. Our newest Customer Service Representative is Andi. And, our new Purchasing Assistant is Elizabeth. Welcome!

### RPI Offers Parts to fit Sterrad NX & 100S

*(Continued from page 1)*

this part and look forward to offering it to our customers soon.)

RPI also offers two Planned Maintenance Kits for the 100S. The PM-1 Kit (RPI Part #SDK020) is tailored for the vacuum area and oil PM; and, the PM-2 Kit (RPI Part #SDK021) concentrates on an overall PM of the unit. (The PM-2 Kit does not include the catalytic converter, but we are doing our research on it.)

And, as always, all parts included in our PM Kits are also sold separately.

For more information about these PM Kits, please see the center pages of this newsletter or visit the RPI website at [www.rpiparts.com](http://www.rpiparts.com).

### RPI Continues Support For Midmark 411 (75L) Tables

*(Continued from page 1)*

Here's what we have launched so far. First, RPI offers the Foot, Back, Tilt, and Base Actuators as well as the capacitors for all versions of the 411.

Second, the Hand Control (RPI Part #MIC168) that fits the Midmark 411-001 thru -008 tables is available. It includes the Bottom End Cap, Coil Cord, Hand Control Panel, Hand Control PC Board, Top End Cap (Clip On), Top End Cap (Velcro), and a pressure sensitive adhesive Velcro strip. The best part is that it includes options for both clip on and Velcro mounting. It's the RPI Advantage!

And, to fit the Midmark 411-009 thru -010 and the Midmark 411 (75L)-011 thru -018, we have the Coiled Cord (RPI Part #MIC251) an 8 conductor cable with RJ45 style shielded connectors at both ends, and it is 25 feet long when fully extended.

Also available are the Motor Coupler (RPI Part #MIC166), and the Brake and Coupler Kit (RPI Part #MIK167) that includes the Mounting Cup along with the Brake and Coupler to fit the table actuators.

We are in the process of developing more parts to fit this popular exam

table. Visit our website, [www.rpiparts.com](http://www.rpiparts.com), and watch for our "yellow" new parts flyers in the mail.

RPI is committed to meeting our customers' needs for service parts to fit the various discontinued Midmark models of exam chairs and tables. You can count on RPI!

### More New Parts to Fit Dental Vacuum Units

*(Continued from page 1)*

What's more, Float Assemblies, for both the new and the older style separator tanks, are available to fit the Midmark PowerMax and PowerMax G units. The Float Switch (Fail-Safe) and Float Switch (Differential) are in stock to fit the DentalEZ® 4000/8000 DryMax units.

In response to our customers' requests, RPI responds with the Vacuum Relief Valve to fit the Midmark PowerMax and PowerMax G systems along with the Vacuum Relief Valve (Platform) to fit the Midmark and Matrx Wet Ring Vacuums.

For a complete list of the new parts RPI has released to fit the Dental Vacuum Systems, please see the center pages of this newsletter or visit the RPI website at [www.rpiparts.com](http://www.rpiparts.com).

All rights reserved. No part of this newsletter may be reproduced or utilized in any form or by any other means without permission in writing from the Publisher. Inquiries should be addressed to: RPI, Marketing Department, P.O. Box 5019, Chatsworth, California 91313-5019. Additional copies of The Alternate Source® may be obtained by contacting RPI. Please feel free to Call: (800) 221-9723, Fax: (818) 882-7028, or E-Mail: [moreinfo@rpiparts.com](mailto:moreinfo@rpiparts.com) your request. Parts mentioned in this newsletter are manufactured by Replacement Parts Industries, Inc. to fit the equipment noted. All product names used in this document are trademarks or registered trademarks of their respective holders. RPI © 2016.

**CALL (800) 221-9723 or (818) 882-8611 • FAX (818) 882-7028 • WEBSITE [www.rpiparts.com](http://www.rpiparts.com)  
E-MAIL [moreinfo@rpiparts.com](mailto:moreinfo@rpiparts.com) • E-MAIL [order@rpiparts.com](mailto:order@rpiparts.com) • E-MAIL [techhelp@rpiparts.com](mailto:techhelp@rpiparts.com)**