



RPI Expands Its Line of Hand Controls To Fit Midmark® Exam Chairs

By Neil Blagman, RPI Product Development

Following up on the successful introduction of both the programmable and non-programmable RPI Hand Controls (RPI Part #MIC248 and MIC262) to fit the Midmark 411 (75L) exam chairs, we have expanded our line of hand controls to cover more styles and additional models.

To our "teardrop" style hand control

line, we added the following: Hand Control (Basic) (RPI Part #MIC284), Hand Control (Programmable) (RPI Part #MIC286), Hand Control (Non-Programmable) (RPI Part #MIC288), and Hand Control (Programmable with Heater) (RPI Part #MIC290) to fit all models and versions of the Midmark 230, 630, 641, and several

Continued on the back page

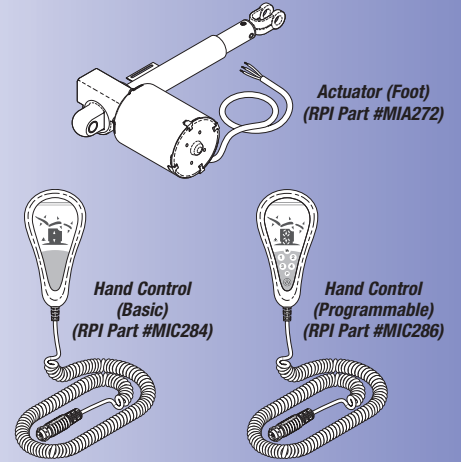

New Parts from RPI To Fit AirStar® Dental Compressors

By Mark Micucci, RPI Product Development

We have you covered for parts to fit the AirStar dental compressors.

There are three new Check Valve Upgrade Kits which allow you to upgrade your AirStar compressors from the older brass plumbed units to the new Poly tubing versions. These kits have everything needed to upgrade these machines, including the Check

Valve, Poly Tubing, Poly Connectors and Brass Fittings as needed to fit AirStar 10D, 21D, 50D, 70D, 22D, and 30D. Detailed installation instructions are included with each of the kits to aid you in installing your Check Valve Upgrade Kit. An RPI Advantage is that all parts are sold separately and all tubing is also sold separately by the

Continued on the back page

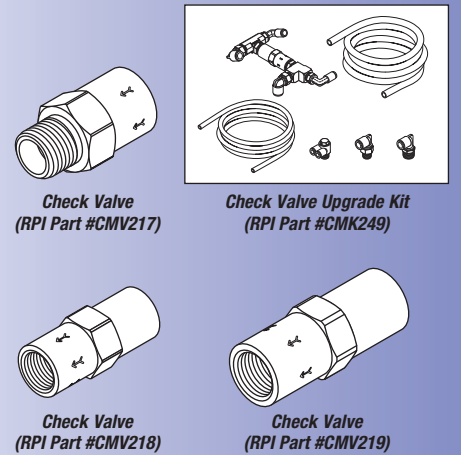

Rackin' 'Em Up – One Tray at A Time To Fit Tuttnauer Sterilizers

By Phil Goldstein, RPI Product Development

We are happy to announce the addition of Rack and Tray Kits to fit the following Tuttnauer sterilizer models: ValueKlave/1730, 2340, 2540, 3870, EZ9 and EZ10.

RPI racks and trays are durable. They are manufactured from 304 Stainless Steel, and then electro polished. The larger 3870 racks and trays are manu-

factured from 316L Stainless Steel sheet metal. Plus, as with all RPI kits, the racks and trays included in these kits are also sold separately. See the list on page 5.

Once you get these new racks and trays set up, you will not want to forget your weekly cleaning and inspec-

Continued on page 7

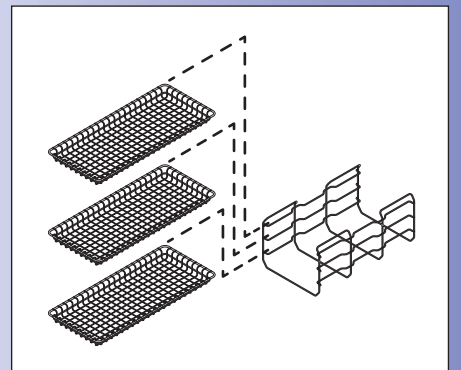

Holder and Tray Kit (RPI Part #TUK163)



*Ira Lapidès
CEO & President
Replacement Parts Industries, Inc.*

FROM THE DESK OF THE PRESIDENT

Is This A Great Industry, or What?!

Recently I was interviewed for an industry magazine, and the interviewer asked me about RPI and how it has changed over the years, along with the parts business and our customers.

This got me thinking about the healthcare technology management industry as a whole, and how lucky we are to have careers in this industry.

On both the medical and dental sides of the industry, it is exciting, dynamic, and challenging. And truly meaningful, as our contributions in maintaining healthcare equipment help professionals do their jobs in maintaining and improving the health of their patients.

I am sure that you, just as I, look around a hospital, physician's or dentist's office every time you go in as a patient or friend/family of a patient, and look at the healthcare equipment and think about how the equipment is maintained or the parts that are required to maintain that equipment.

It is also remarkable to reflect on the progress of healthcare technology over the years and how it has dramatically improved and how we as an industry need to continuously be

open to learning new things to be able to service equipment. The pace of change in some areas is quite rapid, in others not so much, but the influx of computer technology into healthcare equipment has provided a whole new challenge. That continuous change requires all of us to continue to learn and adapt, which means that our jobs are always interesting, as there is always something new around the corner and we need to keep on our toes to keep pace.

As we reflect on this industry and how fortunate we are to be a part of it, I implore you to encourage others to join the profession. Students coming out of high school and college for the most part have no clue that such a great career might exist for them in this field, let alone that the field exists in the first place.

Whatever you can do to promote the profession will be beneficial, whether it is participating in a career day at a local school, doing some self-promotion of your department or business in the local press, or simply talking to people looking for career advice or even a change in career, it will benefit the industry and you as well.

It will definitely be worth your time and help move our industry forward.

Hello! My name is Corina Curiel, and I was born and raised in the San Fernando Valley (located in sunny southern California). I am the eldest of two children.

I had always loved art, ever since I was little. I spent a sizable part of my childhood not only drawing, but also analyzing animation and how it worked. When you think about it, a whole lot of work is put into a cartoon!

I graduated from Cal State Northridge with a degree in Art. As a student, my biggest adventure was taking a leap and studying in Florence, Italy for a full year. I was a student under both Cal State and L'Accademia di Belle Arti. My days were spent painting next door to Michelangelo's David with a spectacular view of the famous Duomo. I was one of 14 art students from the program, and we all became very good friends, keeping in touch as often as we can! However, it was strange being so far from my family.

Family is important to me; I contact my aunts and uncles regularly, and look out for my younger cousins. I love celebrating holidays and other special occasions with them. My younger brother Carlos is basically my twin; we go on adventures together and try out new places to eat.



*Corina Curiel
Marketing Department*

I have been working with RPI's Marketing Department since 2016! It's a pleasure to work with Joan and Keith. Everyday there is always something new and different in my department, and I like learning new things. I also really enjoy bringing my creativity to the RPI website by designing banners, news icons and other artistic elements to help make our site interesting and helpful to you. I hope you're enjoying them!

REMINDER!

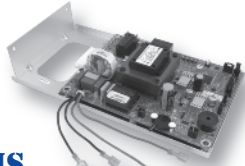

RPI IS OFFERING YOU \$100 FOR THIS PCB!

RPI is offering **\$100** for used, non-operational **RED** Control PC Boards with brackets that fit the newer style Midmark® M9 and M11 UltraClaves®.

We want to offer our customers a Core Exchange Program for these **RED** Control PCB's – similar to the program we now offer for the GREEN Control PCB's.

However, to be able to offer a Core Exchange Program for the RED PCB's, we must first build up stock – and this is where you come in!

Please send us your **RED** Control PC Boards with the bracket that fit the newer style UltraClave® Models #'s 020-022, OEM Part # 002-1992-00 (Serial Numbers V1697650 thru Present). These are the sterilizers with the green LCD display. (We will refer to this board as RPI Part #MIB132.)

Then upon receipt of your **RED** board, we will inspect it to determine if it is eligible for the \$100 reward. If it is, then you get the \$100 reward. It's just that simple!

Call us before you send in your **RED** board and we will send you a free shipping box with a pre-paid return-shipping label.

SERVICE TIP



Dedicating This Line for You!

Find out what other devices, if any, are sharing an incoming voltage line.

By Phil Goldstein, RPI Product Development

A dedicated line is a power line originating at the Circuit Breaker Panel and terminating at a specific load/machine. Nothing else is connected to this line; One Circuit feeding one Load.

Sharing this line/circuit could cause the incoming voltage to drop and the amperage to increase. When troubleshooting burnt out components like heating elements, solenoid devices, PC Boards, fuses and circuit breakers, it is a good idea to find out what other devices, if any, share the incoming voltage line.

Many dental and doctor offices use sterilizers, ultrasonic cleaners and scalers, compressors, film processors and other devices that draw a fair amount of current. Coffee makers, refrigerators and other equipment that we forget to check for when evaluating incoming line voltage also have an effect.

If the office personnel are running a sterilizer first thing in the morning and decide to clean instruments in their ultrasonic cleaner at the same time, the heating elements in the sterilizer are drawing 12-15 amps while the ultrasonic cleaner is drawing 3-4 amps and dropping the line voltage. On the other side of the wall the coffee maker was just turned on and adds more resistance to the line and the voltage drops even more and the current rises. Helping your customers to organize which line they plug their devices into can prevent future issues from arising.

Are you tripping GFCIs and chasing your tail for answers? Another reason to use a dedicated line is to ensure the ground is not shared between two or more devices/loads. Other devices/loads might transfer noise into the ground wire, causing the grounding connection voltage at the sterilizer to be different from the circuit breaker panel. This symptom is known as Inner-System Ground Noise (ISGN) and has the ability to create enough imbalance in current between the neutral and ground to trip a GFCI. And coincidentally, the GFCIs never seem to fail when a technician is in the office, always after they leave.

The point is to make note of all equipment/devices plugged into the “dedicated circuit” before troubleshooting the piece of equipment experiencing problems.

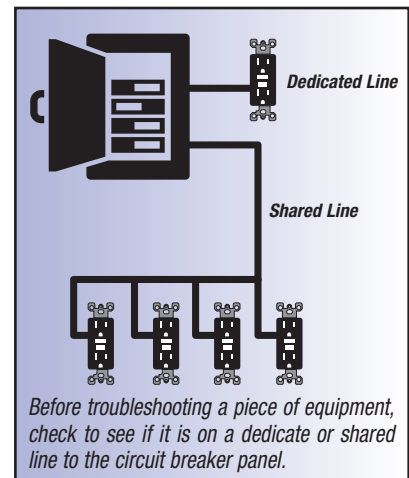

WHAT'S NEW



DENTAL EQUIPMENT New Parts to fit Air Techniques AirStar® Dental Compressors!

RPI PART #	OEM PART #	DESCRIPTION	FITS MODELS
CMA245	85411	Orifice Assembly (.007")	AirStar 10D, 21D, 22D & 30D
CMA246	85412	Orifice Assembly (.010")	AirStar 50D & 70D
CMA252	89185	Regeneration Orifice Assembly	AirStar 50D & 70D
CMA253	89183	Regeneration Orifice Assembly	AirStar 10D, 21D, 22D & 30D
CMC201	85833	Capacitor (65uF, 370VAC)	AirStar 10D, 21D, 10M & 21M
CMC202	85832	Capacitor (55uF, 370VAC)	AirStar 22D, 40D, 50D, 70D, 22M, 50M & 70M
CMC203	85831	Capacitor (27.5uF, 370VAC)	AirStar 30D & 30M
CMC243	80175	Capacitor (460-552uF, 125VAC)	AirStar 2-1
CMK247	86441	Check Valve Upgrade Kit	AirStar 10D
CMK248	86443	Check Valve Upgrade Kit	AirStar 21D, 22D, 30D & 50D
CMK249	86447	Check Valve Upgrade Kit	AirStar 70D
CMP204	(No OEM Part # Available)	Thermal Protector Assembly	AirStar 10M & 10D
CMP206	(No OEM Part # Available)	Thermal Protector Assembly	AirStar 12M, 12D, 21M, 21D, 30M, 30D & 40M
CMP207	(No OEM Part # Available)	Thermal Protector Assembly	AirStar 22M, 22D, 40M, 50M, 50D, 70M & 70D
CMP244	85273	Thermal Protector Assembly	AirStar 1, 2-1, 2-2, 3, 5 & 7
CMR200	85773 & 89345	Relay (Electrical Contactor)	AirStar 10, 21, 22, 30, 40, 50 & 70
CMS056	85465	Pressure Switch	AirStar 1, 2-1, 2-2, 3, 5, 7, 10D, 21D, 22D, 30D, 50D & 70D
CMS208	86436 & 87176	Pressure Switch	AirStar 10M, 12M, 21M, 22M, 30M, 40M, 50M, 70M and 100M
CMS209	86063 & 86065	Power Switch/Circuit Breaker (10A)	AirStar 10M, 10D (May 2006 to Current), 30M (May 2006 to Current) & 30D (May 2004 to Current)
CMS210	86148	Power Switch/Circuit Breaker (8A)	AirStar 12M, 22M & 22D
CMS212	86064	Power Switch/Circuit Breaker (15A)	AirStar 40M, 50M & 50D (May 2006 to Current)
CMS213	86066	Power Switch/Circuit Breaker (22A)	AirStar 70M (May 2006 to Current) & 70D (May 2006 to Current)
CMS214	85367	Power Switch/Circuit Breaker (8A)	AirStar 70M (1996 to April 2006) & 70D (1996 to April 2006)
CMS215	85363	Power Switch/Circuit Breaker (5A)	AirStar 30D (1996 to April 2004)
CMT221	86726	Tubing (10mm OD Black)	AirStar 10M, 12M, 21M, 22M, 30M, 40M, 50M, 70M, 100M, 10 NEO, 21 NEO, 22 NEO, 30 NEO, 40 NEO, 50 NEO & 70 NEO
CMT222	86727	Tubing (12mm OD Black)	AirStar 10M, 12M, 21M, 22M, 30M, 40M, 50M, 70M, 100M, 10 NEO, 21 NEO, 22 NEO, 30 NEO, 40 NEO, 50 NEO & 70 NEO
CMV217	004761SP & 87045	Check Valve	AirStar 10M, 12M, 21M, 22M, 30M, 40M, 50M, 70M & 100M
CMV218	85659	Check Valve	AirStar 10D, 21D, 22D, 30D, 50D & 70D
CMV219	86692	Check Valve	AirStar 70D
CMV250	85839	Solenoid Valve (Regeneration System)	AirStar 50D and 70D
CMV251	85834	Solenoid Valve (Regeneration System)	AirStar 10D, 21D, 22D & 30D
RPF690	(No OEM Part # Available)	Tee Fitting	AirStar 10D, 21D, 22D, 30D, & 50D
RPF860	(No OEM Part # Available)	Male Branch Tee	AirStar 70D
RPF914	(No OEM Part # Available)	Adaptor (1/16" Barb x 1/8" MPT)	AirStar 10D, 21D, 22D, 30D, 50D & 70D
RXC023	(No OEM Part # Available)	Sleeve Clamp (1/8")	AirStar 10D, 21D, 22D, 30D, 50D & 70D
RXF024	56133 & 003863SP	Elbow (3/8" Push-In x 3/8" MPT)	AirStar 70D & 70M
RXF025	56192	Branch Elbow (Dual 1/4" Push-In x 1/4" MPT)	AirStar 10D, 21D, 22D, 30D, 50D & 70D
RXF029	(No OEM Part # Available)	Elbow Fitting (1/4" Push-In x 1/4" MPT)	AirStar 10D, 21D, 22D, 30D, 50D & 70D
RXF030	(No OEM Part # Available)	Street Tee (1/4" NPT)	AirStar 10D, 21D, 22D, 30D, 50D & 70D
RXF031	(No OEM Part # Available)	Male Connector (1/4" Push-In x 1/4" MPT)	AirStar 21D, 22D, 30D, 50D & 70D
RXF033	56119	Elbow Fitting (3/8" Push-In x 1/4" MPT)	AirStar 10D, 21D, 22D, 30D, 50D & 70D
RXF037	56113	Swivel Elbow (1/4" Push-In x 1/8" MPT)	AirStar 10D, 21D, 22D, 30D, 50D & 70D
RXT017	(No OEM Part # Available)	Tubing (6.5mm ID x 10mm OD Black)	AirStar 10M, 12M, 21M, 22M, 30M, 40M, 50M, 70M, 100M, 10 NEO, 21 NEO, 22 NEO, 30 NEO, 40 NEO, 50 NEO & 70 NEO
RXT018	(No OEM Part # Available)	Tubing (8mm ID x 12mm OD Black)	AirStar 10M, 12M, 21M, 22M, 30M, 40M, 50M, 70M, 100M, 10 NEO, 21 NEO, 22 NEO, 30 NEO, 40 NEO, 50 NEO & 70 NEO
RXT019	89955	Tubing (.275" ID x 3/8" OD Natural)	AirStar 10D, 21D, 22D, 30D, 50D & 70D

DON'T FORGET!

RPI Also Carries These Parts to fit Air Techniques AirStar® Dental Compressors!

Barb Tee - 10/pkg	RPI Part #ADB013 (No OEM Part # Available)	Fits AirStar 10D-70D
Relay (Electrical Contactor)	RPI Part #VPR151 (OEM Part #54498)	Fits AirStar 100M
Transformer	RPI Part #VPT142 (OEM Part #85934, 86637, 85275 & 85362)	Fits AirStar 10D-70D & 10M-100M

FROM RPI



TABLE TOP STERILIZERS

New Trays and Racks to fit Tuttnauer Manual and Automatic Sterilizers!

RPI PART #	OEM PART #	DESCRIPTION	FITS MODELS
TUH164	TRH173-0005, (replaces CU510010)	Tray Holder	Valueklave (1730MKV) & 1730E/EK/M/MK
TUH167	TRH254-0012, (replaces CT510010)	Tray Holder	EZ9, EZ9k & 2340E/EA/EK/EKA/M/MK
TUH170	TRH254-0036, (replaces CV510010)	Tray Holder	EZ10, EZ10k & 2540E/EK/EKA/M/MK
TUH172	CC510010	Tray Holder	3870E/EA/EK/EKA/M/MK
TUK163	TRH173-0005 (Tray Holder) & TRY173-0008 Tray (Wire)	Holder and Tray Kit	Valueklave (1730MKV) & 1730E/EK/M/MK
TUK166	TRH254-0003 (Tray Holder) & TRY234-0012 Tray (Wire)	Holder and Tray Kit	EZ9, EZ9k & 2340E/EA/EK/EKA/M/MK
TUK169	TRH254-0036 (Tray Holder) & TRY234-0003 Tray (Wire)	Holder and Tray Kit	EZ10, EZ10k & 2540E/EK/EKA/M/MK
TUK171	CC510010 (Tray Holder), CC520010 Tray (Large), CC520020 Tray (Small)	Holder and Tray Kit	3870E/EA/EK/EKA/M/MK
TUT165	TRY173-0008, (replaces CU520010)	Tray (Wire)	Valueklave (1730MKV) & 1730E/EK/M/MK
TUT168	TRY254-0003, (replaces CT520010)	Tray (Wire)	EZ9, EZ9k, EZ10, EZ10k, 2340E/EA/EK/EKA/M/MK & 2540E/EK/EKA/M/MK
TUT173	CC520020	Tray (Small)	3870E/EA/EK/EKA/M/MK
TUT174	CC520010	Tray (Large)	3870E/EA/EK/EKA/M/MK



TABLES & CHAIRS (EXAM/SURGICAL)

New Parts to fit Midmark® • Ritter® Exam Tables and Chairs!

RPI PART #	OEM PART #	DESCRIPTION	FITS MODELS - See RPI website for Serial #'s these parts fit
MIA272	002-0564-08	Actuator (Foot)	419
MIA278	015-0995-00	Control Panel Assembly	75L (411), 411, 411 (75L) & Evolution 75
MIA302	015-1758-00	Switch Assembly (Upholstery Heater)	604, 622 & 623
MIA303	015-1759-00	Switch Assembly (Drawer Heater)	204, 222, 223, 604, 622 & 623
MIB306	002-0347-06	Hand Control PC Board	405
MIB309	015-1173-00	Control Inlet PCB	75L (411), 411, 411 (75L) & Evolution 75
MIC256	015-1675-00	Coiled Cord	230, 630, 641, 646, 647 & Evolution 75
MIC273	002-0048-00	Foot Control Cord	105, 106, 107, 111, 112, 113, 114, 116, 117, 119, 305, 306, 307, 311, 317, 318, 319 & Evolution 75
MIC277	002-0499-00	Hand Control (Non-Programmable)	75L (411), 411, 411 (75L) & Evolution 75
MIC280	002-0578-00	Hand Control (Programmable)	75L (411), 411 (75L) & Evolution 75
MIC282	002-0911-00 & 002-0911-06	Hand Control	223 & 623
MIC284	002-0911-04	Hand Control (Basic)	230 & Evolution 75
MIC286	002-0911-02	Hand Control (Programmable)	630, 641 & Evolution 75
MIC288	002-0911-01	Hand Control (Non-Programmable)	630, 641 & Evolution 75
MIC290	002-0911-05	Hand Control (Programmable With Heater)	630
MIC292	015-1675-04	Coiled Cord	223 & 623
MIC293	015-1785-00	Coiled Cord (Foot Control)	223 & 623
MIC295	053-0848-00	Step Cover (Grey)	100, 104 & 304
MIC296	053-0048-00	Step Cover (Black)	100
MIC298	016-0356-00	Gas Cylinder	414
MIC299	016-1625-00	Locking Gas Cylinder	222 & 622
MIC300	016-1017-00	Locking Gas Cylinder	204 & 604
MIC304	029-0681-00 (Velcro Version) & 002-0409-00 (Clip On Version)	Hand Control	405
MIC307	002-0624-00	Hand Control	405
MIC310	002-1065-00	Gas Cylinder Set	230, 630, 641, 647 & Evolution 75
MIP281	015-1127-00	Hand Control Panel	75L (411), 411 (75L) & Evolution 75
MIP283	015-1684-00	Membrane Panel	223 & 623
MIP285	015-1866-00	Membrane Panel	230 & Evolution 75
MIP287	015-1678-00	Membrane Panel	630, 641 & evolution 75
MIP289	015-1677-00	Membrane Panel	630, 641 & Evolution 75
MIP291	015-1765-00	Membrane Panel	630
MIP305	015-0528-00	Hand Control Panel	405
MIP308	015-1243-00	Membrane Panel	405
RXB035	016-0131-21	Flange Bearing	230, 630 & Evolution 75
RXF036	015-0346-40	Fuse (6.3A, 250V) 5mm x 20mm Time Delay	230, 630, 641, 647 & Evolution 75



Sherry Lapides
Vice President, Customer Relations
Replacement Parts Industries, Inc.

8 to 4
NO MORE

"What Does This Have To Do With RPI?", You Might Ask?

Here's something you may not know about me – I am an avid baker. My mother was a wonderful baker and cook; and so was my mother-in-law. I especially like to bake cookies because it is easier to share them with grandchildren, children and friends.

Now, "What does this have to do with RPI?" you might ask. Good question. Some 45-46 years ago, shortly after we first started RPI, I was in need of a kitchen timer. With money being a little tight at the time, I "borrowed" a timer from RPI. It was an RT-2, which has morphed into the RPI Part #RCT048. I am still using that same timer, even though my oven comes with a built-in timer.

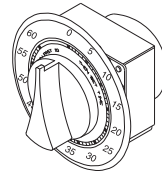

Time Switch (60 Min)
(RPI Part #RCT048)

It's not that I have saved money all these years by not having to replace this timer (I probably could have "borrowed" another timer from RPI if I had needed to) but this timer still works just fine and I don't need to replace it.

It is an example of the quality we have taken pride in putting into our parts from the very beginning. My RPI timer may not look as pretty as a new one from the kitchen store, but after around 45 years and a lot of batches of cookies, it still works for me.

When we first started RPI it was with three main principles in mind: Quality parts with customer satisfaction guaranteed; Fair pricing, and Excellent customer service.

We have tried our best to live up to those principles, and I hope you agree with me when I say that I think we have succeeded.

See You!
Soon!

RPI is always proud to be part of industry shows and conventions. The exchange of ideas, learning experiences, and getting to know each other face-to-face is what it's all about! We look forward to seeing you!

- MD Expo, April 10-13, Houston, TX (Don't miss our sterilizer service presentation!).
- AAMI Conference, June 7-10, Cleveland, OH.
- CABMET Symposium, August 8-10, Aurora, CO.
- CEAI Conference & Expo, August 14-15, Terrace, IL.
- MD Expo, October 17-19, Baltimore, MD.



When you read Sherry's article to the left, she tells us how the founders of our company built RPI on three main principals. Those principals still stand stronger than ever almost 50 years later here at RPI.

Today, RPI operates its business under a more "formalized" quality management system (QMS); and, we are proud to announce that our QMS was recently certified to the international ISO 9001:2015 standards. One might say that it's just a more contemporary name for Sherry's three original principals.

Our ISO 9001 certification demands that we are committed to continually improve our systems and processes in order to deliver a quality product or service and fully satisfy our customer's needs. The only way to earn this certification is to "pass" a rigorous audit of our QMS every three years, with surveillance audits in the intervening years. Each of these audits are conducted by an approved ISO organization, TUV SUD America, an international company, and globally recognized for its leadership in promoting ISO standards.

With our quality system, we focus on consistently providing excellent parts and customer service. However, if something does not meet our high standards, then we determine the root cause of the issue and apply corrective actions as needed. By doing this, we reduce waste, rework, and inefficiencies. What's more, we are proud to empower our employees to play an active role in our QMS.

Through all of this, we believe that we improve employee and customer satisfaction!

Rackin' 'Em Up – One Tray at A Time to fit Tuttnauer Sterilizers

(Continued from front page)

tion requirements: Clean and rinse out the water reservoir, inspect the door gasket, filters, jiggle the wire in the air jet valve, and use a packet of Tutt-Clean™ (RPI Part #TUC094), a cleansing compound formulated for descaling and removal of water deposits, oxides and other sediments to help maintain a clean chamber. It's intended for most Tuttnauer models.

Sci-Dry™ (2 oz.)
(RPI Part #SCA054)



Tutt-Clean™
(RPI Part #TUC094)

Also available to help keep it clean is the RPI Sterilizer Cleaning Kit (RPI Part #RPK791) that comes with everything you need including four different types of brushes perfect for cleaning the chamber, racks and trays, the groove where the door gasket installs, and even the outside casings. Scrub pads and cleaning wipes complete the kit for easy clean up. Don't forget to put a couple of bottles of the RPI sterilizer drying agent, Sci-Dry™ (RPI Part #SCA054), into the outer pockets of the Cleaning Kit to use on the racks and trays. This cleaner repels moisture and condensation, leaving the metal surfaces clean and bright!

RPI Tech Tools Created for the Maintenance & Service of Tuttnauer Sterilizers ...



Visit the RPI website, www.rpiparts.com, to check out the "RPI Technical Resource Center", then click "Tech Help Videos and More" to find a presentation centered on calibrating the AJUNC 3 Board, presented by RPI Product Engineer, Chris Jacobs. Also from the resource center, you can download the newly updated RPI Troubleshooting Guide and exploded views from the "Tech Support eLibrary".



SEE WHAT CHANGES HAVE BEEN MADE TO SOME PARTS... TO HELP MAKE YOUR JOB EASIER!

AIR VALVE DIAPHRAGM KIT (RPI Part #MTK019)

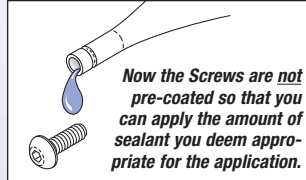

Now the Screws are not pre-coated so that you can apply the amount of sealant you deem appropriate for the application.

RPI has made a change to our Air Valve Diaphragm Kit (RPI Part #MTK019) that fits the Medivators models DSD Edge® and DSD-201® endoscopes. The kit used to come with screws that were pre-coated with Threadlocker; now the kit includes RPI Part #RXH049, socket head button screws that are not pre-coated, plus a small tube of Retaining Compound 609 (RPI Part #RXA048). This is to allow you to apply the amount of sealant you deem appropriate for the application. When applying the sealant, we recommend that you use it sparingly to avoid making it difficult to remove the screw at the next service interval.

MECHANICAL TIME SWITCH (RPI Part #CAT104)

We have recently replaced the mounting screws used to install our Mechanical Time Switch (RPI Part #CAT104) that fits the Clay Adams Compact II centrifuges. The original screws were 1/2" long and were interfering with the internal gears. The new screws are 3/8" long which allows enough clearance from the gear assembly.

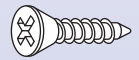

3/8"

Now the mounting screws are 3/8" long which allows enough clearance from the gear assembly.

THERMOCOUPLE REDUCER FITTING (RPI Part #SCF045)

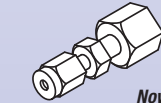

Now the Thermocouple Reducer Fitting is sold separately, as well as included in the Thermocouple Kit!

The RPI Thermocouple Reducer Fitting has always been included with the Thermocouple (RPI Part #SCT030) to fit the Statim 2000 and 5000 series cassette sterilizer. The reducer fitting mounts and seals the thermocouple to the probe baskets fitting for the cassette thermocouple. But now – you can get the RPI Thermocouple Reducer Fitting just by itself as RPI Part #SCF045. Now you don't have to purchase the complete thermocouple! Maybe even keep one of the reducer fittings on-hand, just in case one of the small compression sleeves get lost!

TIE BAR PIVOT PIN (RPI Part #PCP677)

The Tie Bar Pivot Pin is used to mount the mechanical and gas spring assemblies for the Pelton & Crane LFII and LFIII series dental lights. It's always been a little difficult aligning the Pivot Pin when installing these assemblies because neither the original OEM Pivot Pin (Part #3322604/015433) design nor RPI's Pivot Pin had a screw driver slot for easy alignment. However, in RPI's continuing effort to help make your service job easier – RPI redesigned our Pivot Pin to make it easy to install! You guessed it! RPI recently redesigned its Pivot Pin with a screw driver slot for easy alignment when installing both the mechanical and gas spring assemblies. Here's how it works: Simply insert the spring rod into the knuckle. Align the holes of the ties bars and the knuckle then insert the Tie Bar Pivot Pin with flat end first. Make sure that the flat side of the pin is properly aligned with the flat side of the tie bar – then use a screw driver to simply push the flat side of the pin into place - easy as 1-2-3!

Now the Tie Bar Pivot Pin has a screw driver slot at the end for easy alignment when installing both the mechanical and gas spring assemblies.



WELCOME!

... to the RPI Family.

Kia Ortiz, Josue Cuevas, Dave Wisniewski, and Alondra Lugo recently joined our Shipping and Warehouse team. And Linda Perez is the newest member of our Purchasing Team. Welcome to RPI's family.

RPI's Expanded Line of Hand Controls to Fit Midmark Exam Chairs

(Continued from front page)

different versions of the Evolution 75.

Also added to our line of "teardrop" style hand controls are the Hand Controls to fit the Midmark 223 and 623 exam tables, as well as one to fit the 405 exam table. See page 5 for details.

After getting a tremendous response from our customers for the "rectangular" style Hand Control (RPI Part #MIC168) that fits the Midmark 411 it was a clear indication to us to add more of this style hand control, so we did. In fact, we recently introduced the both the programmable and non-programmable hand controls to fit the newer versions of the Midmark 411 (75L) which are listed in detail on page 5. And rounding out our line of "rectangular" style hand controls, we now offer the Hand Control to fit the 405 exam table. In fact, on page 5, there's a listing of all the new hand controls.

Along with the introduction of nine new hand controls, RPI now offers individual membrane panels, control panels and PC Boards (as well as the end caps when used) for the hand controls listed above. In addition, RPI recently released the Control Inlet PCB to fit the Midmark 411 (75L), as well as three new coiled cords to fit Midmark 223, 230, 630, 641 and 647.

Plus we offer several coil cords specifically for the foot control to fit many of the Midmark exam tables.

All these parts and more can be found on page 5 of this newsletter, and of course on our website, www.rpi-parts.com.

Lots of More New Parts from RPI to fit AirStar Dental Compressors

(Continued from front page)

foot to allow you to stock your van with any extra parts needed to provide your customer prompt service.

Also new from RPI is a line of Capacitors to fit the AirStar units with 110VAC and 220VAC motors. Plus we offer a Capacitor to fit 30D and 30M. Don't forget that RPI also carries the Start Capacitor to fit the AirStar 2-1.

Our new line of Relays (Electrical Contractor) and Transformers fit all the AirStar D and M units, including one for the 100M. And, the new Pressure Switches fit earlier AirStar units *with and without* desiccant dryers, and units with the membrane dryers.

And for the motor terminal boxes, RPI's Thermal Protector Assemblies fit AirStar 10D, 10M, 12M, 12D, 21D, 21M, 22D, 22M, 30D, 30M, 40M, 50D, 50M, 70D, and 70M; as well an assembly that fits the earlier models including the AirStar 1, 2-1, 2-2, 3, 5 and 7.

Completing the new line of electrical parts, RPI offers Power Switches as well as the Power Switch/Circuit Breakers.

Need check valves or check valve upgrade kits? RPI has them! We offer them for the units that have the membrane dryers, desiccant dryers, as well as for the earlier 70's that use the 1/4" FPT fittings, and for the later AirStar 70D that uses the 3/8" FPT fittings.

All told, RPI has added ten new brass fittings, plus the hard-to-find metric tubing to fit the AirStar M and Neo

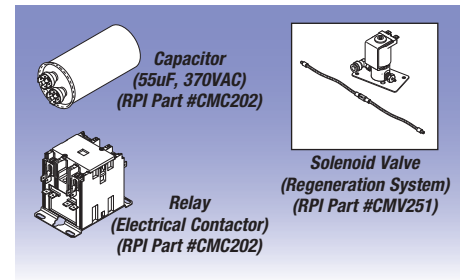

units. The black tubing is sold either by the actual length needed of 20" (or 28"), and also sold by the foot.

Last but not least are parts to fit the regeneration systems for the AirStar "D" units. The AirStar 10, 21D, 22D and 30 units use a .007" orifice assembly – so you will need RPI Part #CMA245. The orifice assembly is also built into the Regeneration Orifice Assembly, (RPI Part #CMA256), and is included in the Solenoid Valve (Regeneration System), RPI Part #CMV251.

On the other hand, the AirStar 50D and 70D use a .010" orifice assembly – so you will need RPI Part #CMA246. This part is built into the .010" Regeneration Orifice Assembly, (RPI Part #CMA252), and is included in the Solenoid Valve (Regeneration System), RPI Part #CMV250.

As an added value from RPI is the Solenoid Valve Repair Kit (RPI Part #VPK006), which allows you to repair both of these Solenoid Valves instead of replacing the complete assembly.

Keep in mind that all parts mentioned in this article are listed in detail and by model they fit on page 4 of this newsletter.

And, if you need any technical assistance, please give us a call at 800-221-9723 – we are here to assist you from 8:00 am - 4:30 pm (Pacific Time), or visit www.rpiparts.com.

All rights reserved. No part of this newsletter may be reproduced or utilized in any form or by any other means without permission in writing from the Publisher. Inquiries should be addressed to: RPI, Marketing Department, P.O. Box 940250, Simi Valley, California 93065. Additional copies of The Alternate Source® may be obtained by contacting RPI. Please feel free to Call: (800) 221-9723, Fax: (818) 882-7028, or E-Mail: moreinfo@rpiparts.com your request. Parts mentioned in this newsletter are manufactured by Replacement Parts Industries, Inc. to fit the equipment noted. All product names used in this document are trademarks or registered trademarks of their respective holders. RPI © 2019.

**CALL (800) 221-9723 or (818) 882-8611 • FAX (818) 882-7028 • WEBSITE www.rpiparts.com
E-MAIL moreinfo@rpiparts.com • E-MAIL order@rpiparts.com • E-MAIL techhelp@rpiparts.com**