

Parts to fit A-dec Dental Delivery Unit Components: Control Block and Foot Control

4 New Kits and more Parts to fit A-dec Dental Delivery Units!

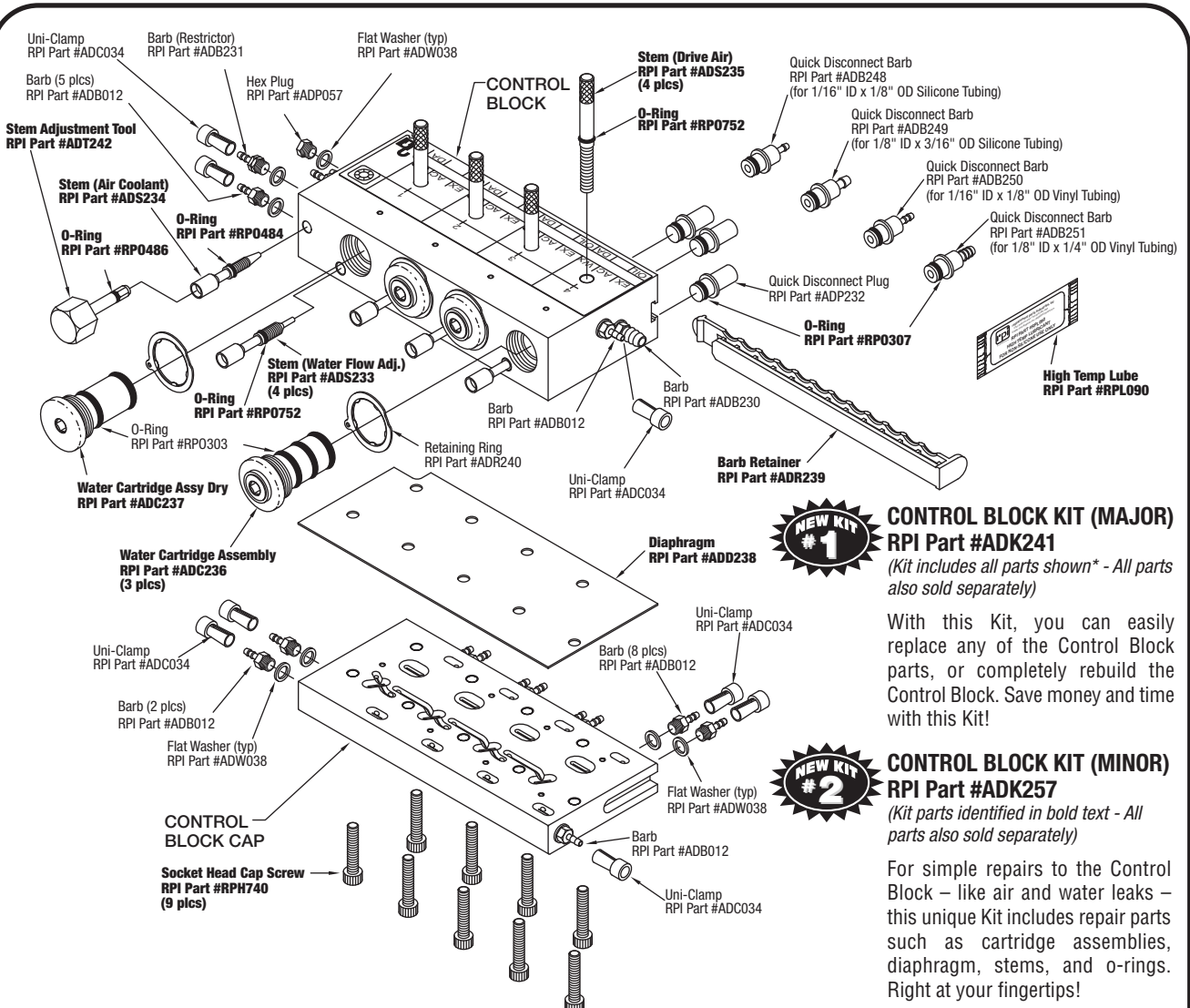

EXPLODED VIEW OF
A-dec 500 CONTROL BLOCK ASSEMBLY

CONTROL BLOCK KIT (MAJOR)
RPI Part #ADK241
(Kit includes all parts shown* - All parts also sold separately)

With this Kit, you can easily replace any of the Control Block parts, or completely rebuild the Control Block. Save money and time with this Kit!

CONTROL BLOCK KIT (MINOR)
RPI Part #ADK257
(Kit parts identified in bold text - All parts also sold separately)

For simple repairs to the Control Block – like air and water leaks – this unique Kit includes repair parts such as cartridge assemblies, diaphragm, stems, and o-rings. Right at your fingertips!

* Control Block Kit (Major) does not include Control Block Cap and Control Block.

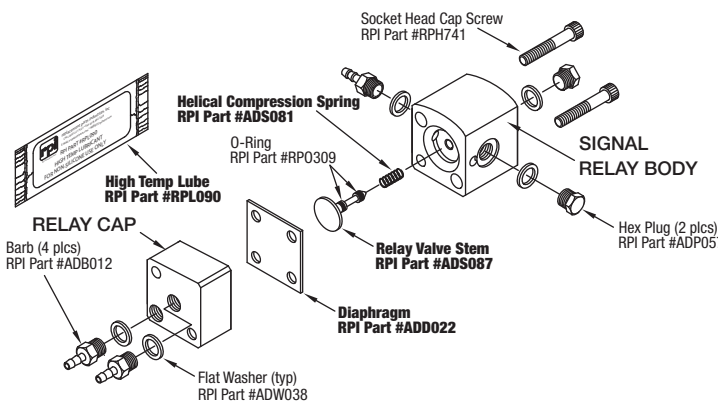

EXPLODED VIEW OF
A-dec 500 WATER COOLANT RELAY ASSEMBLY

WATER COOLANT RELAY KIT
RPI Part #ADK252
(Kit parts identified in bold text - All parts also sold separately)

This Kit includes the Diaphragm, Helical Compression Spring, Relay Valve Stem, and High Temp Lubricant – all of the essential parts you need to easily repair the Water Coolant Relay Assembly!



replacement parts industries, inc.

CALL (800) 221-9723 • FAX (818) 882-7028 • EMAIL order@ripiparts.com • WEBSITE www.rpiparts.com

The above parts are manufactured by Replacement Parts Industries, Inc. to fit A-dec equipment. All product names used in this document are trademarks or registered trademarks of their respective holders. Web Updated 08/11



Parts to fit A-dec Dental Delivery Unit Components: Control Block and Foot Control



CONTROL BLOCK KIT (MAJOR)

RPI Part #ADK241

(All parts also sold separately)

With this Kit, you can easily replace any of the Control Block parts, or completely rebuild the Control Block. Save money and time with this Kit!

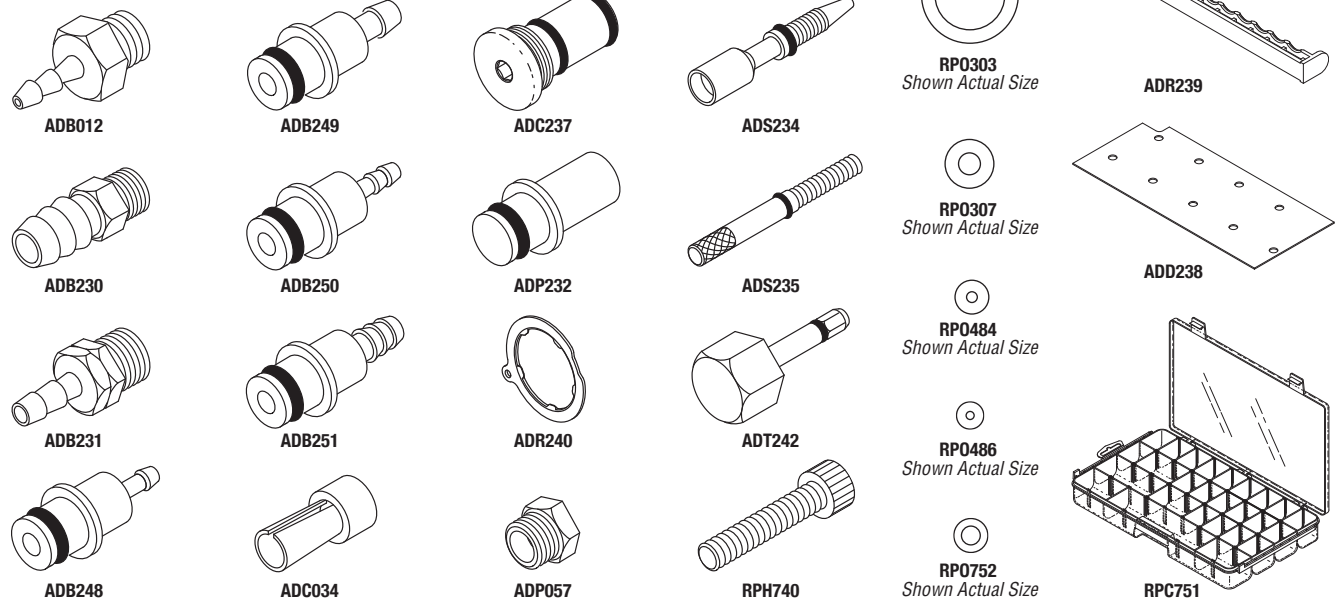

	RPI PART #	OEM PART #	DESCRIPTION	KIT QTY	REORDER QTY (PER PKG)	Fits Control Block 300 SERIES (OEM #38.1831.00)	Fits Control Block 500 SERIES (OEM #38.1776.00)
KIT	ADK241	38.1776.00 (Block Assy)	CONTROL BLOCK KIT (MAJOR)	1	1	▲	•
	ADB012	023-004-01	BARB	10	10	•	•
	ADB230	023.505.01	BARB	10	10	•	•
	ADB231	023.811.00	BARB (RESTRICTOR)	10	10	•	•
	ADB248	026.174.01	QUICK DISCONNECT BARB 1/8" SILICONE	5	5	•	•
	ADB249	026.175.01	QUICK DISCONNECT BARB 3/16" SILICONE	5	5	•	•
	ADB250	026.161.00	QUICK DISCONNECT BARB 1/8" VINYL	5	5	•	•
	ADB251	026.088.00	QUICK DISCONNECT BARB 1/4" VINYL	5	5	•	•
	ADC034	025.007.01	UNI-CLAMP	20	20	•	•
	ADC236	38.1780.00	WATER CARTRIDGE ASSEMBLY	4	1	•	•
	ADC237	38.1783.00	WATER CARTRIDGE ASSY DRY	3	1	•	•
	ADD238	38.1787.01	DIAPHRAGM	5	5	•	•
	ADP057	021.016.01	HEX PLUG	10	10	•	•
	ADP232	026.160.01	QUICK DISCONNECT PLUG	5	5	•	•
	ADR239	38.1800.00	BARB RETAINER	3	1	•	•
	ADR240	38.1779.01	RETAINING RING	5	5	•	•
	ADS233	38.0516.00	STEM (WATER FLOW ADJ.)	4	1	•	•
	ADS234	38.0526.00	STEM (AIR COOLANT)	2	1	•	•
	ADS235	38.1785.01	STEM (DRIVE AIR)	4	1	•	•
	ADT242	38.1808.01 & 98.0867.02	STEM ADJUSTMENT TOOL	5	5	•	•
	ADW038	004-005-00	FLAT WASHER	50	50	•	•
	RPC751	(OEM Part # Not Available)	STORAGE CASE	1	1	•	•
	RPH740	001.240.00	SOCKET HEAD CAP SCREW	25	25	•	•
	RPL090	98.0090.00	HIGH TEMP LUBRICANT	5	5	•	•
	RPO303	030.012.01	O-RING	12	12	•	•
	RPO307	030.006.02	O-RING	12	12	•	•
	RPO484	030.003.01	O-RING	12	12	•	•
	RPO486	034.002.01	O-RING	12	12	•	•
	RPO752	035.034.01	O-RING	12	12	•	•

▲ All parts in this kit fit the Control Block 300 series (OEM Part #38.1831.00) with the exception of the following parts: Diaphragm (RPI Part #ADD238), Barb Retainer (RPI Part #ADR239) Stem (Water Flow Adj.) (RPI Part #ADS233), Stem (Air Coolant) (RPI Part #ADS234), Stem Adjustment Tool (RPI Part #ADT242), and O-Ring (RPI Part #RPO486).



CONTROL BLOCK KIT (MINOR)

RPI Part #ADK257

(All parts also sold separately)

For simple repairs to the Control Block – like air and water leaks – this unique Kit includes repair parts such as cartridge assemblies, diaphragm, stems, and o-rings. Right at your fingertips!



ADC236

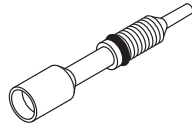

ADS233



ADS235

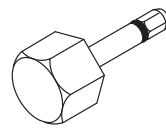

ADT242

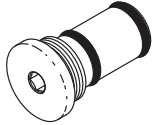

ADC237

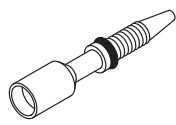

ADS234

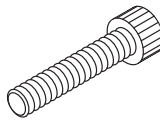

RPH740



RPL090



RPO307
Shown Actual Size



RPO484
Shown Actual Size



RPO486
Shown Actual Size



RPO752
Shown Actual Size

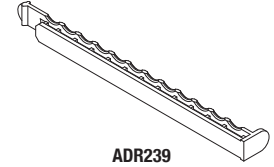

ADR239

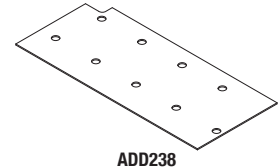

ADD238

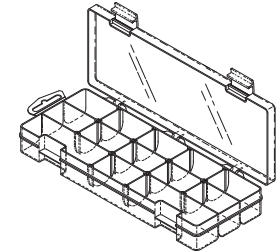

RPC753

KIT

RPI PART #	OEM PART #	DESCRIPTION	KIT QTY	REORDER QTY (PER PKG)	Fits Control Block 300 SERIES (OEM #38.1831.00)	Fits Control Block 500 SERIES (OEM #38.1776.00)
ADK257	38.1776.00 (Block Assy)	CONTROL BLOCK KIT (MINOR)	1	1	▲	•
ADC236	38.1780.00	WATER CARTRIDGE ASSEMBLY	4	1	•	•
ADC237	38.1783.00	WATER CARTRIDGE ASSY DRY	2	1	•	•
ADD238	38.1787.01	DIAPHRAGM	5	5	•	•
ADR239	38.1800.00	BARB RETAINER	2	1	•	•
ADS233	38.0516.00	STEM (WATER FLOW ADJ.)	4	1	•	•
ADS234	38.0526.00	STEM (AIR COOLANT)	2	1	•	•
ADS235	38.1785.01	STEM (DRIVE AIR)	4	1	•	•
ADT242	38.1808.01 & 98.0867.02	STEM ADJUSTMENT TOOL	5	5	•	•
RPC753	(OEM Part # Not Available)	STORAGE CASE	1	1	•	•
RPH740	001.240.00	SOCKET HEAD CAP SCREW	25	25	•	•
RPL090	98.0090.00	HIGH TEMP LUBRICANT	5	5	•	•
RPO307	030.006.02	O-RING	12	12	•	•
RPO484	030.003.01	O-RING	12	12	•	•
RPO486	034.002.01	O-RING	12	12	•	•
RPO752	035.034.01	O-RING	12	12	•	•

▲ All parts in this kit fit the Control Block 300 series (OEM Part #38.1831.00) with the exception of the following parts: Diaphragm (RPI Part #ADD238), Barb Retainer (RPI Part #ADR239) Stem (Water Flow Adj.) (RPI Part #ADS233), Stem (Air Coolant) (RPI Part #ADS234), Stem Adjustment Tool (RPI Part #ADT242), and O-Ring (RPI Part #RPO486).



WATER COOLANT RELAY KIT

RPI Part #ADK252

(All parts also sold separately)

This Kit includes 1 piece each of the Diaphragm (RPI Part #ADD022), Helical Compression Spring (RPI Part #ADS081), Relay Valve Stem (RPI Part #ADS087), and High Temp Lubricant (RPI Part #RPL090) – all of the essential parts you need to easily repair the Water Coolant Relay Assembly!

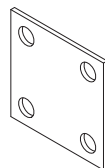

ADD022



ADS081



ADS087

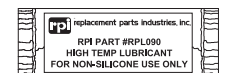

RPL090

KIT

RPI PART #	OEM PART #	DESCRIPTION	Fits Delivery Unit 500 SERIES (OEM #38.1810.00)
ADK252	38.1810.00 (Relay Assy)	WATER COOLANT RELAY KIT - All parts also sold separately	•



FOOT CONTROL SERVICE KIT

RPI Part #ADK245

(Kit parts identified in bold text - All parts also sold separately)

With this Service Kit, you can rebuild the air and water controls or rebuild both!

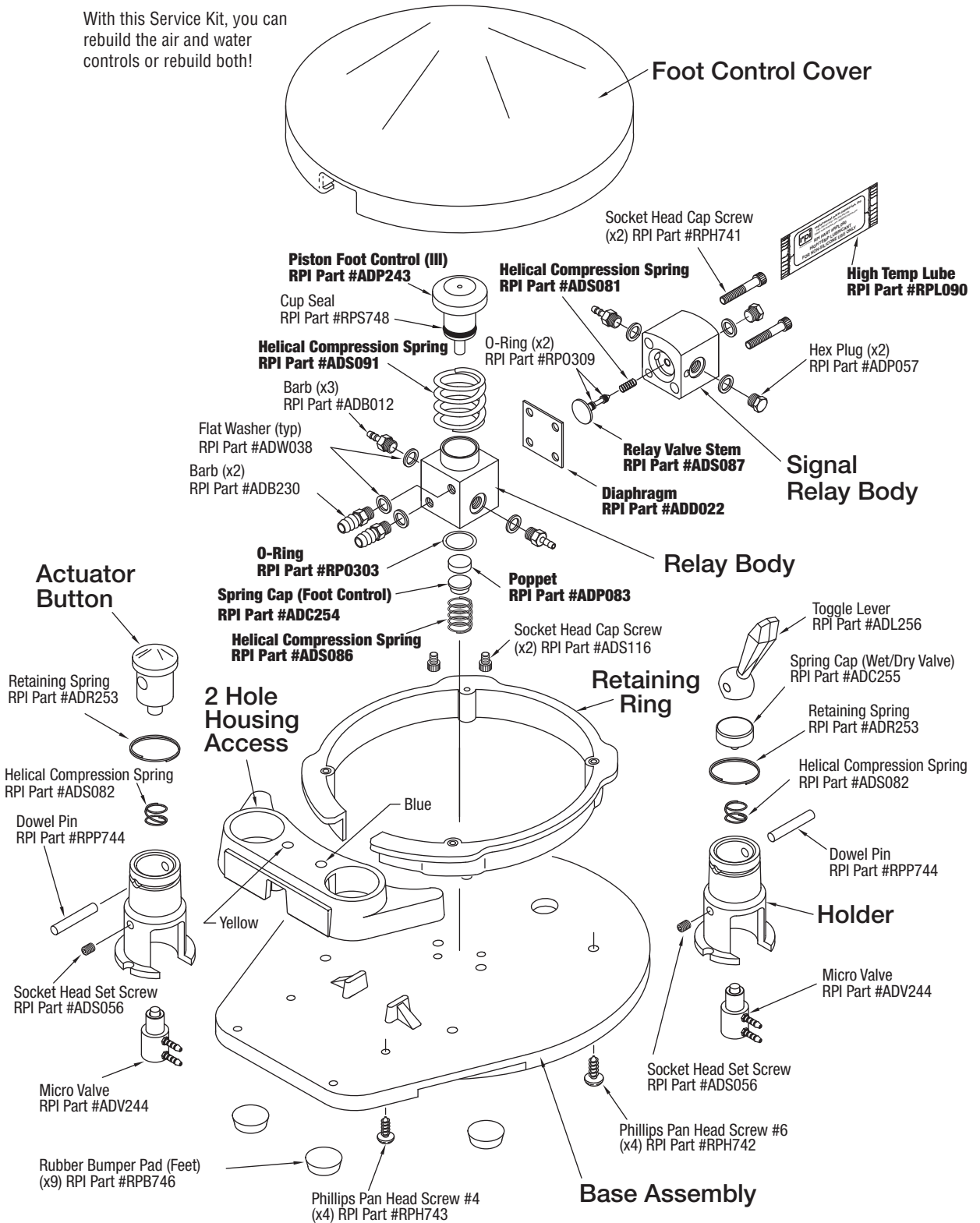

**EXPLODED VIEW OF
A-dec FOOT CONTROL ASSEMBLY**



FOOT CONTROL SERVICE KIT

RPI Part #ADK245

(All parts also sold separately)

With this Service Kit, you can rebuild the air and water controls or rebuild both!

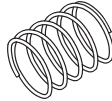

ADS086



ADS087



RPL090

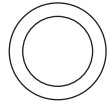

RPO303
Shown Actual Size



ADC254



ADP083



ADS081

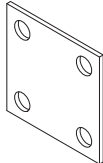

ADD022

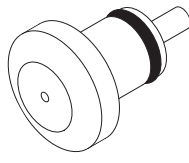

ADP243

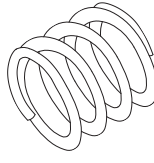

ADS091

Fits Foot Control (OEM Part #38-0050-00)
Fits Foot Control II (OEM Part #38-0254-00)
Fits Foot Control III (OEM Part #'s 38-1601-00, 38-1603-00, & 38-1700-00)
Fits Foot Control Lever Action (OEM Part #38-0200-00)
Fits Foot Control 300 Series
Fits Foot Control 500 Series

RPI PART #	OEM PART #	DESCRIPTION	<i>Fits Foot Control (OEM Part #38-0050-00)</i>	<i>Fits Foot Control II (OEM Part #38-0254-00)</i>	<i>Fits Foot Control III (OEM Part #'s 38-1601-00, 38-1603-00, & 38-1700-00)</i>	<i>Fits Foot Control Lever Action (OEM Part #38-0200-00)</i>	<i>Fits Foot Control 300 Series</i>	<i>Fits Foot Control 500 Series</i>	Amount Per Package
ADK245	90.0593.00	FOOT CONTROL SERVICE KIT • Includes (1) each of the following parts • All parts also sold separately							1
ADC254	22.0050.00	SPRING CAP (FOOT CONTROL)	•	•	•	•	•	•	1
ADD022	38-0054-00	DIAPHRAGM	•	•	•	•	•	•	6
ADP083	22-0060-00	POPPE	•	•	•	•	•	•	10
ADP243	38.0760.00	PISTON (FOOT CONTROL III)	•	•	•	•	•	•	1
ADS081	10-0440-00	HELICAL COMPRESSION SPRING	•	•	•	•	•	•	10
ADS086	22-0580-00	HELICAL COMPRESSION SPRING	•	•	•	•	•	•	10
ADS087	22-0778-00	RELAY VALVE STEM	•	•	•	•	•	•	5
ADS091	013-011-00	HELICAL COMPRESSION SPRING	•	•	•	•	•	•	10
RPL090	98.0090.00	HIGH TEMP LUBRICANT	•	•	•	•	•	•	5
RPO303	030.012.01	O-RING	•	•	•	•	•	•	12

RPI also offers these new parts to fit A-dec Dental Delivery Units!

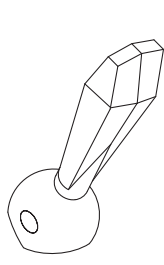

ADL256



ADC255



ADS056



ADS116

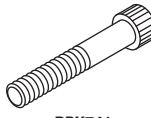

RPH741



RPH742



RPH743



RPO309
Shown Actual Size

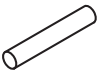

RPP744

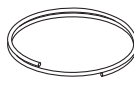

ADR253



ADS082

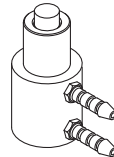

ADV244

Fits Foot Control (OEM Part #38-0050-00)
Fits Foot Control II (OEM Part #38-0254-00)
Fits Foot Control III (OEM Part #'s 38-1601-00, 38-1603-00, & 38-1700-00)
Fits Foot Control Lever Action (OEM Part #38-0200-00)
Fits Foot Control 300 Series
Fits Foot Control 500 Series

RPI PART #	OEM PART #	DESCRIPTION	<i>Fits Foot Control (OEM Part #38-0050-00)</i>	<i>Fits Foot Control II (OEM Part #38-0254-00)</i>	<i>Fits Foot Control III (OEM Part #'s 38-1601-00, 38-1603-00, & 38-1700-00)</i>	<i>Fits Foot Control Lever Action (OEM Part #38-0200-00)</i>	<i>Fits Foot Control 300 Series</i>	<i>Fits Foot Control 500 Series</i>	Amount Per Package
ADC255	38.0066.00	SPRING CAP (WET/DRY VALVE)	•	•	•	•	•	•	1
ADL256	38.0075.09, 38.0074.00, 38.0074.01, 38.0075.03	TOGGLE LEVER	•	•	•	•	•	•	1
ADR253	010.056.00	RETAINING SPRING	•	•	•	•	•	•	3
ADS056	007-002-00 007.021.00	SOCKET HEAD SET SCREW	•	•	•	•	•	•	20
ADS082	22-0040-00	HELICAL COMPRESSION SPRING	•	•	•	•	•	•	10
ADS116	003-078-00	SOCKET HEAD CAP SCREW	•	•	•	•	•	•	25
ADV244	33.0138.00 29.1085.00	MICRO VALVE	•	•	•	•	•	•	1
RPH741	001.102.00	SOCKET HEAD CAP SCREW	•	•	•	•	•	•	25
RPH742	003.0221.00	PHILLIPS PAN HEAD SCREW #6	•	•	•	•	•	•	25
RPH743	003.0221.00	PHILLIPS PAN HEAD SCREW #4	•	•	•	•	•	•	25
RPO309	030-001-00	O-RING	•	•	•	•	•	•	12
RPP744	011.016.00	DOWEL PIN	•	•	•	•	•	•	10

Introducing 4 New Kits to fit A-dec Dental Delivery Units!



CONTROL BLOCK KIT (MAJOR) RPI Part #ADK241

With this Kit, you can easily replace any of the Control Block parts, or completely rebuild the Control Block. Save money and time with this Kit!



CONTROL BLOCK KIT (MINOR) RPI Part #ADK257

For simple repairs to the Control Block – like air and water leaks – this unique Kit includes repair parts such as cartridge assemblies, diaphragm, stems, and o-rings. Right at your fingertips!



WATER COOLANT RELAY KIT RPI Part #ADK252

This Kit includes the Diaphragm, Helical Compression Spring, Relay Valve Stem, and High Temp Lubricant – all of the essential parts you need to easily repair the Water Coolant Relay Assembly!



FOOT CONTROL SERVICE KIT RPI Part #ADK245

With this Service Kit, you can rebuild the air and water controls or rebuild both!

What's more ... RPI also offers these new parts to fit A-dec Dental Delivery units!

- Barb
 - Barb Retainer
 - Diaphragm
 - Dowel Pin
 - Micro Valve
- Piston (Foot Control III)
 - Quick Disconnect Barb
 - Quick Disconnect Plug
 - Retaining Ring
 - Retaining Spring
- Spring Cap (Foot Control)
 - Spring Cap (Wet/Dry Valve)
 - Stem (Air Coolant)
 - Stem (Drive Air)
 - Stem (Water Flow Adj.)
- Stem Adjustment Tool
 - Toggle Lever
 - Water Cartridge Assembly
 - Water Cartridge Assy Dry
 - and more!

**RPI is your Best Source
for parts to fit A-dec
Dental Delivery Units!**

Look inside for information on:

- Control Block Kit (Major)
- Control Block Kit (Minor)
- Control Block Assembly
- Foot Control Service Kit
- Foot Control Assembly
- Water Coolant Relay Kit
- Water Coolant Relay Assembly

Exploded View

Exploded View

Exploded View

ADDRESS SERVICES REQUESTED

!rpi replacement parts industries, inc.
20338 Cortisco Street • Chatsworth, California • 91311

PRESORTED STANDARD
U.S. POSTAGE PAID
VAN NUYS, CA
PERMIT NO. 2399