

Air Techniques, Apollo/Midmark®, DentalEZ®/Custom Air/RamVac, Jun-Air, MatrX/Midmark®, MDT McKesson, Midmark® & Tech West/Turbine Ind.



New Parts, Tools and PM Kits to fit Dental Compressors!

New Tools

Removes oil from the compressor without tilting or disassembling the unit!



RPI Part #RPT842
OEM Part # (No OEM Part # Available)

SYRINGE PUMP/EXTRACTOR

- 200 CC capacity, clear body
- This essential, one-of-a-kind tool allows complete removal of oil from a compressor without needing to tilt or disassemble the unit - It's the RPI Advantage!
- Includes all parts as shown
- Also available: Cap (RPI Part #RPC847), Seal Kit (RPI Part #RPK846), and Tubing (1/4" OD CLR Poly) (RPI Part #RPT276) - sold by the foot

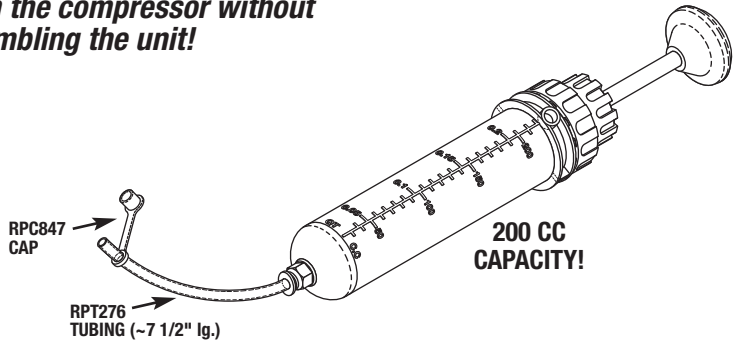

Perfect solution for carrying, storing and disposing of used oil!

RPI Part #RPB838
OEM Part # (No OEM Part # Available)

DISPOSAL BAG

- 3 per package
- The perfect solution for carrying, storing, and disposing of used oil. This one gallon Disposal Bag is constructed of durable clear plastic so you can easily see when it is full to avoid nasty overflows. It also has an expandable base to help stabilize it as it is being filled to help prevent it from tipping over. Plus, transporting the messy oil is a snap with the built in handle and tight sealing cap - It's the RPI Advantage!
- Also included in: Compressor PM Kits (see pages 2-3)

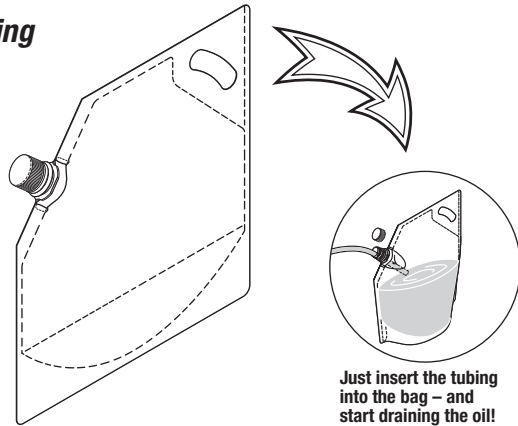

Gives you complete control while draining oil!

RPI Part #RPV841
OEM Part #PVV50525 (Plug) (Apollo/Midmark)

DRAIN VALVE

- Tee handle; 1/8" MPT
- Includes all parts as shown
- Replace the existing drain plug with RPI's new, one-of-a-kind Drain Valve to make your next oil change a breeze. RPI's Drain Valve has a special Tee-handle that allows you to easily open and close the valve to control the flow of oil as it is draining into the disposal bag - It's the RPI Advantage!
- Also available: 1/4" Teflon Thread Sealing Tape (RPI Part #RPT579) and Tubing (5/16" ID CLR PVC) (RPI Part #RPT849) - sold by the foot

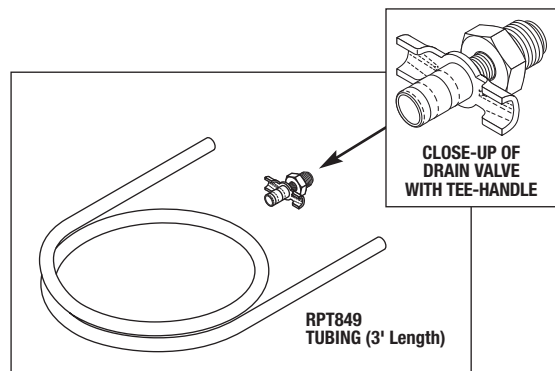

Plus, look inside for 56 New Compressor PM Kits!



replacement parts industries, inc.

CALL (800) 221-9723 • FAX (818) 882-7028 • EMAIL order@ripiparts.com • WEBSITE www.ripiparts.com

The company, product and service names used in this document are for identification purposes only. All trademarks and registered trademarks are the property of their respective owners. Show Dental 10/13

DENTAL COMPRESSORS -

Air Techniques, Apollo/Midmark®, DentalEZ®/Custom Air/RamVac, Jun-Air, MatrX/Midmark®, MDT McKesson, Midmark®, & Tech West/Turbine Industries

SECTION

4

PAGE

414

UPDATED

10/13



COMPRESSOR PM KITS

RPI Parts Included In PM Kits

RPI Part #	OEM Part #	Models	Air Intake Filter Elements						Coalescing Filter Elements						Oil		Acc.											
			CME004	CME067	CME069	CME071	CME074	CMF013	CMF073	CMF075	CMK065	CME043	CME044	CME102	CME103	CME104	CME105	CME107	CME110	CMK024	CMK025	CML001	CML119	RPB838	RP0848	CMG197		
AIR TECHNIQUES																												
CMK141	87351	AirStar 1 & 10							1			1	1															
CMK142	87352	AirStar 2-1, 2-2, 3, 21, 22 & 30							2			1	1															
CMK143	87353	AirStar 5 & 50							4			1	1															
CMK144	87354	AirStar 7 & 70							6			2	2															
APOLLO/MIDMARK®																												
CMK173	ACA8540																				1	4		1				
CMK160	ACA8540																				1	3		1				
CMK167	ACA8540																				1	1		1				
CMK159	ACA8540																				1	2		1				
CMK170	ACA8540																											
CMK171	ACA8540																				1							
CMK172	ACA8540																				1							
DENTALEZ®/CUSTOM AIR/RAMVAC																												
CMK076*	004016																											
CMK092*	004015																											
CMK101*	004017																											
CMK152	65468176																						2	1	1	1		
CMK153	65468177																						4	1	2	2		
CMK154	65468178																						6	1	4	4		
CMK145	65468179																											
CMK146	65468180																											
CMK147	65468186																											
CMK191	004444																											
CMK148	65468181																											
CMK192	004445																											
CMK149	65468182																											
CMK193	004446																											
CMK150	65468183																											
CMK194	004449																											
CMK151	65468184																											
CMK195	004447																											
MATRIX/MIDMARK																												
CMK185	No OEM Part # Av																						1		1			
CMK186	No OEM Part # Av																						2		1			
CMK187	No OEM Part # Av																						3		1			
CMK167	77000958																						1		1			
CMK168	77000959																						2		1			
CMK169	77000960																						3		1			
CMK161	No OEM Part # Av																											
CMK162	No OEM Part # Av																											
CMK163	No OEM Part # Av																											
CMK164	No OEM Part # Av																											
CMK165	No OEM Part # Av																											
CMK166	No OEM Part # Av																											
MIDMARK®																												
CMK158	77001633																				1	1		1				
CMK159	77001634																				1	2		1				
CMK160	77001635																				1	3		1				
CMK155	77001636																				1							
CMK156	77001610																				1							
CMK157	77001611																				1							
TECH WEST																												
CMK188	CSKL-1																				1	1		1				
CMK182	CSKL-1P																				1	1		1				
CMK189	CSKL-2																				1	2		1				
CMK183	CSKL-2P																				2	1						
CMK190	CSKL-3	ACL6T2/ND (2005 and earlier)							1												1	3		1				
CMK184	CSKL-3P	ACL6T2 (2006 and later)							1												1	3		1				
CMK174	CSKO-1	AC02S1/ND & AC02S2/ND (2005 and earlier)							2														1					
CMK175	CSKO-1P	AC02S1/ND & AC02S2/ND (2006 and later)							2														1					
CMK176	CSKO-2	AC04S2/ND & AC04D2/ND (2005 and earlier)							4														1					
CMK177	CSKO-2P	AC04D2/ND (2006 and later)							4														1					
CMK178	CSKO-3	AC06T2/ND (2005 and earlier)							6														1					
CMK179	CSKO-3P	AC06T2/ND (2006 and later)							6														1					

**Click Here
for an updated
list of RPI's
Dental Compressor
PM Kits!**

* Fits only DentalEZ/Custom Air/Ramvac Compressors

Air Intake Filter Elements

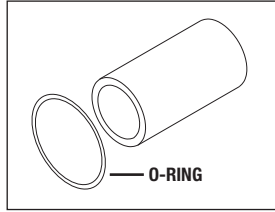

RPI Part #CME004
OEM Part # (Fits RPI Part #CMK003 only)

REPLACEMENT FILTER ELEMENT

- Replacement Filter Element for Fresh Air Intake Filter Kit (RPI Part #CMK003) only



RPI Part #CME07
OEM Part #003965 (DentalEZ/Custom Air/RamVac); TIF-100 (Tech West)

AIR FILTER ELEMENT

- 2 micron paper filter



RPI Part #CME069
OEM Part #TIF-200 (Tech West)

AIR FILTER ELEMENT

- 2 micron paper filter

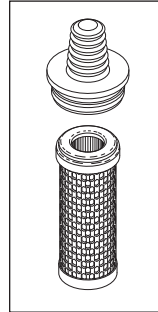

RPI Part #CME071
OEM Part #77001541 (Matrix & Midmark)

AIR FILTER ELEMENT

- Includes: Rubber air filter cap

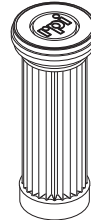

RPI Part #CME074
OEM Part #JA5412500 (DentalEZ/Custom Air/Jun-Air/RamVac)

INTAKE FILTER ELEMENT

- 5 micron paper filter with rubber end caps

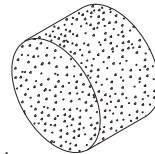

RPI Part #CMF013
OEM Part #77007079 (Matrix/Midmark); AAF-100 (Tech West)

FOAM ELEMENT

- Size: 2" dia. x 2" lg.

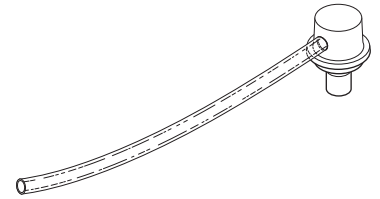

RPI Part #CMF073
OEM Part #JA5413210 (DentalEZ/Custom Air/Jun-Air/RamVac)

AIR INTAKE FILTER

- 5 micron polyester filter

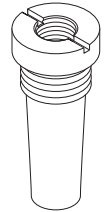

RPI Part #CMF075
OEM Part #JA5412400 (DentalEZ/Custom Air/Jun-Air/RamVac)

INTAKE FILTER

- 5 micron polyester filter

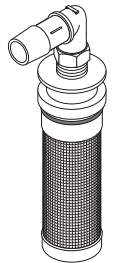

RPI Part #CMK065
OEM Part #89938/89831 (Air Techniques)

AIR FILTER ELEMENT KIT

- 10 micron paper filter

Compressor Oil

RPI Part #CML001
OEM Part #60051 (Air Techniques); ACA85921 (Apollo); 3-08-0084-30 (MDT McKesson); 64651001 (DentalEZ/Custom Air/RamVac); 77000220 (Matrix); CO-100 (Tech West); 2485 (DCI)

COMPRESSOR OIL

- 16 oz. (~0.75L) bottle



Also available by the case - Ask for RPI Part #CML045!

RPI Part #CML119
OEM Part #JA64651-004 (DentalEZ/Custom Air/RamVac)/ 64651-004 (Jun-Air)

SYNTHETIC COMPRESSOR OIL

- 16 oz. (~0.75L) bottle

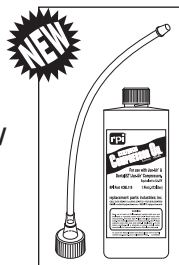

Also available by the case - Ask for RPI Part #CML120!

Accessories



RPI Part #CMG197
OEM Part #JA6235000 (DentalEZ/Custom Air/RamVac)/6235000 (Jun-Air)

DRAIN PLUG GASKET (3/pkg)

- Size: .668" ID x .889" OD x .066" thk
- Fits: Oil Plug



RPI Part #RP0848
OEM Part #JA6244000 (DentalEZ/Custom Air/RamVac)/6244000 (Jun-Air)

O-RING (RIB COVER GASKET)

- Size: 176mm ID x 182mm OD x 3mm C/S
- Fits: Ribbed Cover of the JunAir M6 Motors

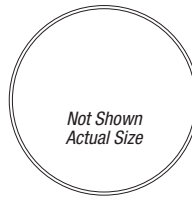

Easy to fill, transport and dispose used oil!

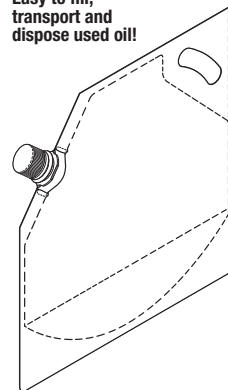

Just insert the tubing into the bag - and start draining the oil!



RPI Part #RPB838
OEM Part # (No OEM Part # Available)

DISPOSAL BAG

- 3 per package; 1 gallon capacity

Coalescing Filter Elements

RPI Part #CME043
OEM Part #004016
(DentalEZ/Custom Air/RamVac)

COALESCING FILTER ELEMENT

- Type B; .5 micron;
red element material

*Wilkerson
Brand*

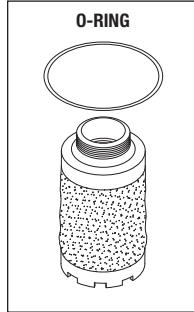

RPI Part #CME105
OEM Part #JA4081600/64800-214
(DentalEZ/Custom Air/Jun-Air/RamVac)

COALESCING FILTER ELEMENT

- 0.01 micron filter element

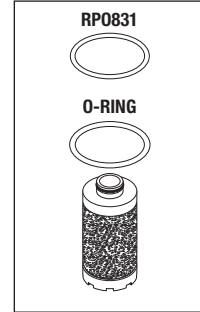

RPI Part #CME044
OEM Part #003846
(DentalEZ/Custom Air/RamVac)

COALESCING FILTER ELEMENT

- Type C; 0.01 micron;
red element material

*Wilkerson
Brand*

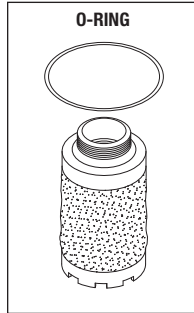

RPI Part #CME107
OEM Part #JA4081602 (DentalEZ/Custom
Air/RamVac)/4081602 (Jun-Air)

FILTER ELEMENT

- 0.01 micron

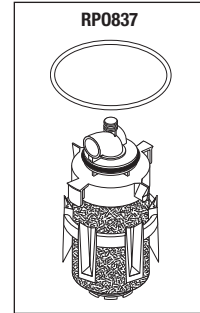

RPI Part #CME102
OEM Part #87367 (Air Techniques)

FILTER ELEMENT

- 35 micron filter

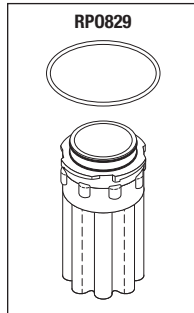

RPI Part #CME110
OEM Part #CFE0-375 (Tech West)

COALESCING FILTER ELEMENT

- 0.01 micron filter material

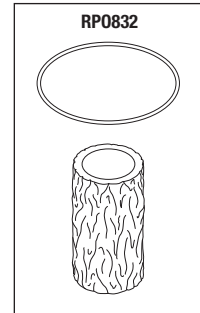

RPI Part #CME103
OEM Part #87336 (Air Techniques)

FILTER ELEMENT

- 2 micron paper filter

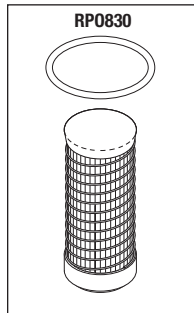

RPI Part #CMK024
OEM Part #ACA86050 (Apollo); 648-00209
(DentalEZ/Custom Air/Jun-Air/RamVac);
77005005 (Matrix); 77005009 (Midmark);
MTP-95-548 (Wilkerson)

COALESCING FILTER ELEMENT

- Type C; 0.01 micron;
Red material

*Wilkerson
Brand*

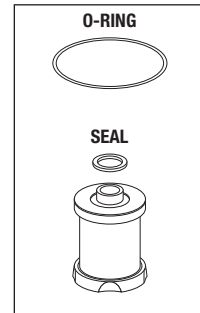

RPI Part #CME104
OEM Part #JA4080500/64800-213
(DentalEZ/Custom Air/Jun-Air/RamVac)

FILTER ELEMENT

- Type "D" 0.003 micron activated
carbon

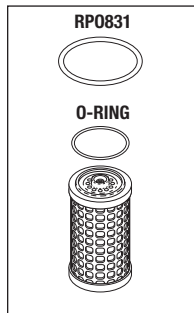

RPI Part #CMK025
OEM Part #ACA86055 (Apollo/Midmark);
645-45010 (DentalEZ/Custom Air/RamVac);
JA40815000 (Jun-Air); CFE-375 (Tech West)

COALESCING FILTER ELEMENT

- Type C; 0.01 micron;
red material

*Wilkerson
Brand*

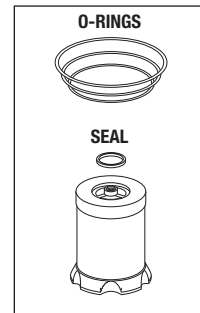

New Parts



RPI Part #CME102
OEM Part #87367 (Air Techniques)

FILTER ELEMENT

- Size: ~1.53" OD x 2.70" lg.
- 35 micron filter
- Includes all parts as shown and PM Sticker
- Included in: Compressor PM Kits (RPI Part #'s CMK141, CMK142, CMK143 & CMK144)
- Also available: Filter Element (Top) (RPI Part #CME103)

Fits: Bottom of the Membrane Dryer Assembly (Air Techniques Part #87175)

Models: *Air Techniques:*
 AirStar 1, 2-1, 2-2, 3, 5, 7, 10, 21, 22, 30, 50 & 70

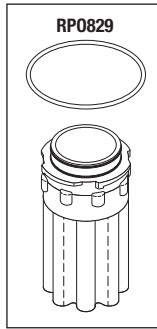

RPI Part #CME105
OEM Part #4081600/64800-214
 (DentalEZ/Custom Air/Jun-Air/RamVac)

COALESCING FILTER ELEMENT

- Size: ~1.38" OD x 2.62" lg.
- 0.01 micron filter element
- Includes all parts as shown and PM Sticker
- Included in: Compressor PM Kits (RPI Part #'s CMK145, CMK146, CMK147, CMK148, CMK149, CMK150, CMK151, CMK152, CMK153 & CMK154)

Fits: Coalescing Combination Filter Assembly

Models: *DentalEZ/Custom Air/Jun-Air/RamVac:* CA-711, 713, 721, 723, 725, 812, 822, 912 & 922 all Serial Numbers; CA-813/D, 823/D, 825/D/Q, 827-D, 829-D, 8212-T, 913, 923, 925/D, 927-D & 929-D (Serial #631602 and below)

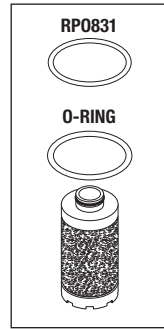

RPI Part #CME103
OEM Part #87336 (Air Techniques)

FILTER ELEMENT

- 2 micron paper filter
- Size: 1.12" OD x 2.74" H
- Includes all parts as shown and PM Sticker
- Included in: Compressor PM Kits (RPI Part #'s CMK141, CMK142, CMK143 & CMK144)
- Also available: Filter Element (Bottom) (RPI Part #CME102)

Fits: Top of the Membrane Dryer Assembly (Air Techniques Part #87175)

Models: *Air Techniques:*
 AirStar 1, 2-1, 2-2, 3, 5, 7, 10, 21, 22, 30, 50 & 70

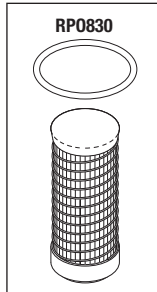

RPI Part #CME110
OEM Part #CFE0-375 (Tech West)

COALESCING FILTER ELEMENT

- Size: 1.39" OD x 2.50" lg.
- 0.01 micron filter material
- Includes all parts as shown and PM Sticker
- Included in: Compressor PM Kits (RPI Part #'s CMK175, CMK177, CMK179, CMK182, CMK183 & CMK184)
- Also available: Bowl O-Ring (RPI Part #RP0832)

Fits: Coalescing Filter Assembly (Tech West Part #CFA0-375 & Parker/Balston Part #2003N-1B1-BX) only

Models: *Tech West:*
 AC02S1/ND, 2S2/ND, 4D2/ND, 6T2/ND, RD2, ACL2S1/ND, 2S2/ND, 4D2/ND & 6T2/ND (2006 and later)

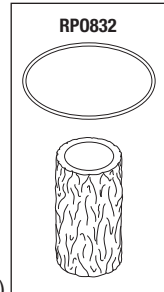

RPI Part #CME107
OEM Part #JA4081602 (DentalEZ/Custom Air/RamVac)/4081602 (Jun-Air)

FILTER ELEMENT

- 0.01 micron
- Includes all parts as shown and PM Sticker
- Included in: Compressor PM Kits (RPI Part #'s CMK191, CMK192, CMK193, CMK194 & CMK195)

Fits: "D" Series Absorption Dryers

Models: *DentalEZ/Custom Air/Jun-Air/RamVac:* CA-813/D, 823/D, 825/D/Q, 827-D, 829-D, 913, 923, 925/D, 927-D, 929-D & 8212-T (Serial #631603 and above);
Jun-Air: Compressors with "D" series Absorption Dryers

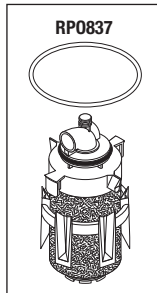

RPI Part #CMD108
OEM Part #JA4087602 (DentalEZ/Custom Air/RamVac)/4087602 (Jun-Air)

AUTO-DRAIN

- Replacement Auto-Drain to fit "D" style Absorption Dryer Assembly, Coalescing Filter Assembly (Jun-Air Part #4081502)
- Includes all parts as shown
- Also available: Bowl O-Ring (RPI Part #RP0837)

Fits: "D" Style Absorption Dryer Assembly

Models: *DentalEZ/Custom Air/Jun-Air/RamVac:* CA-813, 823, 825/D/Q, 827-D, 829-D, 913, 923, 925/D, 927-D, 929-D & 8212-T (Serial #631603 and above);
Jun-Air: Compressors with "D" series Absorption Dryers

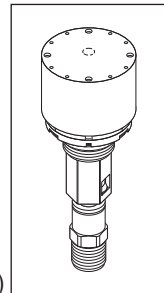

RPI Part #CME104
OEM Part #JA4080500/64800-213
 (DentalEZ/Custom Air/Jun-Air/RamVac)

CARBON FILTER ELEMENT

- Size: ~1.55" O.D. x 2.63" lg.
- Type "D" 0.003 micron activated carbon
- Includes all parts as shown and PM Sticker
- Included in: Compressor PM Kits (RPI Part #'s CMK152, CMK153 & CMK154)

Fits: Coalescing Combination Filter Assembly

Models: *DentalEZ/Custom Air/Jun-Air/RamVac:* CA-711, 713, 721, 723 & 725

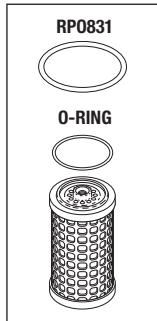

RPI Part #CMD111
OEM Part # (No OEM Part # Available)

AUTO DRAIN

- Includes all parts as shown
- Also available: Adapter Fitting (RPI Part #RPF651) and Bowl O-Ring (RPI Part #RP0832)

Fits: Coalescing Filter Assembly (Tech West Part #CFA0-375)

Models: *Tech West:*
 AC02S1/ND, 2S2/ND, 4D2/ND, 6T2/ND, ACL2S1/ND, 2S2/ND, 4D2/ND & 6T2/ND (2006 and later)

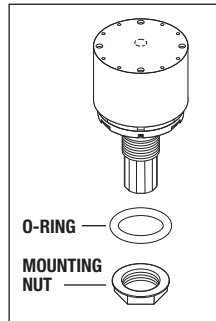



replacement parts industries, inc.

20338 Corisco Street • Chatsworth, California • 91311

PRESORTED STANDARD
U.S. POSTAGE PAID
VAN NUYS, CA
PERMIT NO. 2399

ADDRESS SERVICES REQUESTED

LOOK!

New Parts, Tools and PM Kits to fit Dental Compressors!

New Parts



RPI Part #CMS131
OEM Part #77005143 (Matrix & Midmark)

PRESSURE SWITCH

- 115/230VAC
- Contacts: N.C. DPST
- Factory set to: On at 80 PSI - Off at 100 PSI
- 1/4" FPT input port

Fits: Matrix and Midmark Compressors

Models: *Matrix/Midmark:* AMD-2, 2-115, 4, 6, 100, 100-2, 100-3, 101, 100, 100-2, 100-3, 101, 2000, 2001, 4000 & 6000;

Midmark: CL21, CL22, CL32, CL52, P21, P22, P32, P52 & P72

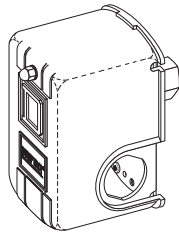

RPI Part #CMI106
OEM Part #JA4087700 (DentalEZ/
Custom Air/RamVac)/**4087700** (Jun-Air)

DIFFERENTIAL PRESSURE IND.

- Includes all parts as shown
- Fits:** Coalescing Filter Assembly on the Dryer "DH" Series

Models: *DentalEZ/Custom Air/*

Jun-Air/RamVac: CA-812, 813-D, 822, 823-D, 825/D, 827, 829-D, 8212-T, 912, 922, 925/D, 927-D & 929-D (Serial #631602 and below)

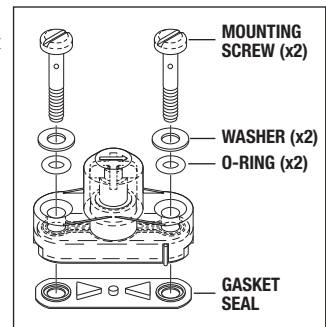

RPI Part #CMP196
OEM Part #JA7167000 (DentalEZ/
Custom Air/RamVac)/**7167000** (Jun-Air)

OIL PLUG

- Material: Nickel plated brass
- 3/8-19 BSPP
- Includes all parts as shown

Fits: Ribbed Cover

Models: *DentalEZ/Custom Air/Jun-Air/*
RamVac: CA-711, 713, 721, 723 & 725

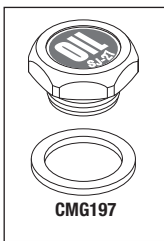

RPI Part #CMG197
OEM Part #JA6235000 (DentalEZ/
Custom Air/RamVac)/**6235000** (Jun-Air)

DRAIN PLUG GASKET (3/pkg)

- Material: Fiber
- Size: .668" ID x .889" OD x .066" thk
- Included in: Compressor PM Kits (RPI Part #'s CMK152, CMK153 & CMK154) and Oil Plug (RPI Part #CMP196)

Fits: Oil Plug

Models: *DentalEZ/Custom Air/Jun-Air/RamVac:*
CA-711, 713, 721, 723 & 725



RPI Part #CML119
OEM Part #JA64651-004 (DentalEZ/
Custom Air/RamVac)/**64651-004** (Jun-Air)

SYNTHETIC COMPRESSOR OIL

- 16 oz. (~0.75L) bottle
- ISO Grade 46; Equivalent to SJ-27F
- Includes all parts as shown
- Included in: Compressor PM Kits (RPI Part #'s CMK152, CMK153 & CMK154)

Fits: Compressor Head

Models: *DentalEZ/Custom Air/Jun-Air/*
RamVac: CA-711, 713, 721, 723 & 725



RPI Part #RP0848
OEM Part #JA6244000 (DentalEZ/
Custom Air/RamVac)/**6244000** (Jun-Air)

O-RING (RIB COVER GASKET)

- Material: Buna N
- Size: 176mm ID x 182mm OD x 3mm C/S
- Included in: Compressor PM Kits (RPI Part #'s CMK152, CMK153 & CMK154)

Fits: Ribbed Cover of the JunAir M6 Motors

Models: *DentalEZ/Custom Air/Jun-Air/RamVac:*
CA-711, 713, 721, 723 & 725

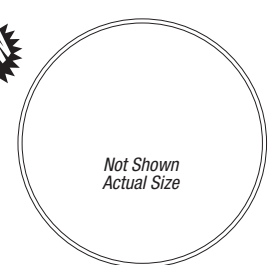

Also available by the Case (12 Bottles) - RPI Part #CML120