



New Parts to fit SciCan STATIM® 2000 & 5000 Cassette Autoclaves!

RPI Part #SCK059
OEM Part #01-101783S/
01-109300S (Filter only)



RESERVOIR CAP & FILTER

- Includes all parts as shown

Fits: Reservoir Assembly and Top Cover

Models: 2000 & 5000

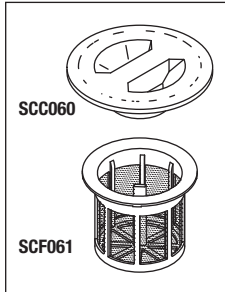

RPI Part #SCC060
OEM Part #01-101783S
 (Reservoir Cap & Filter)



RESERVOIR CAP

Fits: Top Cover

Models: 2000 & 5000



RPI Part #SCF061
OEM Part #01-109300S



FILTER

Fits: Reservoir Assembly

Models: 2000 & 5000

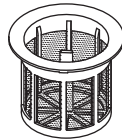

RPI Part #SCP050
OEM Part #01-100568S (Invensys Pump - STATIM 2000)/01-101761S (Invensys Pump - STATIM 5000)



PUMP KIT

- 120Volts, 60Hz.
- This Invensys brand pump will accommodate STATIM 2000 and 5000 with autoclave software R603 and older only
- Includes all parts as shown

Fits: Chassis

Models: 2000 & 5000

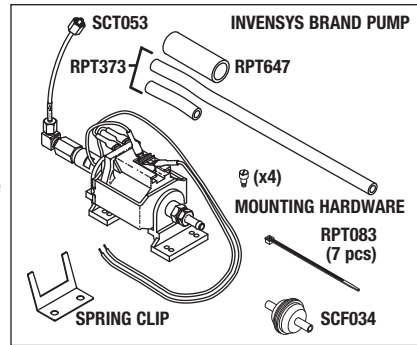

RPI Part #SCP051
OEM Part #01-110445S (Ulka Pump - STATIM 2000)/ 01-110446S (Ulka Pump - STATIM 5000)



PUMP KIT

- 120Volts, 60Hz.
- This Ulka brand pump will accommodate STATIM 2000 and 5000 with autoclave software R604 and above only
- Includes all parts as shown

Fits: Chassis

Models: 2000 & 5000

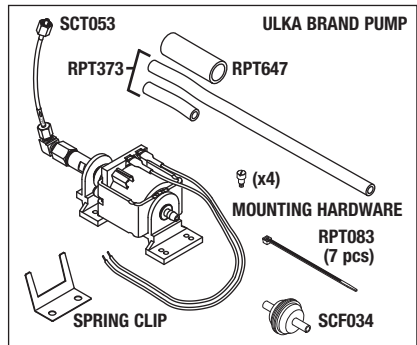

RPI Part #SCT053
OEM Part #01-108816S



METERING TUBE (290)

- Use as replacement pump tube or as pump recovery tube
- Size: 1/8" OD tubing x 5-1/2" lg.
- Also included in: Pump Kit (RPI Part #'s SCP050 & SCP051)

Fits: Pump to Boiler

Models: 2000 & 5000

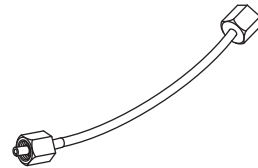

Upgrade your 2000 or 5000 with an RPI "Quick-Release Drain System"!

Upgrade the 2000!

RPI Part #SCK037
OEM Part #01-108152S (Kit)/01-106637S (Kit)

DRAIN KIT WITH PUMP FILTER

- Includes all parts as shown

Fits: From the Reservoir to the Pump Filter to the Pump to the Drain Line

Model: 2000

Upgrade the 5000!

To upgrade the 5000, just ask for these two RPI parts:

- RPI Part #RPF428 - FEMALE Q.C. FITTING
- RPI Part #RPK432 - DRAIN TUBING

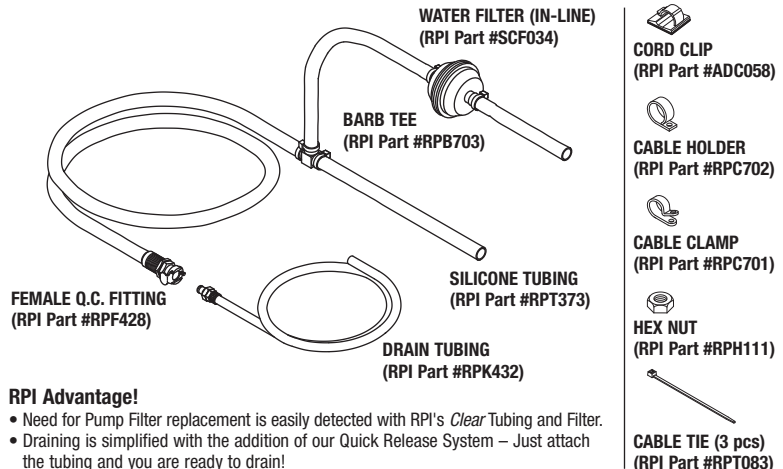

RPI Advantage!

- Need for Pump Filter replacement is easily detected with RPI's Clear Tubing and Filter.
- Draining is simplified with the addition of our Quick Release System – Just attach the tubing and you are ready to drain!



RPI Part #SCK038
OEM Part #01-100570S



PROBE BRACKET KIT

- Includes: (2 pcs) Compression Sleeve (RPI Part #RPF215), (2 pcs) Compression Nut (RPI Part #RPF219), (2 pcs) Copper Tubing, Probe Bracket (RPI Part #SCB039), Microswitch Kit (RPI Part #SCK007) & Thermocouple (RPI Part #SCT030)

Fits: Cassette Bay (Armature)
Model: 2000

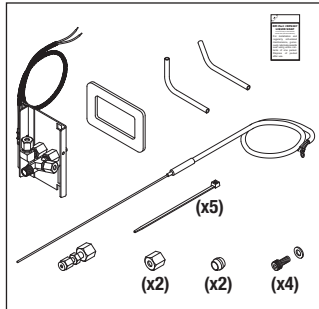

Also available: Alignment Tool (RPI Part #SCT052) & Hex Balldriver (9/64") (RPI Part #RPT836)

RPI Part #SCK042
OEM Part #01-101618S



PROBE BRACKET KIT

- Includes: (2 pcs) Compression Sleeve (RPI Part #RPF215), (2 pcs) Compression Nut (RPI Part #RPF219), (2 pcs) Copper Tubing, Probe Bracket (RPI Part #SCB043), Microswitch Kit (RPI Part #SCK007) & Thermocouple (RPI Part #SCT030)

Fits: Cassette Bay (Armature)
Model: 5000

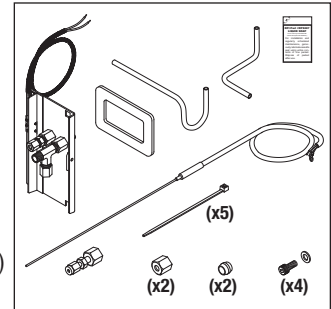

Also available: Alignment Tool (RPI Part #SCT052) & Hex Balldriver (9/64") (RPI Part #RPT836)

RPI Part #SCB039
OEM Part #01-100570S (Complete Assy)



PROBE BRACKET

- Probe Bracket allows replacement of damaged steam ports or spring bar without replacing the thermocouple and microswitch
- Includes all parts as shown
- Also available: Alignment Tool (RPI Part #SCT052) & Hex Balldriver (9/64") (RPI Part #RPT836)

Fits: Cassette Bay (Armature)
Model: 2000

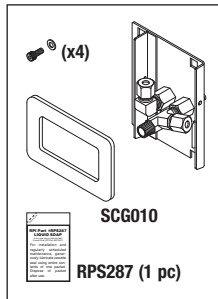

RPI Part #SCB043
OEM Part #01-101618S (Complete Assy)



PROBE BRACKET

- Probe Bracket allows replacement of damaged steam ports or spring bar without replacing the thermocouple and microswitch
- Includes all parts as shown
- Also available: Alignment Tool (RPI Part #SCT052) & Hex Balldriver (9/64") (RPI Part #RPT836)

Fits: Cassette Bay (Armature)
Model: 5000

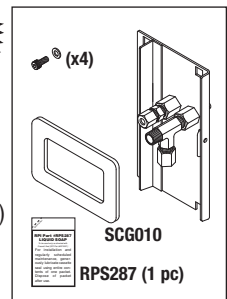

RPI Part #SCT030
OEM Part # (No OEM Part # Available)

THERMOCOUPLE

- Includes all parts as shown
- Fits:** Probe Bracket
Models: 2000 & 5000

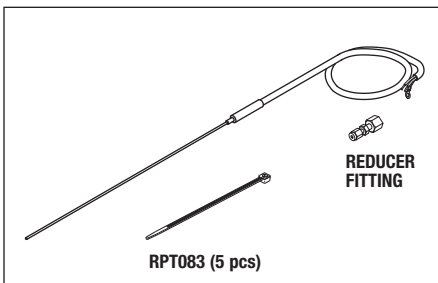

RPI Part #SCK007
OEM Part #01-100571S (2000)/01-101621S (5000)

MICROSWITCH KIT

- Includes all parts as shown; Also available: Hex Balldriver (5/64") (RPI Part #RPT297)
- Fits:** Probe Bracket
Models: 2000 & 5000

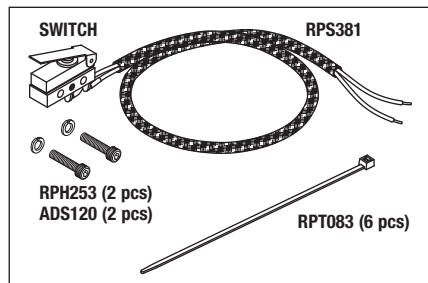

RPI Part #SCG010
OEM Part #01-100865S



PROBE BRACKET GASKET

- Size: ~2.19" x 3.38" x .12" Thk.
- Fits:** Cassette Bay (Armature)
Models: 2000 & 5000

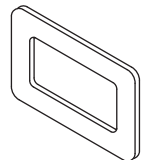

RPI Part #RPS639
OEM Part # (No OEM Part # Available)

SILICONE GASKET MAKER 598 (.5 fl. oz.)

- Material: RTV black silicone
 - Use to seal Microswitch to Probe Bracket
- Models:** 2000 & 5000

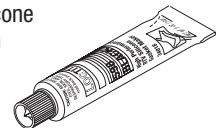

RPI Part #SCT052
OEM Part #01-106776S (Probe Alignment Jig)

ALIGNMENT TOOL

- Size: 1.50" x .31" x .25"
 - Also included in: RPI Field Service Smart Kit® (RPI Part #SCK028)
- Fits:** Cassette to Probe Bracket

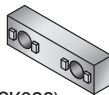

Easily align the Probe Bracket Steam Ports to Cassette

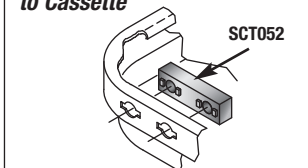

RPI Part #SCK048
OEM Part #01-109128S



COPPER TUBING KIT

- Includes all parts as shown
- Fits:** Probe Bracket to Boiler, Solenoid Valve and Alex Upgrade Kit
Model: 2000

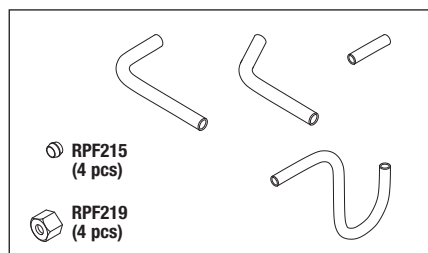

RPI Part #SCK049
OEM Part #01-109129S



COPPER TUBING KIT

- Includes all parts as shown
- Fits:** Probe Bracket to Boiler, Solenoid Valve and Alex Upgrade Kit
Model: 5000

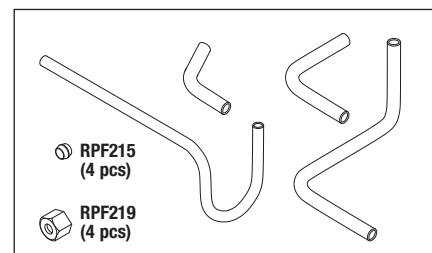



RPI Part #SCK062
OEM Part #01-104381S
 (Display only)/01-109494S
 (Display only)

LCD KIT

- Includes all parts as shown
- Fits:** Facia Cover
- Model:** 2000
- Model #121101

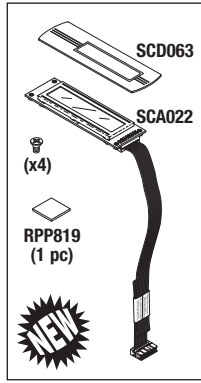

RPI Part #SCK040
OEM Part #01-109671S

KEYPAD

Model: 5000 Model #01-201103

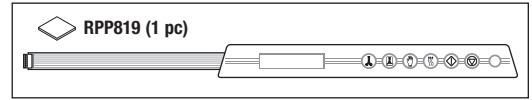

RPI Part #SCK041
OEM Part #01-109680S

KEYPAD

- 1 set of 2 pieces
- Model:** 2000 Model #121101
- (New type, two piece style)

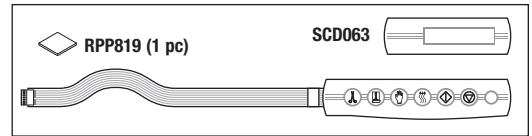

RPI Part #SCA022
OEM Part #01-104382S/
01-104381S (Display only)/
01-109494S (Display only)

DISPLAY ASSEMBLY

- Can be used in all versions of the STATIM 2000 and 5000.
- Includes all parts as shown
- Fits:** Facia Cover
- Models:** 2000 & 5000

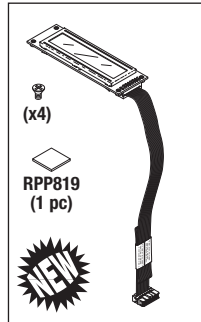

RPI Part #SCK015
OEM Part #01-101707S

KEYPAD

Model: 2000 Model #101102 (Old type, one piece style with S/N's ending with an "A")

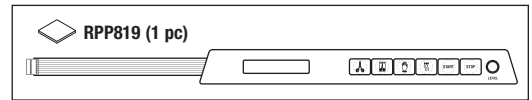

RPI Part #SCK011
OEM Part #01-100574S/01-101627S

CHECK VALVE KIT

- Includes all parts as shown
- Fits:** Steam Generator/Boiler to the Air Compressor
- Models:** 2000 & 5000

Service Tip: The OEM recommends replacing the Check Valve every 2 years

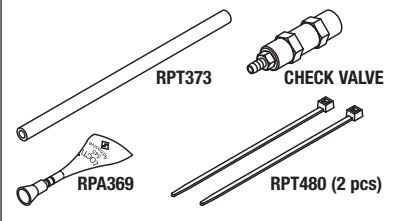

RPI Part #SCF006
OEM Part #01-104461S/10-106462S

DOUBLE THERMAL FUSE ASSEMBLY

- Includes all parts as shown
- Can be used on single fused steam generator/boilers
- Fits:** Steam Generator/Boiler
- Models:** 900, 2000 & 5000

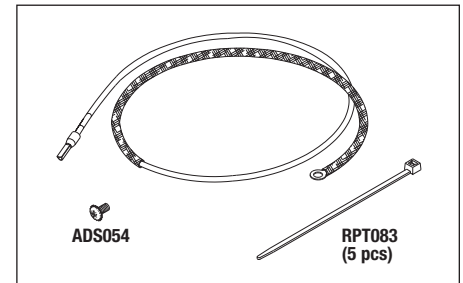

RPI Part #SCD063
OEM Part #01-106950S

LCD DECAL

Fits: Facia Cover
Model: 2000 Model #121101

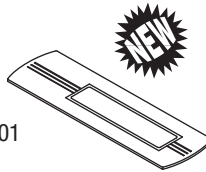

RPI Part #RPP819
OEM Part # (No OEM Part # Available)

MOUNTING PAD - 10/PKG

- Size: 3/4" x 3/4" x 1/16" Thk.
- Double-sided adhesive foam – Attaches the keypad ribbon cable to display ribbon cable making it easier to install top cover!
- Models:** 2000 & 5000

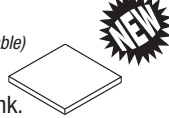

RPI Part #SCG044
OEM Part #01-101650S

FACIA GASKET

- Size: ~4.35" x 8.81"
- Fits:** Facia Cover
- Model:** 5000

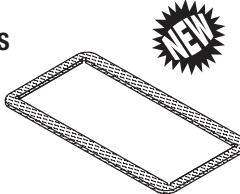

RPI Part #RPH817
OEM Part # (No OEM Part # Available)

SCREW (#8-32 x .500 SEMS)

- 25 per package
- Size: #8-32 x 1/2" lg. with captive external lockwasher
- Fits:** Cover, Solenoid Valve Mounting Bracket, Steam Generator/Boiler to Bracket, STATIM 5000 Air Compressor Mounting Bracket and Rear Foot
- Models:** 2000 & 5000



RPI Part #CAF011
OEM Part # (No OEM Part # Available)

RUBBER FOOT - 4/PKG

- Material: Black rubber with molded in steel washer
- Fits:** Base Plate
- Models:** 2000 & 5000



HOOK UP WIRE (sold by the foot) - Models: 900, 2000 & 5000

| RPI PART # | DESCRIPTION | AWG | VOLTAGE RATING | INSULATION | MAX TEMP |
|------------|------------------------|-----|----------------|------------|----------|
| RPW382* | Hook Up Wire (Black) | #14 | 600V | Polyolefin | 257°F |
| RPW805* | Hook Up Wire (White) | #14 | 600V | Polyolefin | 257°F |
| RPW806* | Hook Up Wire (Grn/Yel) | #14 | 600V | Polyolefin | 257°F |
| RPW813 | Hook Up Wire (Black) | #22 | 600V | PVC | 221°F |
| RPW814 | Hook Up Wire (White) | #22 | 600V | PVC | 221°F |
| RPW815 | Hook Up Wire (Grn/Yel) | #22 | 600V | PVC | 221°F |

* Non-Teflon®

RPI Part #RPT647
OEM Part # (No OEM Part # Available)

TUBING (CLEAR 1/2" ID x 11/16" OD - PVC)

- Sold by the foot (reel NOT included)
- Fits:** 2000 Pumps; and 5000 Medo Air Compressor and Filter (RPI Part #SCF031)
- Models:** 2000 & 5000

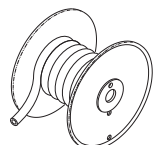



ADDRESS SERVICES REQUESTED

RPI Part #SCT052
OEM Part #01-106776S
(Probe Alignment Jig)



ALIGNMENT TOOL

- Size: 1.50" x .31" x .25"
- Fits:** Cassette to Probe Bracket
- Models:** 2000 & 5000

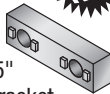

RPI Part #RPT836
OEM Part # (No OEM Part # Available)

HEX BALLDRIVER (9/64")



- 9/64" Ball-Point Hex Driver
- Size: ~10.50" lg. with plastic handle; ~6.90" lg. alloy steel blade
- Easily access OEM or RPI probe bracket mounting screws for adjustment or replacement without removing other components.

Models: 2000 & 5000

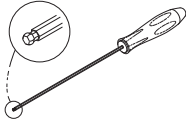

RPI Part #RPT820
OEM Part #01-103139S



WATER QUALITY TESTER

- Size: 5.9" x 1.2" x 0.8"
- Also available: Calibration Solution (RPI Part #RPS821)

Models: 2000 & 5000

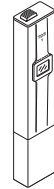

RPI Part #RPS821
OEM Part # (No OEM Part # Available)



CALIBRATION SOLUTION

- 4 pouches per package (20ml pouches); Use to verify calibration of Water Quality Tester (RPI Part #RPT820)

Models: 2000 & 5000



RPI Part #SCK028
OEM Part # (No OEM Part # Available)

FIELD SERVICE SMART KIT®



Includes the New Parts shown above and a New Guide!

- This exclusive Kit includes the most often utilized instruments for servicing and repairing Scican STATIM Cassette Autoclaves Models 2000 and 5000. Plus, this Kit includes RPI's *A Guide to Maintaining the SciCan STATIM Cassette Autoclave*, an essential booklet offering troubleshooting and service tips, error code descriptions, detailed exploded views and more!
- Includes RPI's new maintenance Guide plus:
 - Alignment Tool (RPI Part #SCT052)
 - Calibration Solution (1 pouch) (RPI Part #RPS821)
 - Carrying Case (RPI Part #RPC476)
 - Cassette Seal Removal Tool (RPI Part #RPT372)
 - Extension Test Cable (RPI Part #SCT026)
 - Hex Balldriver (5/64") (RPI Part #RPT297)
 - Hex Balldriver (9/64") (RPI Part #RPT836)
 - Liquid Soap (RPI Part #RPS287)
 - Pump Tester Bottle Kit (RPI Part #SCK024)
 - Spanner Nut (RPI Part #RPT364)
 - Start Switch (RPI Part #SCS021)
 - Threadlocker 545 (RPI Part #RPA369)
 - Water Quality Tester (RPI Part #RPT820)

Models: 2000 & 5000

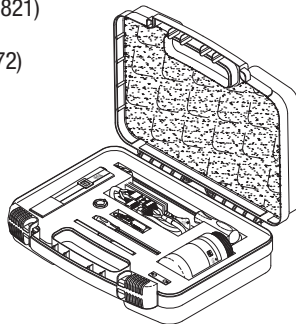

All Parts Also Sold Separately!

RPI Part #SCA046
OEM Part #80ZPLUS (Stat-Dri Plus™)/ 320ZPLUS (Stat-Dri Plus™)

SCI-DRY™ (16 oz. REFILL)

- Drying and rinse agent
- Also available by the case of 12 bottles! Just ask for SCI-DRY™ (16 oz. Refill - Case) (RPI Part #SCA047)

Models: 2000, 5000 & 7000 series cassette sterilizers; and Hydrim® series washers



RPI Part #SCA054
OEM Part #20ZPLUS (Stat-Dri Plus™)/ 80ZPLUST (Stat-Dri Plus™)

SCI-DRY™ (2 oz. spray bottle)

- Drying and rinse agent
- Also available by the case of 12 bottles! Just ask for SCI-DRY™ (2 oz. - Case) (RPI Part #SCA055)

Models: 2000, 5000 & 7000 series cassette sterilizers



RPI Part #RPK791
OEM Part # (No OEM Part # Available)

CLEANING KIT

- Includes all parts as shown
- All items also sold separately

