

Parts to fit Stryker 900 Series Cast Cutters!

RPI Part #STB043
OEM Part #940-25

CAST CUTTER BLADE

- For plaster casts
- Size: 2.36" oval blade
- Material: Stainless steel
- Also available: Cast Cutter Blade (TiN) (RPI Part #STB045) and Blade Guard (RPI Part #STG042)

Fits: Head Assembly
Models: 940 & 941

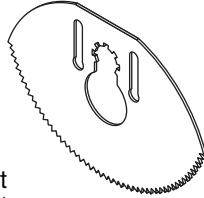

For Plaster Casts!

RPI Part #STB045
OEM Part #940-35

CAST CUTTER BLADE (TiN)

- For both plaster and synthetic casts
- Size: 2.36" oval blade
- Material: Titanium nitride coated stainless steel
- Also available: Cast Cutter Blade (RPI Part #STB043) and Blade Guard (RPI Part #STG042)

Fits: Head Assembly
Models: 940 & 941

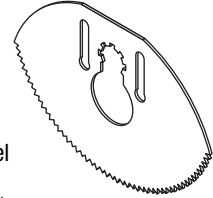

For Synthetic & Plaster Casts!

RPI Part #STG042
OEM Part #940-1-134

BLADE GUARD

- Fits: 2.36" oval blade
- Material: Clear plastic
- Includes: Mounting hardware
- Also available: Cast Cutter Blade (RPI Part #STB043) and Cast Cutter Blade (TiN) (RPI Part #STB045)

Fits: Head Assembly
Models: 940 & 941

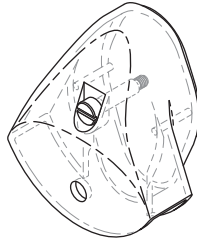

RPI Part #STF044
OEM Part #986-500

CARTRIDGE FILTER

- 11 micron
- Size: 7.00" dia. x 11.38" lg.
- Includes: Filter with O-Ring

Fits: Vacuum Canister
Models: 986

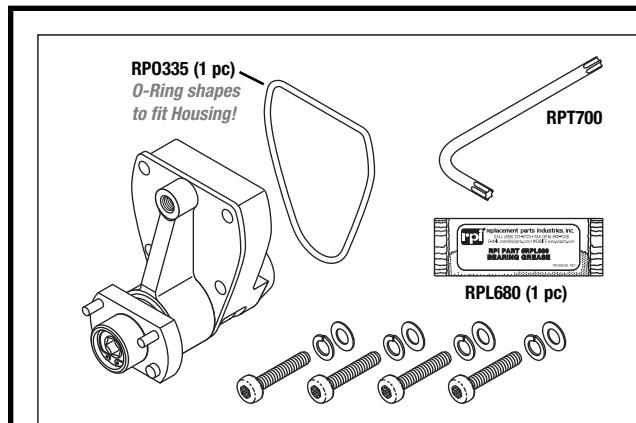
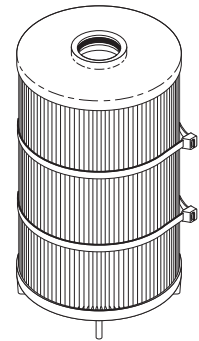

RPI Part #STA040
OEM Part #12-24, 21-129, 45-29, 50-33, 940-1-115, 940-1-118, 940-1-125

OUTPUT DRIVE ASSEMBLY

- Includes: (1 pc) O-ring (RPI Part #RPO335), (1 pc) Bearing Grease (RPI Part #RPL680), T-15 Torx Wrench (RPI Part #RPT700) and hardware. Also includes Shaft Link (RPI Part #STL016) and (1 pc) Retaining Clip (RPI Part #PHC015) already installed
- Material: Anodized aluminum housing; Hardened steel shaft and shaft link

Fits: Cast Cutter Housing
Models: 940 & 941

RPI Part #RPO335
OEM Part #45-29

O-RING

- 12 per package
- Material: Nitrile (Buna N), Duro:70
- 1.489" ID x 1.629" OD x .070" C/S

Fits: Output Drive Assembly
Models: 940 & 941



RPI Part #RPL680
OEM Part # (No OEM Part # Available)

BEARING GREASE

- 5 per package; 0.068 fl. oz. per unit
- Material: Mobilith SHC100; Red synthetic grease

Fits: Head Assembly, Shaft Link
Models: 940 & 941



RPI Part #RPT700
OEM Part # (No OEM Part # Available)

T-15 TORX WRENCH

- Material: Steel; • Size: T-15 x 2-1/8" lg.

Fits: Output Housing Hardware
Models: 940 & 941

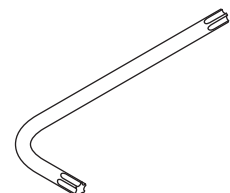

replacement parts industries, inc.

CALL (800) 221-9723 • FAX (818) 882-7028 • EMAIL order@ripiparts.com • WEBSITE www.ripiparts.com

The above parts are manufactured by Replacement Parts Industries, Inc. to fit the equipment noted. All product names used in this document are trademarks or registered trademarks of their respective holders. 1904AM Show 01/21

RPI Part #STA028

OEM Part # (No OEM Part # Available)

ARMATURE ASSEMBLY (115VAC)

- 115 VAC
- Includes all parts as shown

Models: 940

RPI Part #STK033

OEM Part # (No OEM Part # Available)

ARMATURE WASHER KIT

- Material: Stainless steel
- .195" ID x .245" OD
- Includes flat washer and wave washer

Fits: Armature

Models: 940 & 941

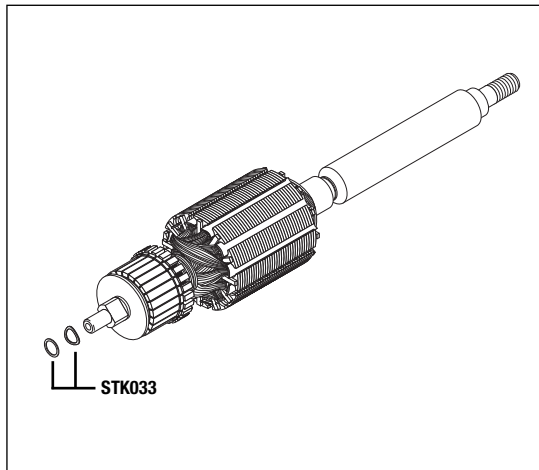

RPI Part #STB002

OEM Part #940-1-113 (Brush only) & 38-49 (Spring only)

BRUSH

- 2 per package
- Size: 3/16" x 3/16" x 1/2" lg
- Spring length: 1.000"

Fits: Brush Holder Assembly

Models: 940 & 941

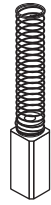

Also fits 800 Series!

RPI Part #RPC667

OEM Part #58-18

BRUSH CAP

- 6 per package; 7/16-24 thread

Models: 940 & 941



RPI Part #STB031

OEM Part # (No OEM Part # Available)

FRONT BEARING

- Material: Stainless steel
- .2500" ID x .6250" OD x .1960" Wide
- Factory greased; Double shielded

Models: 940 & 941



RPI Part #STK030

OEM Part #28-111 (Retaining Ring only), 11-275 (Washers only), 81-118/81-147 (Needle Bearing only)

ROLLER BEARING KIT

Includes: Needle Bearing (RPI Part #STB004), retaining ring, and (2) washer

Models: 940 & 941

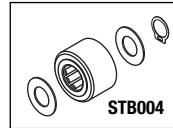

RPI Part #STB032

OEM Part # (No OEM Part # Available)

REAR BEARING

- Material: Stainless steel
- .1875" ID x .5000" OD x .1960" Wide
- Factory greased; Double shielded

Models: 940 & 941



RPI Part #STB004

OEM Part #81-118/81-147

NEEDLE BEARING

- Hardened steel outer race
- .1575" ID x .4063" OD x .2570" wide
- Included in: Roller Bearing Kit (RPI Part #STK030)

Fits: Cam

Models: 940 & 941

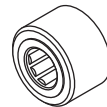

Also fits 800 Series!

RPI Part #STB039

OEM Part # (No OEM Part # Available)

POWER SUPPLY PCB

- 115VAC
- Also available: Fuse (RPI Part #RPF665)

Fits: Power Supply Module

Models: 940

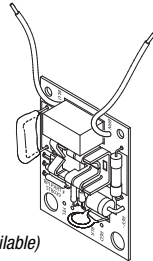

RPI Part #RPF665

OEM Part #

(No OEM Part # Available)

AXIAL LEAD FUSE (2-1/2A)

- 5 per package
- Amps: 2-1/2A; Volts: 250V
- Type: 2AG glass; Time Delay
- .20" dia. x .58" lg. body x 1.50" lg. leads

Fits: Power Supply Module

Models: 940

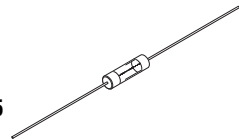

RPI Part #STT010

OEM Part # (No OEM Part # Available)

CAM TOOL

- Use to install and remove Cam (RPI Part #STC029 & STC009)
- 3/4" dia. x 2" lg.
- Material: Stainless steel

Models: 940 & 941

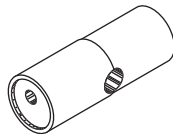

Can be used with 800 & 900 Series!

RPI Part #STC029

OEM Part # (No OEM Part # Available)

CAM

- Material: Hardened steel
- Includes: Retaining ring
- For ease of installation and removal use Cam Tool (RPI Part #STT010)

Models: 940 & 941

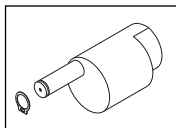

RPI Part #STL016

OEM Part # (No OEM Part # Available)

SHAFT LINK

- Material: Hardened steel
- Presses onto shaft
- Included in: Output Drive Assembly (RPI Part #STA040)
- Also available: Retaining Clip (RPI Part #PHC015)

Models: 940 & 941

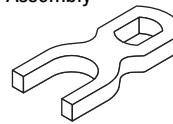

Can be used with 800 & 900 Series!

RPI Part #PHC015

OEM Part # (No OEM Part # Available)

RETAINING CLIP

- 5 per package
- Material: Stainless steel; 1/4" ID
- Included in: Output Drive Assembly (RPI Part #STA040)
- Also available: Shaft Link (RPI Part #STL016)

Models: 940 & 941

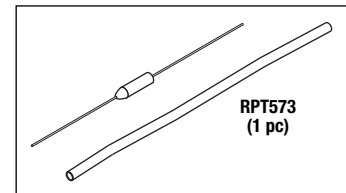

RPT573 (1 pc)

RPI Part #STF036

OEM Part # (No OEM Part # Available)

THERMAL FUSE (104°C)

- Opens at 104°C
- Includes (1 piece) Heat Shrink Tubing (RPI Part #RPT573)

Models: 940 & 941

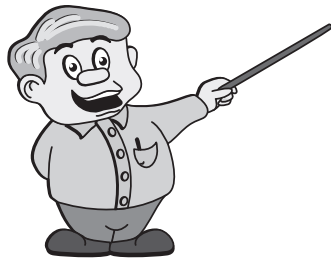

Did You Know ...

To access the housing for the Stryker 900 series cast cutters, simply remove the screws located under the Power Switch Label and cap.

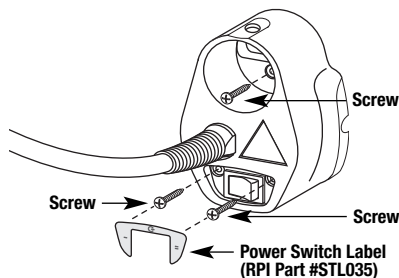

RPI Part #STS034
OEM Part #
(No OEM Part # Available)

POWER SWITCH

- SPDT
- 6A @ 125-250VAC
- 1/4" tabs
- Center Off rocker - Black
- Includes (1 pc) Heat Shrink Tubing (RPI Part #RPT573) and (1 pc) Power Switch Label (RPI Part # STL035)
- Use Adhesive (RTV108) (RPI Part #RPA874) to seal switch connections

Models: 940 & 941

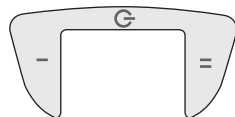
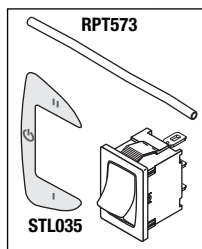

RPI Part #STL035
OEM Part # *(No OEM Part # Available)*

POWER SWITCH LABEL

- 3 per package
- Grey polycarbonate with adhesive backing
- Use to cover case screws

Models: 940 & 941

Perfect for sealing Power Switch connections!

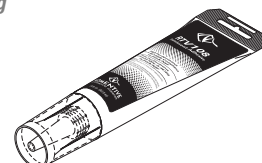

RPI Part #RPA874
OEM Part # *(No OEM Part # Available)*

ADHESIVE (RTV108)

- Size: 2.8 fl. oz. tube
- Translucent silicone adhesive/sealant
- Temperature Range: -75°F to +400°F
- Can be used to seal power switch connections

Models: 940 & 941

RPI Part #STK037
OEM Part # *(No OEM Part # Available)*

POWER CABLE KIT

- Includes (1 pc) 10' prestripped and tinned Cable (RPI Part #RPC671), Heat Shrink Tubing (RPI Part #RPT573), (2 pcs) Cable Tie (RPI Part #RPT083), and (2 pcs) Strain Relief Bushing (RPI Part #STB038) as shown

Models: 940 & 941

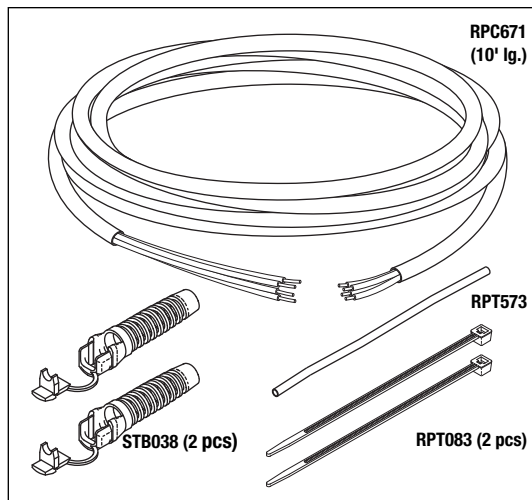

RPI Part #RPC671
OEM Part # *(No OEM Part # Available)*

CABLE (4 CONDUCTOR)

- 4 conductor #20 AWG 19/32
- Colors: Black, red, green, and yellow
- White PVC jacket, UL 2464, 221°F (105°C), 300V
- .25" OD cord
- Sold by the foot (reel not included)

Models: 940 & 941

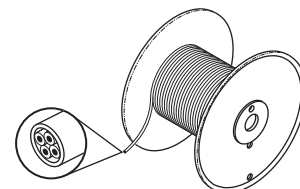

RPI Part #STB038
OEM Part # *(No OEM Part # Available)*

STRAIN RELIEF BUSHING

- 5 per package
- Type: SR-5P-7; Material: white Nylon®
- Cord type: round cable
- Cord OD range: .250" - .290"
- Mounting hole: 1/2"
- Also available: Strain Relief Bushing Pliers (RPI Part #RPT172)

Models: 940 & 941

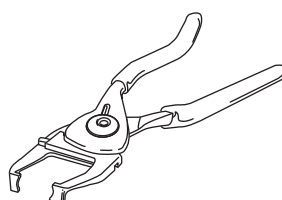
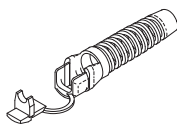

RPI Part #RPT172
OEM Part # *(No OEM Part # Available)*

STRAIN RELIEF BUSHING PLIERS

- Hand pliers adjustable for all bushings that assemble into mounting hole up to 7/8" dia.
- Size: 7" lg.

Models: 940 & 941

Service Tip
Perfect for strapping the Power Cord to the Vacuum Hose!

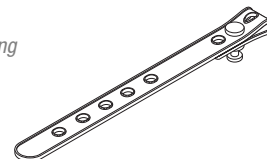

RPI Part #RPS672
OEM Part # *(No OEM Part # Available)*

CORD STRAP (WHITE 6")

- 3 per package
- 1/2" wide x 6" lg.
- EPDM
- White strap with white button

Models: 940 & 941

RPI has New Parts to fit Stryker 900 Series Cast Cutters!

For Plaster Casts!

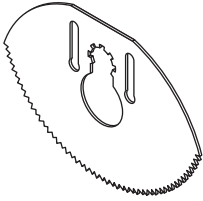

RPI Part #STB043
OEM Part #940-25

CAST CUTTER BLADE
Models: 940 & 941

For Synthetic & Plaster Casts!

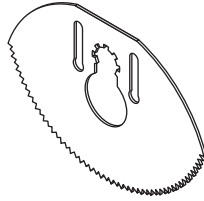

RPI Part #STB045
OEM Part #940-35

CAST CUTTER BLADE (TiN)
Models: 940 & 941

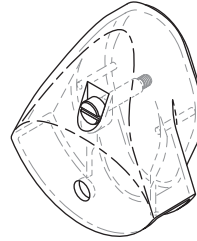

RPI Part #STG042
OEM Part #940-1-134

BLADE GUARD
Models: 940 & 941

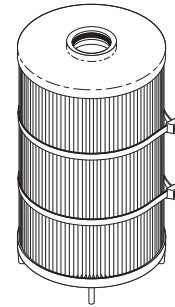

RPI Part #STF044
OEM Part #986-500

CARTRIDGE FILTER
Models: 986

New Parts to fit Stryker 900 Series Cast Cutters!

ADDRESS SERVICES REQUESTED

rpi!
replacement parts industries, inc.
625 Cochran Street • Simi Valley, California • 93065

PERMITTED STANDARD
U.S. POSTAGE PAID
VAN NUYS, CA
PERMIT NO. 2399

Don't forget ... RPI also has parts to fit Stryker 800 Series Autopsy Saws, Cast Cutters and Vacuums!

