

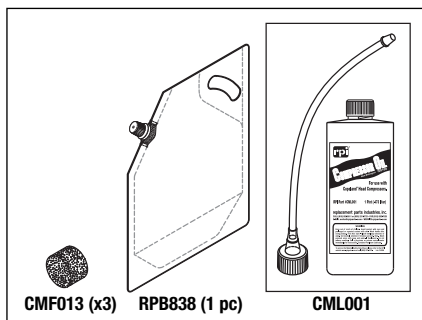

New PM Kits and More to fit Dental Compressors!

MATRIX/MIDMARK®



RPI Part #CMK266
OEM Part # (No OEM Part # Available)

COMPRESSOR PM KIT

- For lubricated single headed Copeland® compressors
- Includes: (3) Foam Element (RPI Part #CMF013), (1) Compressor Oil (RPI Part #CML001), (1 pc) Disposal Bag (RPI Part #RPB838), PM Sticker and PM Checklist; All parts also sold separately
- See **It's the RPI Advantage!** below

Models: AC-075, AC-100 & AC-101

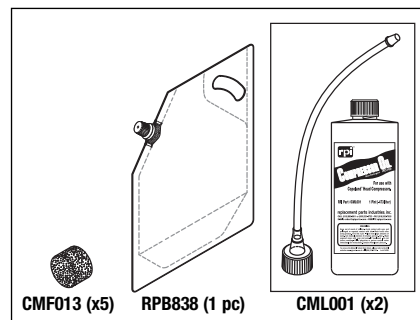

RPI Part #CMK267
OEM Part # (No OEM Part # Available)

COMPRESSOR PM KIT

- For lubricated dual headed Copeland® compressors
- Includes: (5) Foam Element (RPI Part #CMF013), (2) Compressor Oil (RPI Part #CML001), (1 pc) Disposal Bag (RPI Part #RPB838), PM Sticker and PM Checklist; All parts also sold separately
- See **It's the RPI Advantage!** below

Models: AC-100-2

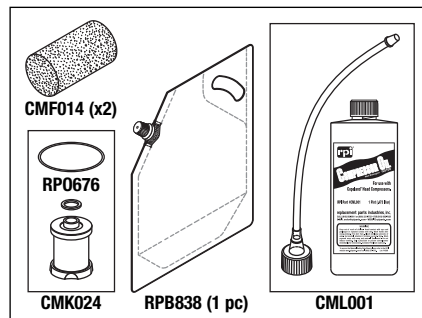

RPI Part #CMK268
OEM Part # (No OEM Part # Available)

COMPRESSOR PM KIT

- For lubricated single headed Copeland® compressors
- Includes: (1) Coalescing Filter Element (RPI Part #CMK024), (2) Foam Element (RPI Part #CMF014), (1) Compressor Oil (RPI Part #CML001), (1 pc) Disposal Bag (RPI Part #RPB838), PM Sticker and PM Checklist; All parts also sold separately
- See **It's the RPI Advantage!** below

Models: ACD-075, ACD-100 & ACD-101

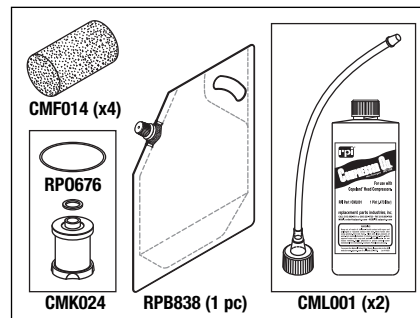

RPI Part #CMK269
OEM Part # (No OEM Part # Available)

COMPRESSOR PM KIT

- For lubricated dual headed Copeland® compressors
- Includes: (1) Coalescing Filter Element (RPI Part #CMK024), (4) Foam Element (RPI Part #CMF014), (2) Compressor Oil (RPI Part #CML001), (1 pc) Disposal Bag (RPI Part #RPB838), PM Sticker and PM Checklist; All parts also sold separately
- See **It's the RPI Advantage!** below

Models: ACD-100-2

It's the RPI Advantage! Included in this Kit are a PM Sticker that can be attached to the compressor for recording the date that the filters and compressor oil were replaced; as well as a one gallon clear plastic bag with cap, built in handle, and expandable base that can be used to easily collect and dispose of used oil.

More PM Kits to fit Matrix/Midmark® inside!



replacement parts industries, inc.

CALL (800) 221-9723 • FAX (818) 882-7028 • EMAIL order@riparts.com • WEBSITE www.riparts.com

The above parts are manufactured by Replacement Parts Industries, Inc. to fit the equipment noted. All product names used in this document are trademarks or registered trademarks of their respective holders. Show 07/19

APOLLO/MIDMARK®

NEW Fits Scroll Style Compressors

RPI Part #CMK280
OEM Part #PFM50950
(rectangular-style)

AIR INTAKE UPGRADE KIT

- **Important!** See **Notes** below
 - Includes: Air Filter Assembly (RPI Part #CMA289), PM Sticker, mounting bracket, gasket, and mounting hardware
- Fits:** Compressor Head
Models: Apollo/Midmark: AOCOS52 & AOCOS52D;
Midmark: S52

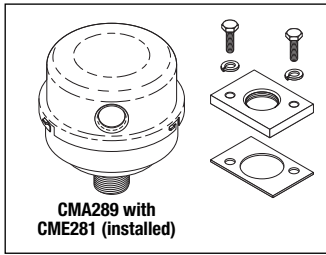

Notes: This Kit allows for the older, discontinued OEM rectangular-style Air Intake Filter Assembly to be converted to the newer round-shaped style assembly.

RPI Part #CMA289
OEM Part #
(No OEM Part # Available)

Fits Scroll Style Compressors

NEW

AIR FILTER ASSEMBLY

- **Important!** See **Notes** below
 - Port: 3/4" MPT; • 2 Microns
 - Includes: Air Intake Filter Element (RPI Part #CME281) and PM Sticker
 - Included in: Air Intake Upgrade Kit (RPI Part #CMK280)
- Fits:** Air Intake Manifold
Models: Apollo/Midmark: AOCOS52 & AOCOS52D;
Midmark: S52

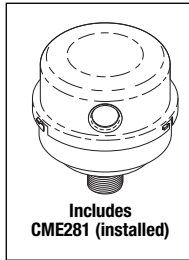

Notes: This Air Filter Assembly is only a replacement for the newer round-shaped style Air Intake Filter Assembly.

This Assembly is not to be used with the older discontinued rectangular-style Air Intake Filter Assembly. To convert from the older style assembly to the newer round-shaped style assembly, see RPI's Air Intake Upgrade Kit (RPI Part #CMK280).

RPI Part #CME281
OEM Part #PFM50950
(rectangular-style)

Fits Scroll Style Compressors

NEW

AIR INTAKE FILTER ELEMENT

- **Important!** See **Notes** below
 - 2 Microns; • Size: 4.12" OD x 4.50" lg.
 - Included in: Compressor PM Kit (RPI Part #CMK274), Compressor PM & Tip Seal Kit (RPI Part #CMK286), and Air Filter Assembly (RPI Part #CMA289)
- Fits:** Upgraded Air Intake Filter Assembly
Models: Apollo/Midmark: AOCOS52, AOCOS52D & S52;
Midmark: S52



Notes: This element fits only the newer round-shaped style Air Intake Filter Assembly.

This element is not to be used with the older discontinued rectangular-style Air Intake Filter Assembly. To convert from the older style assembly to the newer round-shaped style assembly, see RPI's Air Intake Upgrade Kit (RPI Part #CMK280).

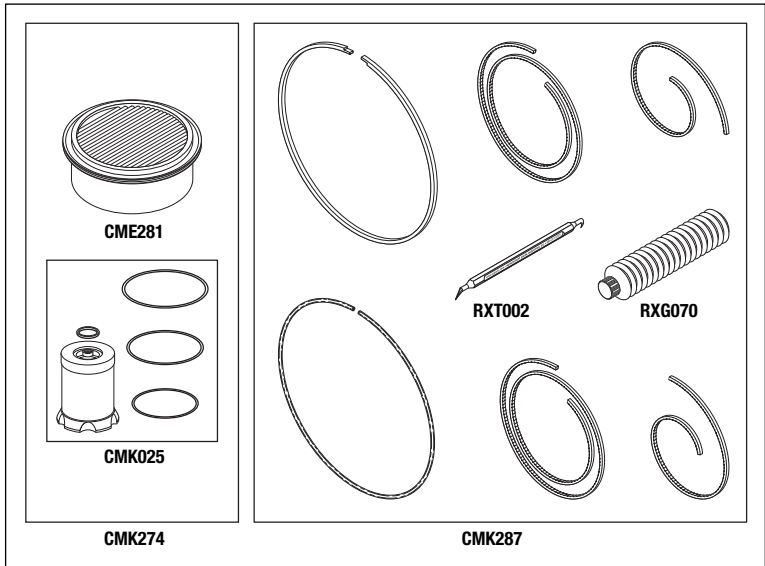

RPI Part #CMK286
OEM Part #ACA85416

NEW

Fits Scroll Style Compressors

COMPRESSOR PM & TIP SEAL KIT

- **Important!** See **Notes** below
- For oil-less single headed, belt driven compressors
- OEM recommends replacement every 5,000 hours
- Includes: Compressor PM Kit (RPI Part #CMK274) and Compressor Tip Seal Kit (RPI Part #CMK287), PM Sticker and PM Checklist; All parts also sold separately
- Also available: Air Intake Upgrade Kit (RPI Part #CMK280), Drive Belt (RPI Part #CMB279), Belt Tension Tester (RPI Part #RPT954), and Grease Gun Kit (RPI Part #RXK069)

Models: Apollo/Midmark: AOCOS52 & AOCOS52D; **Midmark:** S52

Notes: This Kit only fits compressors that have been converted to the newer round-shaped style Air Intake Filter Assembly.

This Kit is not to be used on compressors with the older discontinued rectangular-style Air Intake Filter Assembly. To convert from the older style assembly to the newer round-shaped style assembly, use RPI's Air Intake Upgrade Kit (RPI Part #CMK280).

RPI Part #CMK274
OEM Part #ACA85415

NEW

Fits Scroll Style Compressors

COMPRESSOR PM KIT

- **Important!** See **Notes** below
- For oil-less single headed, belt driven compressors
- Includes: (1) Coalescing Filter Element (RPI Part #CMK025), (1) Air Intake Filter Element (RPI Part #CME281), PM Sticker and PM Checklist; All parts also sold separately
- Included in: Compressor PM & Tip Seal Kit (RPI Part #CMK286)
- Also available: Air Intake Upgrade Kit (RPI Part #CMK280), Drive Belt (RPI Part #CMB279), and Compressor Tip Seal Kit (RPI Part #CMK287)

Models: Apollo/Midmark: AOCOS52 & AOCOS52D;
Midmark: S52

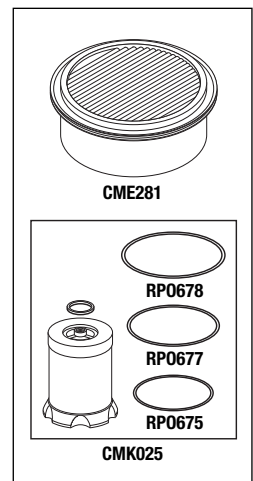

Notes: This Kit only fits compressors that have been converted to the newer round-shaped style Air Intake Filter Assembly.

This Kit is not to be used on compressors with the older discontinued rectangular-style Air Intake Filter Assembly. To convert from the older style assembly to the newer round-shaped style assembly, use RPI's Air Intake Upgrade Kit (RPI Part #CMK280).

NEW Fits Scroll Style Compressors

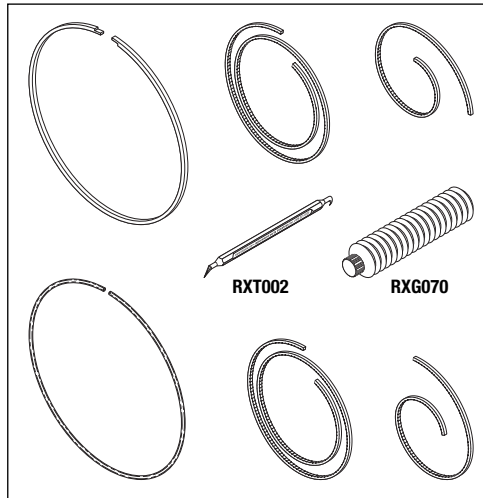

RPI Part #CMK287
OEM Part #HPA30505

COMPRESSOR TIP SEAL KIT

- For oil-less single headed, belt driven compressors
- OEM recommends replacement every 5,000 hours
- Includes all parts as shown
- Included in: Compressor PM & Tip Seal Kit (RPI Part #CMK286)
- Also available: Compressor PM Kit (RPI Part #CMK274), Air Intake Upgrade Kit (RPI Part #CMK280), Drive Belt (RPI Part #CMB279), Belt Tension Tester (RPI Part #RPT954), and Grease Gun Kit (RPI Part #RXK069)

Fits: Compressor Head

Models: Apollo/Midmark: AOCOS52 & AOCOS52D; Midmark: S52

NEW Fits Scroll Style Compressors

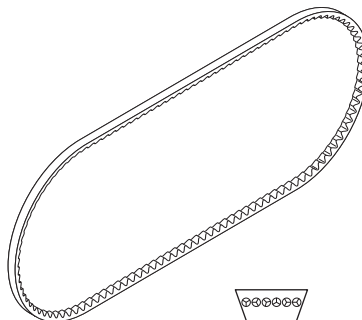

CMB279
CROSS SECTION
SHOWN ACTUAL SIZE

RPI Part #CMB279
OEM Part #MMS73500

DRIVE BELT

- V Belt
- Effective Belt Length: 45.0"
- Size: .37" at top x .31" thk
- Also available: Belt Tension Tester (RPI Part #RPT954)

Fits: Motor and Compressor Pump

Models: Apollo/Midmark: AOCOS52 & AOCOS52D;

Midmark: S52

NEW Fits Scroll Style Compressors

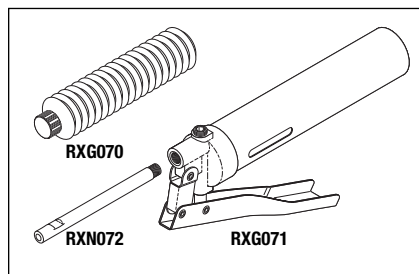

RPI Part #RXK069
OEM Part #HPA30530

GREASE GUN KIT

- OEM recommends regreasing of compressor head and motor bearings every 5,000 hours
- Includes: Grease Gun (RPI Part #RXG071), Grease Gun Nozzle (RPI Part #RXN072), Grease Cartridge (RPI Part #RXG070)
- Used to grease the bearings in the scroll compressor head.

Fits: Scroll Compressor Head

Models: Apollo/Midmark: AOCOS52 & AOCOS52D; Midmark: S52

NEW

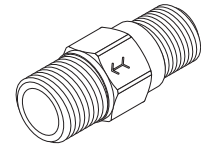

RPI Part #CMV283
OEM Part #PVV50515

CHECK VALVE

- Cracking Pressure: 1-5 psi
- Ports: 3/8" MPT Inlet x 3/8" MPT Outlet
- Material: Brass Body; Buna-N Seal
- Size: 11/16" Hex x 1.70" lg.

Fits: Cluster Assembly

Models: Apollo/Midmark: AOCOS52, AOCOS52D, ALCQL82, ALCQL82D, ALCRL62, ALCRL62D, ALCSL11, ALCSL11D, ALCSL12, ALCSL12D, ALCSL21, ALCSL21D, ALCSL22, ALCSL22D, ALCTL31, ALCTL31D, ALCTL32, ALCTL32D, ALCTL42, ALCTL42D, AOCOS11, AOCOS11D, AOCOS12, AOCOS12D, AOCOS21, AOCOS21D, AOCOS22, AOCOS22D, AOCOS21, AOCOS31D, AOCOS32, AOCOS32D, AOCOS42, AOCOS42D, AOCOT32, AOCOT32T, AOCOT42, AOCOT42D, AOCOT62, AOCOT62D, AOCOT82, AOCOT82D, AOCOS11, AOCOS12, AOCRT21Q, AOCRT21DQ, AOCRT22Q, AOCRT22DQ; Midmark: R22 & R42

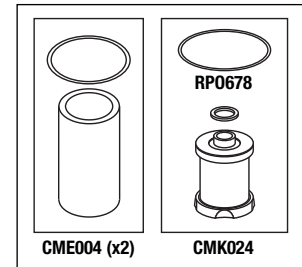

RPI Part #CMK170
OEM Part #ACA85403 & ACA85417

COMPRESSOR PM KIT

- For oil-less dual headed compressors
 - Includes: (1) Coalescing Filter Element (RPI Part #CMK024), (2) Replacement Filter Element (RPI Part #CME004), PM Sticker and PM Checklist; All parts also sold separately
 - Also available: Fresh Air Intake Filter Kit (RPI Part #CMK003)
- Models:** AOCOS11, AOCOS11D, AOCOS11DQ, AOCOS11Q, AOCOS12, AOCOS12D, AOCOS12DQ, AOCOS12Q, AOCOS21, AOCOS21D, AOCOS21DQ, AOCOS21Q, AOCOS22, AOCOS22D, AOCOS22DQ, AOCOS22Q, AOCTR21Q, AOCTR21DQ, AOCTR22Q, AOCTR22DQ & R22 (Fits R22 with 10 gallon tank only)

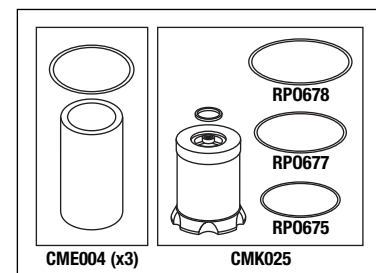

RPI Part #CMK273
OEM Part #ACA85418

COMPRESSOR PM KIT

- For oil-less triple headed compressors
 - Includes: (3) Replacement Filter Element (RPI Part #CME004), (1) Coalescing Filter Element (RPI Part #CMK025), PM Sticker and PM Checklist; All parts also sold separately
 - Also available: Fresh Air Intake Filter Kit (RPI Part #CMK003)
- Models:** R42 & R22 (Fits R22 with 20, 30, or 40 gallon tank only)

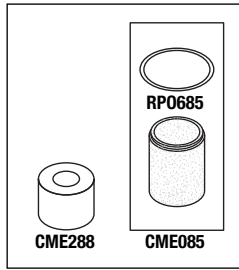

RPI Part #CMK270

OEM Part # (No OEM Part # Available)

COMPRESSOR PM KIT

- **Important!** See **Notes** below
- For oil-less single headed compressors
- Includes: (1) Air Filter Element (RPI Part #CME288), (1) Particle Filter Element (RPI Part #CME085), PM Sticker and PM Checklist; All parts also sold separately

Models: AOCRS11 & AOCRS12

Notes: This PM Kit only fits the older style AOCRS11 and AOCRS12 models with an air filter housing that has a single threaded port.

For the PM Kit that fits the newer style AOCRS11 and AOCRS12 models with an air filter housing that has two ports, one at each end of the housing, see RPI Part #CMK271.



RPI Part #CME288

OEM Part # (No OEM Part # Available)

AIR FILTER ELEMENT

- **Important!** See **Notes** below
- 50 Microns
- Size: 1.30" OD x .62" ID x 1.00" lg.
- Included in: Air Intake Filter (RPI Part #CMF282) and Compressor PM Kit (RPI Part #CMK270)

Fits: Air Intake Filter Housing

Models: AOCRS11 & AOCRS12

Notes: This Air Filter Element only fits the air filter housing with a single threaded port on the older style AOCRS11 and AOCRS12 models.

This Air Filter Element is not to be used on the newer style AOCRS11 and AOCRS12 models where the housing has two ports, one at each end of the housing.

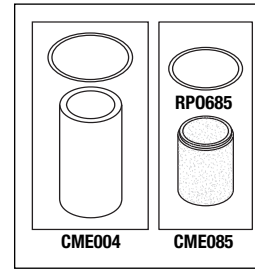

RPI Part #CMK271

OEM Part # (No OEM Part # Available)

COMPRESSOR PM KIT

- **Important!** See **Notes** below
- For oil-less single headed compressors
- Includes: (1) Replacement Filter Element (RPI Part #CME004), (1) Particle Filter Element (RPI Part #CME085), PM Sticker and PM Checklist; All parts also sold separately
- Also available: Air Intake Filter Kit (RPI Part #CMK003)

Models: AOCRS11 & AOCRS12

Notes: This PM Kit only fits the newer style AOCRS11 and AOCRS12 models where the air filter housing has two ports, one at each end of the housing.

For the PM Kit that fits the older style AOCRS11 and AOCRS12 models with an air filter housing that has a single threaded port, see RPI Part #CMK270.

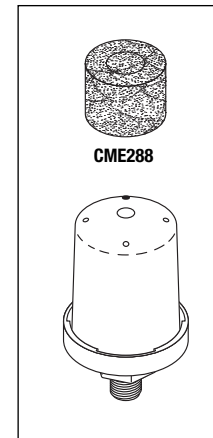

RPI Part #CMF282

OEM Part # (No OEM Part # Available)

AIR INTAKE FILTER

- **Important!** See **Notes** below
- 50 Microns
- Size: 2" dia. x 3.4" lg. x 1/4" MPT
- Includes: Air Filter Element (RPI Part #CME288)

Models: AOCRS11 & AOCRS12

Notes: This Air Intake Filter is not to be used on the newer style AOCRS11 and AOCRS12 models where the housing has two ports, one at each end of the housing.

AIR TECHNIQUES

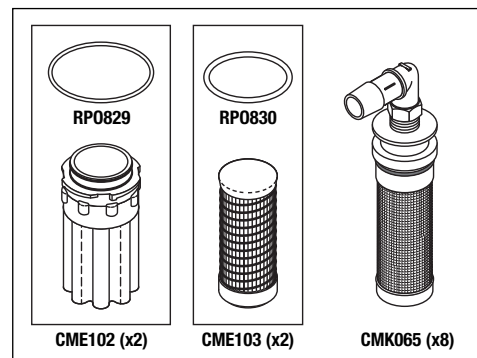

RPI Part #CMK278

OEM Part #87356

COMPRESSOR PM KIT

- For oil-less eight headed compressors
- Includes: (8) Air Filter Element Kit (RPI Part #CMK065), (2) Filter Element (RPI Part #CME102), (2) Filter Element (RPI Part #CME103), PM Sticker and PM Checklist; All parts also sold separately

Models: AirStar 100M



MATRIX/MIDMARK® (continued)

RPI Part #CMK263

OEM Part # (No OEM Part # Available)



COMPRESSOR PM KIT

- For lubricated single headed Copeland® compressors
- Fits early versions of the AMD-100 and AMD-102 manufactured before Matrix was acquired by Midmark Corp.
- Includes: (1) Coalescing Filter Element (RPI Part #CMK024), (3) Foam Element (RPI Part #CMF013), (1) Compressor Oil (RPI Part #CML001), (1 pc) Disposal Bag (RPI Part #RPB838), PM Sticker and PM Checklist; All parts also sold separately
- Also available: Compressor PM Kit for later versions of the AMD-100 (RPI Part #CMK167)
- See **It's the RPI Advantage!** below

Models: AMD-100 & AMD-102

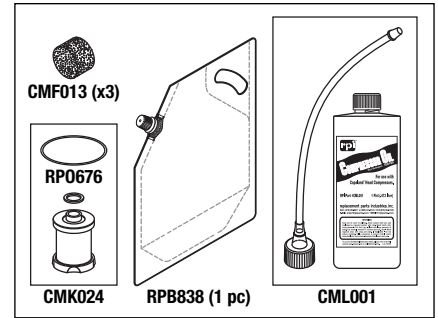

RPI Part #CMK264

OEM Part # (No OEM Part # Available)



COMPRESSOR PM KIT

- For lubricated dual headed Copeland® compressors
- Fits early versions of the AMD-100-2 manufactured before Matrix was acquired by Midmark Corp.
- Includes: (1) Coalescing Filter Element (RPI Part #CMK024), (5) Foam Element (RPI Part #CMF013), (2) Compressor Oil (RPI Part #CML001), (1 pc) Disposal Bag (RPI Part #RPB838), PM Sticker and PM Checklist; All parts also sold separately
- Also available: Compressor PM Kit for later versions of the AMD-100-2 (RPI Part #CMK168)
- See **It's the RPI Advantage!** below

Models: AMD-100-2

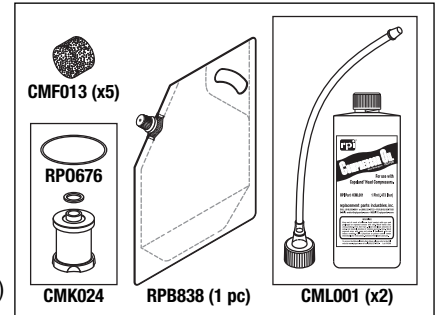

RPI Part #CMK265

OEM Part # (No OEM Part # Available)



COMPRESSOR PM KIT

- For lubricated triple headed Copeland® compressors
- Fits early versions of the AMD-100-3 manufactured before Matrix was acquired by Midmark Corp.
- Includes: (1) Coalescing Filter Element (RPI Part #CMK024), (6) Foam Element (RPI Part #CMF013), (3) Compressor Oil (RPI Part #CML001), (1 pc) Disposal Bag (RPI Part #RPB838), PM Sticker and PM Checklist; All parts also sold separately
- Also available: Compressor PM Kit for later versions of the AMD-100-3 (RPI Part #CMK169)
- See **It's the RPI Advantage!** below

Models: AMD-100-3

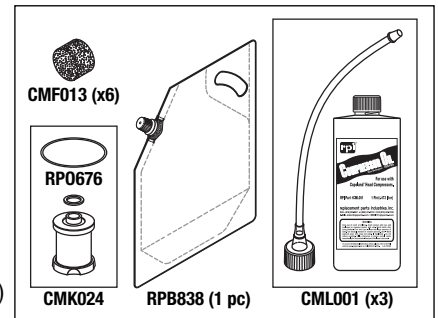

It's the RPI Advantage! Included in this Kit are a PM Sticker that can be attached to the compressor for recording the date that the filters and compressor oil were replaced; as well as a one gallon clear plastic bag with cap, built in handle, and expandable base that can be used to easily collect and dispose of used oil.

4 Essential Tools for an Easier Oil Change!

- 1 SYRINGE PUMP/EXTRACTOR (RPI Part #RPT842)**
This one-of-a-kind tool allows complete removal of oil from a compressor without needing to tilt or disassemble the unit!
- 2 DRAIN VALVE (RPI Part # RPV841)**
Upgrade to RPI's one-of-a-kind Drain Valve which has a special Tee-handle that allows you to easily open and close the valve to control the flow of oil as it is draining into the Disposal Bag!
- 3 DISPOSAL BAG (RPI Part #RPB838)**
The perfect solution for carrying, storing and disposing of used oil. This one gallon bag is constructed of durable clear plastic with an expandable base, a built in handle, and tight sealing cap.
- 4 COLLECTION CONTAINER KIT (RPI Part #'s CMK180 & CMK181)**
This one-of-kind collection bottle can replace the purge drain lines and be directly connected with tubing to the compressor so that the purge waste water and oil can be collected and disposed of properly according to local, state and federal regulations.

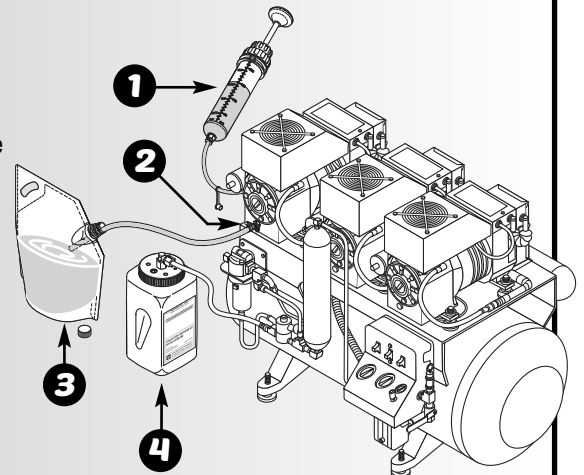

New PM Kits and More to fit Dental Compressors!

Keep your equipment running in peak performance with RPI's new PM Kits. Each Kit includes all of the Coalescing Filter Elements, Particulate Filter Elements, Air Filter Elements and Compressor Oil that should be replaced on an annual basis for your model in one convenient kit. Order one, then you're done!



New PM Kits and Parts to fit Dental Compressors!

ADDRESS SERVICES REQUESTED

PERMIT NO. 2399
VAN NUYS, CA
U.S. POSTAGE PAID
PRESORTED STANDARD

rpi!
replacement parts industries, inc.
625 Cochran Street • Simi Valley, California • 93065

TECH WEST



RPI Part #CMK275
OEM Part # (No OEM Part # Available)

COMPRESSOR PM KIT

- For oil-less "Rocky" Dual and Triple headed compressors
- Includes: (1) Air Filter Element (RPI Part #CME067), (1) Coalescing Filter Element (RPI Part #CME110), PM Sticker and PM Checklist;
- All parts also sold separately

Models: ACOR2D1, ACOR2D1Q, ACOR2D2, ACOR2D2Q, ACOR3T2 & ACOR3T2Q

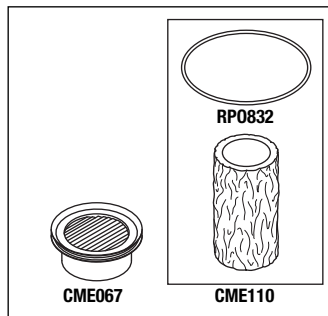

RPI Part #CMK277
OEM Part # (No OEM Part # Available)

COMPRESSOR PM KIT

- For oil-less quad headed compressors
- Includes: (1) Air Filter Element (RPI Part #CME069), (1) Coalescing Filter Element (RPI Part #CME110), PM Sticker and PM Checklist;
- All parts also sold separately

Models: ACOR4Q2

