

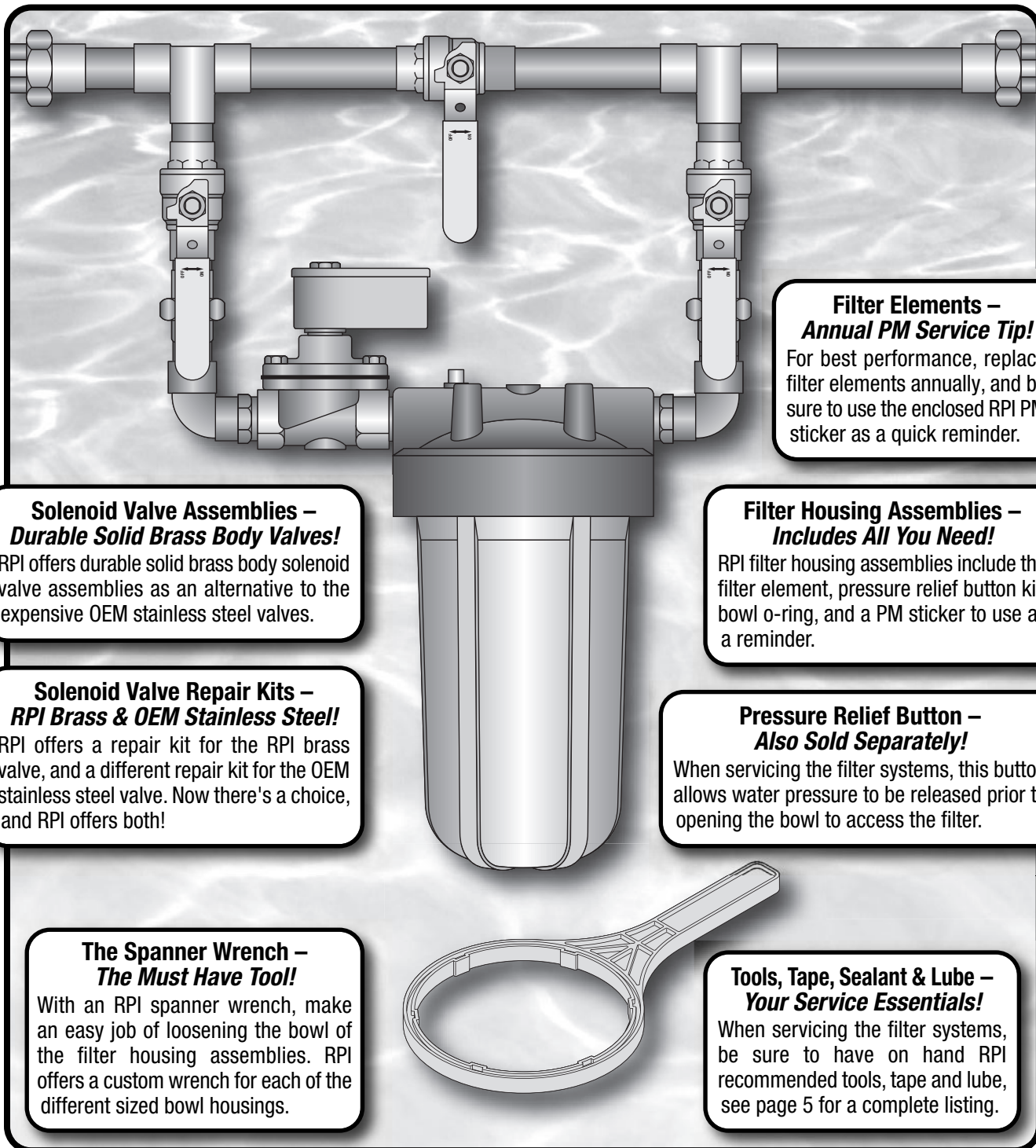

RPI Parts for ... Dental Utility Room Water Control Systems!

- Air Techniques
- Apollo/Midmark®
- DentaleEZ/Custom Air/Ramvac
- Matrx/Midmark®
- Midmark®
- Tech West



Solenoid Valve Assemblies – Durable Solid Brass Body Valves!
RPI offers durable solid brass body solenoid valve assemblies as an alternative to the expensive OEM stainless steel valves.

Solenoid Valve Repair Kits – RPI Brass & OEM Stainless Steel!
RPI offers a repair kit for the RPI brass valve, and a different repair kit for the OEM stainless steel valve. Now there's a choice, and RPI offers both!

The Spanner Wrench – The Must Have Tool!
With an RPI spanner wrench, make an easy job of loosening the bowl of the filter housing assemblies. RPI offers a custom wrench for each of the different sized bowl housings.

Filter Elements – Annual PM Service Tip!
For best performance, replace filter elements annually, and be sure to use the enclosed RPI PM sticker as a quick reminder.

Filter Housing Assemblies – Includes All You Need!
RPI filter housing assemblies include the filter element, pressure relief button kit, bowl o-ring, and a PM sticker to use as a reminder.

Pressure Relief Button – Also Sold Separately!
When servicing the filter systems, this button allows water pressure to be released prior to opening the bowl to access the filter.

Tools, Tape, Sealant & Lube – Your Service Essentials!
When servicing the filter systems, be sure to have on hand RPI recommended tools, tape and lube, see page 5 for a complete listing.



replacement parts industries, inc.

CALL (800) 221-9723 • FAX (818) 882-7028 • EMAIL order@rpiparts.com • WEBSITE www.rpiparts.com

The above parts are manufactured by Replacement Parts Industries, Inc. to fit the equipment noted. All product names used in this document are trademarks or registered trademarks of their respective holders. 1905WC SHOW 08/20



Models: Air Techniques: 53020 & 53020-1; Apollo/Midmark: ASAHWFB34, ASAHWFB34B, ASAHWFB34C, ASAWCFB34, ASAWCFB34B, ASAWCFB34C, ASAWFB34, ASAWFB34B & ASAWFB34C; Matrix/Midmark: FBR-34R; Midmark: 77002146; Tech West: WB-750, WB-750-RC, WBF-750 & WBF-750-RC

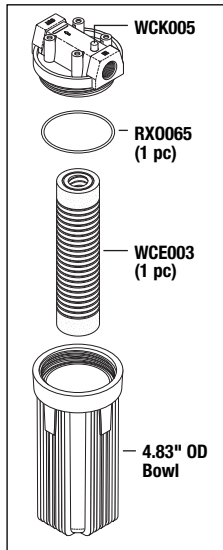

RPI Part #WCA001
OEM Part #53058;
53097; PFM70330;
7700077; WFB-750

FILTER HOUSING ASSEMBLY

- Ports: 3/4" FPT
 - 5 Micron Filtration
 - Includes all parts as shown and PM Sticker
 - Also available: Spanner Wrench (RPI Part #WCT007)
 - Recommended annual replacement for the Filter Element (5 Micron) (RPI Part #WCE003)
- Fits:** Water Control Systems

RPI Part #WCE003
OEM Part #53035; PFM85240;
77000300; WFE-750

FILTER ELEMENT (5 MICRON)

- 2 per package
 - Size: 2.50" OD x 9.88" lg.
 - Includes all parts as shown and PM Stickers
 - Recommended annual replacement for the Filter Element
- Fits:** 3/4" Filter Housing Assembly

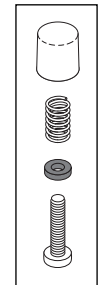
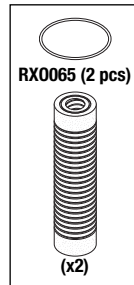

RPI Part #WCK005
OEM Part # (No OEM Number Available)

PRESSURE RELIEF BUTTON KIT

- Includes all parts as shown
- Fits:** Water Control Systems

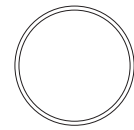

RPI Part #RX0066
OEM Part #53106;
MRP70950; 77007010

O-RING

- 2 per package
 - Size: 3.859" ID x 4.137" OD x .139" C/S
 - Material: Nitrile (Buna-N), 70 Duro
 - Included in: Filter Element (5 Micron) (RPI Part #WCE003)
- Fits:** 3/4" Filter Housing Assembly

NOT SHOWN TO SIZE

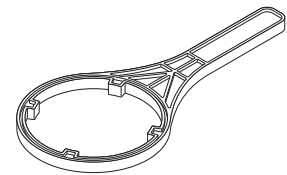

RPI Part #WCT007
OEM Part #MMS71173; 7700069

SPANNER WRENCH

- Wrench for 4.83" OD Bowl
- Fits:** 4.83" OD Filter Housing Assembly

Models: DentalEZ/Custom Air/Ramvac: WC110, WC210 & WC230

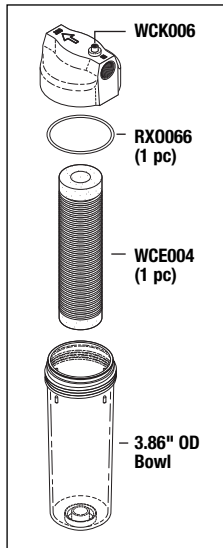

RPI Part #WCA002
OEM Part #64545021

FILTER HOUSING ASSEMBLY

- Ports: 3/4" FPT
 - 5 Micron Filtration
 - Includes all parts as shown and PM Sticker
 - Also available: Spanner Wrench (RPI Part #WCT008)
 - Recommended annual replacement for the Filter Element (5 Micron) (RPI Part #WCE004)
- Fits:** Water Control Systems

RPI Part #WCE004
OEM Part #64520006

FILTER ELEMENT (5 MICRON)

- 2 per package
 - Size: 2.50" OD x 9.88" lg.
 - Includes all parts as shown and PM Stickers
 - Recommended annual replacement for the Filter Element
- Fits:** 3/4" Filter Housing Assembly

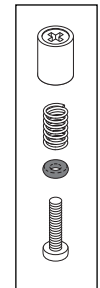
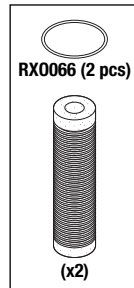

RPI Part #WCK006
OEM Part # (No OEM Number Available)

PRESSURE RELIEF BUTTON KIT

- Includes all parts as shown
- Fits:** Water Control Systems



RPI Part #RX0066
OEM Part # (No OEM Number Available)

O-RING

- 2 per package
 - Size: 3.484" ID x 3.762" OD x .139" C/S
 - Material: Nitrile (Buna-N), 70 Duro
 - Included in: Filter Element (5 Micron) (RPI Part #WCE004)
- Fits:** 3/4" Filter Housing Assembly

NOT SHOWN TO SIZE

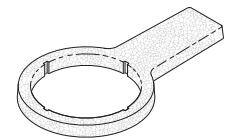

RPI Part #WCT008
OEM Part # (No OEM Number Available)

SPANNER WRENCH

- Wrench for 3.86" OD Bowl
- Fits:** 3.86" OD Filter Housing Assembly

Models: Air Techniques: 53170 & 53171; Apollo/Midmark: ASAWFB100, ASAWFB100B & ASAWFB100C; Matrix/Midmark: FBP-100R; Midmark: 77002147; Tech West: WBF-100 & WBF-100-RC

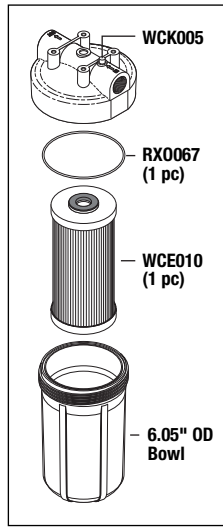

RPI Part #WCA009
OEM Part #53172;
77000073; 64545051;
WFB-1

FILTER HOUSING ASSEMBLY

- Ports: 1" FPT
 - 5 Micron Filtration
 - Includes all parts as shown and PM Sticker
 - Also available: Spanner Wrench (RPI Part #WCT012)
 - Recommended annual replacement for the Filter Element (5 Micron) (RPI Part #WCE010)
- Fits:** Water Control Systems

RPI Part #WCE010
OEM Part #53153;
PFM85241; 77000473;
64520012; WPE-100



FILTER ELEMENT (5 MICRON)

- 2 per package
 - Size: 4.50" OD x 9.75" lg.
 - Includes all parts as shown and PM Stickers
 - Recommended annual replacement for the Filter Element
- Fits:** 1", 1-1/4", and 1-1/2" Filter Housing Assy.

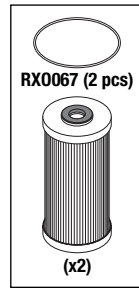

RPI Part #RX0067
OEM Part #53172-1;
MRP70951; 65977200;
64553032



O-RING

- 2 per package
 - Size: 5.510" ID x 5.850" OD x .170" C/S
 - Material: Nitrile (Buna-N), 70 Duro
 - Included in: Filter Element (5 Micron) (RPI Part #WCE010)
- Fits:** 1", 1-1/4", and 1-1/2" Filter Housing Assy.

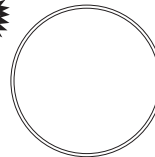

RPI Part #WCK005

OEM Part # (No OEM Number Available)

PRESSURE RELIEF BUTTON KIT

- Includes all parts as shown
- Fits:** Water Control Systems

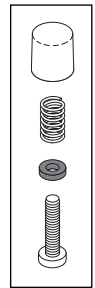

RPI Part #WCT012

OEM Part #77000063

SPANNER WRENCH

- Wrench for 6.05" OD Bowl
- Fits:** 6.05" OD Filter Housing Assembly

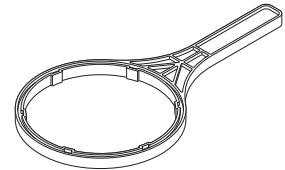

Models: Apollo/Midmark: ASAWFB150 & ASAWFB150C; Matrix/Midmark: FBP-150R; Midmark: 77002149

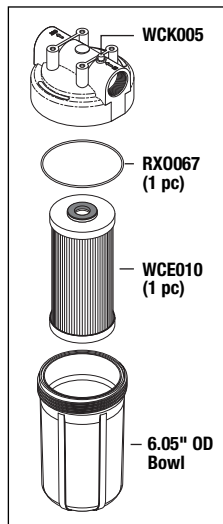

RPI Part #WCA014
OEM Part #7700073

FILTER HOUSING ASSEMBLY

- Ports: 1-1/2" FPT
 - 5 Micron Filtration
 - Includes all parts as shown and PM Sticker
 - Also available: Spanner Wrench (RPI Part #WCT012)
 - Recommended annual replacement for the Filter Element (5 Micron) (RPI Part #WCE010)
- Fits:** Water Control Systems

RPI Part #WCE010
OEM Part #53153;
PFM85241; 77000473;
64520012; WPE-100



FILTER ELEMENT (5 MICRON)

- 2 per package
 - Size: 4.50" OD x 9.75" lg.
 - Includes all parts as shown and PM Stickers
 - Recommended annual replacement for the Filter Element
- Fits:** 1", 1-1/4", and 1-1/2" Filter Housing Assy.

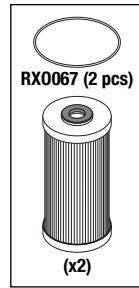

RPI Part #RX0067
OEM Part #53172-1;
MRP70951; 65977200;
64553032



O-RING

- 2 per package
 - Size: 5.510" ID x 5.850" OD x .170" C/S
 - Material: Nitrile (Buna-N), 70 Duro
 - Included in: Filter Element (5 Micron) (RPI Part #WCE010)
- Fits:** 1", 1-1/4", and 1-1/2" Filter Housing Assy.

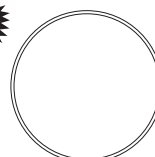

RPI Part #WCK005

OEM Part # (No OEM Number Available)

PRESSURE RELIEF BUTTON KIT

- Includes all parts as shown
- Fits:** Water Control Systems

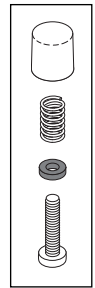

RPI Part #WCT012

OEM Part #77000063

SPANNER WRENCH

- Wrench for 6.05" OD Bowl
- Fits:** 6.05" OD Filter Housing Assembly

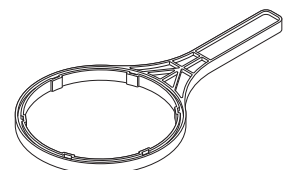

Models: Apollo/Midmark: ASAWFB125 & ASAWFB125C; DentalEZ/Custom Air/Ramvac: WC400 & WC410; Matrix/Midmark: FBP-125R; Midmark: 77002148

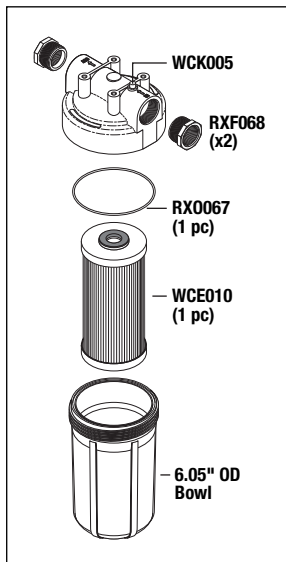

RPI Part #WCA013
OEM Part #7700073; 64622048; 64622102

FILTER HOUSING ASSEMBLY

- Ports: 1-1/4" FPT
 - 5 Micron Filtration
 - Includes all parts as shown and PM Sticker
 - Also available: Spanner Wrench (RPI Part #WCT012)
 - Recommended annual replacement for the Filter Element (5 Micron) (RPI Part #WCE010)
- Fits:** Water Control Systems



RPI Part #WCE010
OEM Part #53153; PFM85241; 77000473; 64520012; WPE-100

FILTER ELEMENT (5 MICRON)

- 2 per package
 - Size: 4.50" OD x 9.75" lg.
 - Includes all parts as shown and PM Stickers
 - Recommended annual replacement for the Filter Element
- Fits:** 1", 1-1/4", and 1-1/2" Filter Housing Assy.

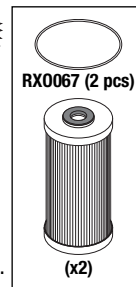

RPI Part #RX0067
OEM Part #53172-1; MRP70951; 65977200; 64553032

O-RING

- 2 per package
 - Size: 5.510" ID x 5.850" OD x .170" C/S
 - Material: Nitrile (Buna-N), 70 Duro
 - Included in: Filter Element (5 Micron) (RPI Part #WCE010)
- Fits:** 1", 1-1/4", and 1-1/2" Filter Housing Assy.

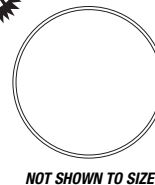

RPI Part #WCK005
OEM Part # (No OEM Number Available)

PRESSURE RELIEF BUTTON KIT

- Includes all parts as shown

Fits: Water Control Systems

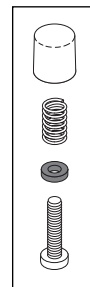

RPI Part #RXF068
OEM Part # (No OEM Number Available)

ADAPTOR (1-1/2" MPT x 1-1/4" FPT)

- Material: White PVC

Fits: 1-1/2" Filter Housing Assembly



RPI Part #WCT012
OEM Part #7700063

SPANNER WRENCH

- Wrench for 6.05" OD Bowl

Fits: 6.05" OD Filter Housing Assembly

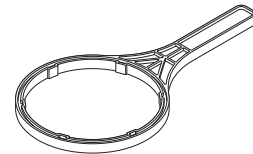

Service Essentials - Tools, Tape, Sealant and Lube

RPI Part #RPA459
OEM Part # (No OEM Number Available)

PIPE SEALANT 567

- .20 fl. oz. (6ml) per unit
- Temperature range: -65°F to 400°F (-54° to 204°C)

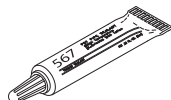

RPI Part #RPT579
OEM Part # (No OEM Number Available)

1/4" TEFLON THREAD SEALING TAPE

- 5 per package
- 1/4" x 260" per unit



RPI Part #RPL090
OEM Part # (No OEM Part # Available)

HIGH TEMP LUBRICANT

- 5 per package; 1/2 gram per unit
- Used on purge valves, pump packaging, gate valves, butterfly valves, sanitary valves, rubber and plastic o-rings, stems and pistons

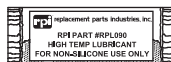

RPI Part #RPT580
OEM Part # (No OEM Number Available)

1/2" TEFLON THREAD SEALING TAPE

- 5 per package
- 1/2" x 260" per unit



RPI Part #ILS014
OEM Part # (No OEM Part # Available)

SPANNER WRENCH

- Size: .525" ID x .875" HEX x .250" THK
- Replacement end attachment for Double Ended Spanner Wrench (RPI Part #RPT501) or use as a stand alone Spanner Nut

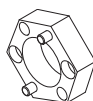

RPI Part #RPT501
OEM Part # (No OEM Part # Available)

DOUBLE ENDED SPANNER WRENCH

- Size: .875" HEX x 7" lg.
- Material: Aluminum handle with stainless steel end attachments
- Includes all parts as shown

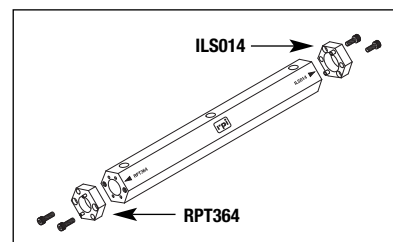



Brass Body

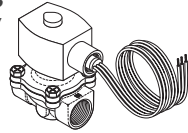

RPI Part #WCV018
OEM Part #53031 (Brass);
64622129 (SS)

SOLENOID VALVE

- 24VAC; Ports: 3/4" FPT
- Also available: Solenoid Valve Repair Kit (RPI Part #WCK020) for **brass** body solenoid valves. For OEM solenoid valves with **stainless steel** bodies, ask for the Solenoid Valve Repair Kit (RPI Part #WCK021).

Fits: Water Control Assembly

RPI BRASS VALVE REPAIR KIT

RPI Part #WCK020
OEM Part # (No OEM Number Available)
SOLENOID VALVE REPAIR KIT

- Includes all parts as shown
- **ONLY** Fits the **Brass Body** Solenoid Valve

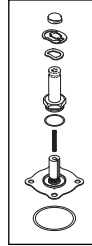

OEM S.S. VALVE REPAIR KIT

RPI Part #WCK021
OEM Part # (No OEM Number Available)
SOLENOID VALVE REPAIR KIT

- Includes all parts as shown plus a spanner nut
- **ONLY** Fits the DentalEZ **Stainless Steel** Body Valve #64622129

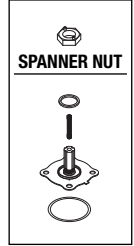

Brass Body

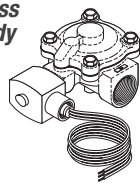

RPI Part #WCV026
OEM Part #53154 (Brass);
64622130 (SS)

SOLENOID VALVE

- 24VAC; Ports: 1" FPT
- Also available: Solenoid Valve Repair Kit (RPI Part #WCK028) for **brass** body solenoid valves. For OEM solenoid valves with **stainless steel** bodies, ask for the Solenoid Valve Repair Kit (RPI Part #WCK035).

Fits: Water Control Assembly

RPI BRASS VALVE REPAIR KIT

RPI Part #WCK028
OEM Part # (No OEM Number Available)
SOLENOID VALVE REPAIR KIT

- Includes all parts as shown
- **ONLY** Fits the **Brass Body** Solenoid Valve

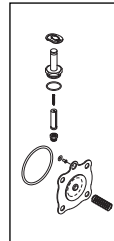

OEM S.S. VALVE REPAIR KIT

RPI Part #WCK035
OEM Part # (No OEM Number Available)
SOLENOID VALVE REPAIR KIT

- Includes all parts as shown
- **ONLY** Fits the DentalEZ **Stainless Steel** Body Valve #64622130

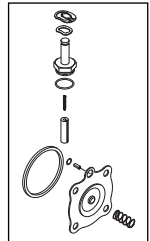

Brass Body

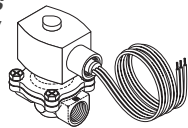

RPI Part #WCV015
OEM Part #64622128 (SS)

SOLENOID VALVE

- 24VAC; Ports: 1/2" FPT
- Also available: Solenoid Valve Repair Kit (RPI Part #WCK016) for **brass** body solenoid valves. For OEM solenoid valves with **stainless steel** bodies, ask for the Solenoid Valve Repair Kit (RPI Part #WCK011).

Fits: Water Control Assembly

RPI BRASS VALVE REPAIR KIT

RPI Part #WCK016
OEM Part # (No OEM Number Available)
SOLENOID VALVE REPAIR KIT

- Includes all parts as shown
- **ONLY** Fits the **Brass Body** Solenoid Valve

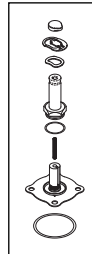

OEM S.S. VALVE REPAIR KIT

RPI Part #WCK011
OEM Part # (No OEM Number Available)
SOLENOID VALVE REPAIR KIT

- Includes all parts as shown plus a spanner nut
- **ONLY** Fits the DentalEZ **Stainless Steel** Body Valve #64622128

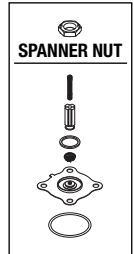

Brass Body

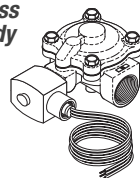

RPI Part #WCV029
OEM Part #53155 (Brass);
PVV10476 (Brass); 65976500 (SS)

SOLENOID VALVE

- 120VAC; Ports: 1" FPT
- Also available: Solenoid Valve Repair Kit (RPI Part #WCK028) for **brass** body solenoid valves. For OEM solenoid valves with **stainless steel** bodies, ask for the Solenoid Valve Repair Kit (RPI Part #WCK030).

Fits: Water Control Assembly

RPI BRASS VALVE REPAIR KIT

RPI Part #WCK028
OEM Part # (No OEM Number Available)
SOLENOID VALVE REPAIR KIT

- Includes all parts as shown
- **ONLY** Fits the **Brass Body** Solenoid Valve

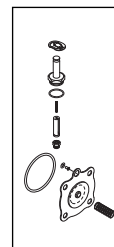

OEM S.S. VALVE REPAIR KIT

RPI Part #WCK030
OEM Part #77001648
SOLENOID VALVE REPAIR KIT

- Includes all parts as shown
- **ONLY** Fits the Midmark **Stainless Steel** body Valve #65976500

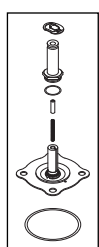



replacement parts industries, inc.

625 Cochran Street • Simi Valley, California • 93065

PRESORTED STANDARD
U.S. POSTAGE PAID
VAN NUYS, CA
PERMIT NO. 2399

ADDRESS SERVICES REQUESTED

Models: **Matrx/Midmark:** FBP-34R; **Midmark:** 77002146

RPI Part #WCV023
OEM Part #62970303 (SS)

SOLENOID VALVE

- 120VAC; Ports: 3/4" FPT
- Also available: Solenoid Valve Repair Kit (RPI Part #CSK050) for **brass** body solenoid valves. For OEM solenoid valves with **stainless steel** bodies, ask for the Solenoid Valve Repair Kit (RPI Part #WCK024).

Fits: Water Control Assembly

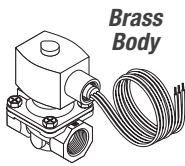

Brass Body

RPI BRASS VALVE REPAIR KIT

RPI Part #CSK050
OEM Part # (No OEM Number Available)

SOLENOID VALVE REPAIR KIT

- Includes all parts as shown
- **ONLY** Fits the **Brass Body** Solenoid Valve

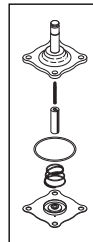

OEM S.S. VALVE REPAIR KIT

RPI Part #WCK024
OEM Part #77000997

SOLENOID VALVE REPAIR KIT

- Includes all parts as shown
- **ONLY** Fits the Midmark **Stainless Steel Body** Valve #62970303

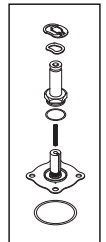

Models: **Matrx/Midmark:** 77002149 (Newer Matrx), 77000045 (Older Matrx); **Midmark:** 77002149

RPI Part #WCV032
OEM Part #65910800 (SS)

SOLENOID VALVE

- 120vac; Ports: 1-1/2" FPT
- Also available: Solenoid Valve Repair Kit (RPI Part #WCK033) for **brass** body solenoid valves. For OEM solenoid valves with **stainless steel** bodies, ask for the Solenoid Valve Repair Kit (RPI Part #WCK034).

Fits: Water Control Assembly

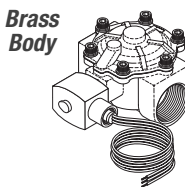

Brass Body

RPI BRASS VALVE REPAIR KIT

RPI Part #WCK033
OEM Part # (No OEM Number Available)

SOLENOID VALVE REPAIR KIT

- Includes all parts as shown
- **ONLY** For the **Brass Body** Solenoid Valve

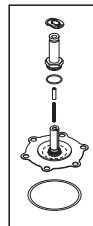

OEM S.S. VALVE REPAIR KIT

RPI Part #WCK034
OEM Part #77000967

SOLENOID VALVE REPAIR KIT

- Includes all parts as shown
- **ONLY** Fits the Midmark **Stainless Steel Body** Valve #65910800

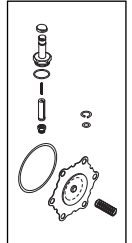

Models: **Air Techniques:** 53020-1 & 53021-1

RPI Part #WCV022
OEM Part #53031-1 (Brass)

SOLENOID VALVE

- 120VAC; Ports: 3/4" FPT
- Fits:** Water Control Assembly

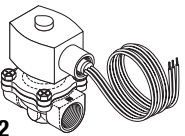

Brass Body

REPAIR KIT

RPI Part #WCK020
OEM Part # (No OEM Number Available)

SOLENOID VALVE REPAIR KIT

- Includes all parts as shown
- Fits:** Solenoid Valve

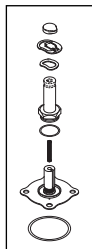

Models: **Tech West:** WB-100-RC & WBF-100-RC

RPI Part #WCV025
OEM Part #WMV-100

SOLENOID VALVE

- 120VAC; Ports: 1" FPT
- Fits:** Water Control Assembly

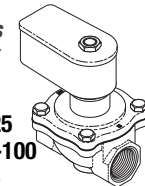

Brass Body

REPAIR KIT

RPI Part #WCK027
OEM Part # (No OEM Number Available)

SOLENOID VALVE REPAIR KIT

- Includes all parts as shown
- Fits:** Solenoid Valve

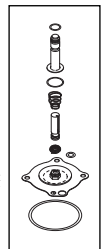

Models: **Midmark:** 77002148

RPI Part #WCV031
OEM Part #65976900 (Brass)

SOLENOID VALVE

- 120VAC; Ports: 1-1/4" FPT
- Fits:** Water Control Assembly

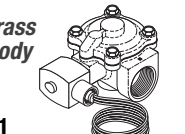

Brass Body

REPAIR KIT

RPI Part #WCK028
OEM Part # (No OEM Number Available)

SOLENOID VALVE REPAIR KIT

- Includes all parts as shown
- Fits:** Solenoid Valve



Models: **Tech West:** WB-750-RC & WBF-750-RC

RPI Part #WCV017
OEM Part #WMV-750

SOLENOID VALVE

- 120VAC; Ports: 3/4" FPT
- Fits:** Water Control Assembly

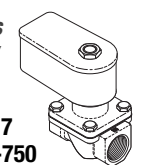

Brass Body

REPAIR KIT

RPI Part #WCK019
OEM Part # (No OEM Number Available)

SOLENOID VALVE REPAIR KIT

- Includes all parts as shown
- Fits:** Solenoid Valve

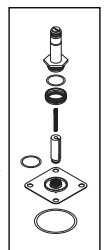

RPI Parts for Dental Utility Room Water Control Systems!

		Models these RPI Parts fit					
RPI PART #	DESCRIPTION	AIR TECHNIQUES	APOLLO/ MIDMARK®	DENTALEZ®/ CUSTOM AIR/RAMVAC	MATRIX/MIDMARK®	MIDMARK®	TECH WEST
FILTER ELEMENTS							
WCE003	FILTER ELEMENT (5 MICRON)	53020 & 53020-1	ASAHWFB34, ASAHWFB34B, ASAHWFB34C, ASAWCFB34, ASAWCFB34B, ASAWCFB34C, ASAWFB34, ASAWFB34B & ASAWFB34C		FBR-34R	77002146	WBF-750 & WBF-750-RC
WCE004	FILTER ELEMENT (5 MICRON)			WC110, WC210 & WC230			
WCE010	FILTER ELEMENT (5 MICRON)	53170 & 53171	ASAWFB100, ASAWFB100B, ASAWFB100C, ASAWFB125, ASAWFB125C, ASAWFB150 & ASAWFB150C	WC300, WC310, WC400 & WC410	FBP-100R, FBP-125R & FBP-150R	77002147, 77002148 & 77002149	WBF-100 & WBF-100-RC
FILTER HOUSING ASSEMBLIES							
WCA001	FILTER HOUSING ASSEMBLY	53020 & 53020-1	ASAHWFB34, ASAHWFB34B, ASAHWFB34C, ASAWCFB34, ASAWCFB34B, ASAWCFB34C, ASAWFB34, ASAWFB34B & ASAWFB34C		FBR-34R	77002146	WBF-750 & WBF-750-RC
WCA002	FILTER HOUSING ASSEMBLY			WC110, WC210 & WC230			
WCA009	FILTER HOUSING ASSEMBLY	53170 & 53171	ASAWFB100, ASAWFB100B & ASAWFB100C		FBP-100R	77002147	WBF-100, WBF-100-RC
WCA013	FILTER HOUSING ASSEMBLY		ASAWFB125 & ASAWFB125C	WC400 & WC410	FBP-125R	77002148	
WCA014	FILTER HOUSING ASSEMBLY		ASAWFB150 & ASAWFB150C		FBP-150R	77002149	
O-RINGS							
RX0065	O-RING	53020 & 53020-1	ASAHWFB34, ASAHWFB34B, ASAHWFB34C, ASAWCFB34, ASAWCFB34B, ASAWCFB34C, ASAWFB34, ASAWFB34B & ASAWFB34C		FBR-34R	77002146	WB-750, WB-750-RC, WBF-750 & WBF-750-RC
RX0066	O-RING			WC110, WC210 & WC230			
RX0067	O-RING	53170 & 53171	ASAWFB100, ASAWFB100B, ASAWFB100C, ASAWFB125, ASAWFB125C, ASAWFB150 & ASAWFB150C	WC300, WC310, WC400 & WC410	FBP-100R, FBP-125R & FBP-150R	77002147, 77002148 & 77002149	WBF-100 & WBF-100-RC
PRESSURE RELIEF BUTTON KITS							
WCK005	PRESSURE RELIEF BUTTON KIT	3/4" & 1" Water Control Systems	ASAHWFB34, ASAHWFB34B, ASAHWFB34C, ASAWCFB34, ASAWCFB34B, ASAWCFB34C, ASAWFB34, ASAWFB34B, ASAWFB34C, ASAWFB100, ASAWFB100B, ASAWFB100C, ASAWFB125, ASAWFB125C, ASAWFB150 & ASAWFB150C	WC400 & WC410	3/4", 1", 1-1/4" & 1-1/2" Water Control Systems	3/4", 1", 1-1/4" & 1-1/2" Water Control Systems	WBF-750, WBF-750-RC, WBF-100 & WBF-100-RC
WCK006	PRESSURE RELIEF BUTTON KIT			WC110, WC210 & WC230			
SOLENOID VALVES							
WCV015	SOLENOID VALVE			WC110			
WCV017	SOLENOID VALVE						WB-750-RC & WBF-750-RC
WCV018	SOLENOID VALVE	53020 & 53021		WC210 & WC230			
WCV022	SOLENOID VALVE	53020-1 & 53021-1			FBR-34R	77002146	
WCV023	SOLENOID VALVE						WB-100-RC & WBF-100-RC
WCV025	SOLENOID VALVE						
WCV026	SOLENOID VALVE	53170 & 53173		WC300			
WCV029	SOLENOID VALVE	53171 & 53174	ASAWB100, ASAWFB100		FBP-100R	77002147	
WCV031	SOLENOID VALVE					77002148	
WCV032	SOLENOID VALVE				77002149 (Newer Matrix) & 77000045 (Older Matrix)	77002149	
SOLENOID VALVE REPAIR KITS							
CSK050	SOLENOID VALVE REPAIR KIT				FBR-34R	77002146	
WCK011	SOLENOID VALVE REPAIR KIT			WC110			
WCK016	SOLENOID VALVE REPAIR KIT			WC110			
WCK019	SOLENOID VALVE REPAIR KIT						WB-750-RC & WBF-750-RC
WCK020	SOLENOID VALVE REPAIR KIT	53020, 53021, 53020-1 & 53021-1		WC210 & WC230			
WCK021	SOLENOID VALVE REPAIR KIT			WC210 & WC230			
WCK024	SOLENOID VALVE REPAIR KIT					77002146	
WCK027	SOLENOID VALVE REPAIR KIT						WB-100-RC & WBF-100-RC
WCK028	SOLENOID VALVE REPAIR KIT	53170, 53171, 53173 & 53174	ASAWB100, ASAWFB100	WC300	FBP-100R	77002147 & 77002148	
WCK030	SOLENOID VALVE REPAIR KIT					77002147	
WCK033	SOLENOID VALVE REPAIR KIT				77002149 (Newer Matrix) & 77000045 (Older Matrix)	77002149	
WCK034	SOLENOID VALVE REPAIR KIT				FBP-150R	77002149	
WCK035	SOLENOID VALVE REPAIR KIT			WC300			
SPANNER WRENCHES							
ILS014	SPANNER WRENCH	53020, 53020-1, 53021, 53021-1, 53170, 53171, 53173 & 53174	ASAWB34, ASAWB34C, ASAWB100, ASAWB100C, ASAWB125, ASAWB125C, ASAWB150, ASAWB150C, ASAWCFB34, ASAWCFB34C, ASAWFB34, ASAWFB34C, ASAWFB100, ASAWFB100C, ASAWFB125, ASAWFB125C, ASAWFB150, ASAWFB150C, ASAHWFB34 & ASAHWFB34C	WC110, WC210, WC230 & WC300	FBR-12R, FBP-34R, FBP-100R, FBP-125R & FBP-150R	77002146, 77002147, 77002148 & 77002149	WB-100, WB-100-RC, WB-750, WB-750-RC, WBF-100, WBF-100-RC, WBF-750 & WBF-750-RC
RPT501	DOUBLE ENDED SPANNER WRENCH	53020, 53020-1, 53021, 53021-1, 53170, 53171, 53173 & 53174	ASAWB34, ASAWB34C, ASAWB100, ASAWB100C, ASAWB125, ASAWB125C, ASAWB150, ASAWB150C, ASAWCFB34, ASAWCFB34C, ASAWFB34, ASAWFB34C, ASAWFB100, ASAWFB100C, ASAWFB125, ASAWFB125C, ASAWFB150, ASAWFB150C, ASAHWFB34 & ASAHWFB34C	WC110, WC210, WC230 & WC300	FBR-12R, FBP-34R, FBP-100R, FBP-125R & FBP-150R	77002146, 77002147, 77002148 & 77002149	WB-100, WB-100-RC, WB-750, WB-750-RC, WBF-100, WBF-100-RC, WBF-750 & WBF-750-RC
WCT007	SPANNER WRENCH	53020 & 53020-1	ASAHWFB34, ASAHWFB34B, ASAHWFB34C, ASAWCFB34, ASAWCFB34B, ASAWCFB34C, ASAWFB34, ASAWFB34B & ASAWFB34C		FBR-34R	77002146	WB-750, WB-750-RC, WBF-750 & WBF-750-RC
WCT008	SPANNER WRENCH			WC110, WC210 & WC230			
WCT012	SPANNER WRENCH	53170 & 53171	ASAWFB100, ASAWFB100B, ASAWFB100C, ASAWFB125, ASAWFB125C, ASAWFB150 & ASAWFB150C	WC300, WC310, WC400 & WC410	FBP-100R, FBP-125R & FBP-150R	77002147, 77002148 & 77002149	WBF-100 & WBF-100-RC
ACCESSORIES							
RPA459	PIPE SEALANT 567	53020, 53020-1, 53021, 53170, 53171, 53173 & 53174	ASAWB100, ASAHWFB34, ASAHWFB34B, ASAHWFB34C, ASAWCFB34, ASAWCFB34B, ASAWCFB34C, ASAWFB100, ASAWFB100B, ASAWFB100C, ASAWFB125, ASAWFB125C, ASAWFB150 & ASAWFB150C	WC110, WC210, WC230, WC300, WC400 & WC410	FBR-34R, FBP-100R, FBP-125R, FBP-150R, 77002149 (Newer Matrix) & 77000045 (Older Matrix)	77002146, 77002147, 77002148 & 77002149	WB-100-RC, WBF-100-RC, WBF-750 & WBF-750-RC
RPL090	HIGH TEMP LUBRICANT	53020, 53020-1, 53021, 53170, 53171, 53173 & 53174	ASAWB34, ASAWB34C, ASAWB100, ASAWB100C, ASAWB125, ASAWB125C, ASAWB150, ASAWB150C, ASAWCFB34, ASAWCFB34C, ASAWFB34, ASAWFB34C, ASAWFB100, ASAWFB100C, ASAWFB125, ASAWFB125C, ASAWFB150, ASAWFB150C, ASAHWFB34 & ASAHWFB34C	WC110, WC210, WC230 & WC300	FBR-12R, FBP-34R, FBP-100R, FBP-125R & FBP-150R		WB-100, WB-100-RC, WB-750, WB-750-RC, WBF-100, WBF-100-RC, WBF-750 & WBF-750-RC
RPT579	1/4" TEFLON THREAD SEALING TAPE	53020, 53020-1, 53021, 53170, 53171, 53173 & 53174	ASAWB100, ASAHWFB34, ASAHWFB34B, ASAHWFB34C, ASAWCFB34, ASAWCFB34B, ASAWCFB34C, ASAWFB34, ASAWFB34B, ASAWFB100, ASAWFB100B, ASAWFB100C, ASAWFB125, ASAWFB125C, ASAWFB150 & ASAWFB150C	WC110, WC210, WC230, WC300, WC400 & WC410	FBR-34R, FBP-100R, FBP-125R, FBP-150R, 77002149 (Newer Matrix) & 77000045 (Older Matrix)	77002146, 77002147, 77002148 & 77002149	WB-100-RC, WBF-100-RC, WBF-750 & WBF-750-RC
RPT580	1/2" TEFLON THREAD SEALING TAPE	53020, 53020-1, 53021, 53170, 53171, 53173 & 53174	ASAWB100, ASAHWFB34, ASAHWFB34B, ASAHWFB34C, ASAWCFB34, ASAWCFB34B, ASAWCFB34C, ASAWFB34, ASAWFB34B, ASAWFB100, ASAWFB100B, ASAWFB100C, ASAWFB125, ASAWFB125C, ASAWFB150 & ASAWFB150C	WC110, WC210, WC230, WC300, WC400 & WC410	FBR-34R, FBP-100R, FBP-125R, FBP-150R, 77002149 (Newer Matrix) & 77000045 (Older Matrix)	77002146, 77002147, 77002148 & 77002149	WB-100-RC, WBF-100-RC, WBF-750 & WBF-750-RC
RXF068	ADAPTOR (1-1/2" MPT x 1-1/4" FPT)		ASAWFB125 & ASAWFB125C	WC400 & WC410	FBP-125R	77002148	