

OEM MODEL Section 7 Page #'s

INFANT INCUBATORS

AIR SHIELDS • HILL-ROM • DRAGER

Isolette® C-86	200-201
Isolette® C-100	202-204
Isolette® C-100QT	202-204
Isolette® C-200	202-204
Isolette® C-200QT	202-204
Isolette® C-300	202-204
Isolette® C-400QT	202-204
Isolette® C-450QT	202-204
Isolette® C-500QT	202-204
Isolette® C-500QT Model XL	202-204
Isolette® C-550QT	202-204
Isolette® C-550QT Model XL	202-204
Isolette® C2000	206-209

GE • OHMEDA

Giraffe® Exam Light	217
Giraffe® Incubator	212-217
Giraffe® OmniBed®	212-217

OHIO MEDICAL • OHMEDA • GE

190	210
190A	210
Care Plus® 1000	210
Care Plus® 2000	210
Care Plus® 3000	210
Care Plus® 4000	210
General Care (GC)	210
Infant Care (IC)	210

INFANT WARMERS

AIR SHIELDS • HILL-ROM • DRAGER

7810 (Radiant Warmer)	301
7820 (Radiant Warmer)	301
7830 (Radiant Warmer)	301
7840 (Radiant Warmer)	301
ICS	300
IICS (PM 78-1)	301
Resuscitaire® RW82-1	302
Versalet® 7700	302-303

OHIO MEDICAL • OHMEDA • GE

Infant Warmer Systems (IWS) 2001	304
Infant Warmer Systems (IWS) 3000	304
Infant Warmer Systems (IWS) 3050	304
Infant Warmer Systems (IWS) 3100	304
Infant Warmer Systems (IWS) 3150	304
Infant Warmer Systems (IWS) 3300 (Panda®)	304
Infant Warmer Systems (IWS) 3400	304
Infant Warmer Systems (IWS) 3500	304
Infant Warmer Systems (IWS) 4000	304
Infant Warmer Systems (IWS) 4300	304
Infant Warmer Systems (IWS) 4400	304
Infant Warmer Systems (IWS) 5000	304

(continued)

OEM MODEL Section 7 Page #'s

PHOTOTHERAPY LIGHTS

AIR SHIELDS • HILL-ROM • DRAGER

IICS Phototherapy System 7850	400
PT1400	400
PT1400-1	400
PT1400-2	400
PT1400-2E	400
PT533	400
PTM-78-2	400

GE • OHMEDA

Biliblanket Plus	400
Biliblanket Plus High Output	400
Giraffe® Spot PT Lite	400

RPI Part #AIS034
OEM Part #17 806 27

LIGHT SOCKET

- 120VAC
- Accommodates standard NE51 bulb
- 9/16-27 lens threads
- 11/16-27 mounting threads
- Includes mounting hardware
- 1/4" tabs

Fits: Power Unit Panel
Model: C-86

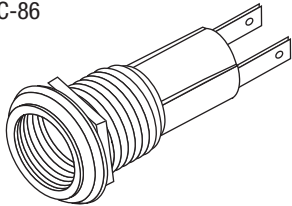

RPI Part #AMB028
OEM Part #17 800 30

LIGHT BULB

- Standard NE51 bulb (Neon)
- T-3-1/4 mini bayonet
- 120 VAC, .3 ma.

Fits: Light Socket
Model: C-86

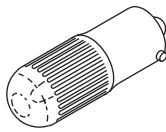

RPI Part #AIC035
OEM Part #17 802 60

LENS CAP (RED)

- 5/8" OD
- 9/16-27 thread

Fits: Light Socket
Model: C-86

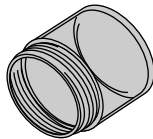

RPI Part #AIC036
OEM Part #17 804 00

LENS CAP (WHITE)

- 5/8" OD
- 9/16-27 thread

Fits: Light Socket
Model: C-86

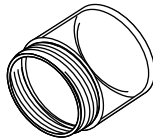

RPI Part #AIC037
OEM Part #17 802 30

LENS CAP (AMBER)

- 5/8" OD
- 9/16-27 thread

Fits: Light Socket
Model: C-86

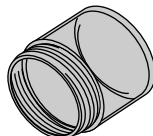

RPI Part #AIK005
OEM Part #68 905 72

MOTOR KIT- RPI "GREY" (NEW STYLE)

- 115VAC; 50/60 Hz., 1500 RPM
- This new style motor has a "grey" colored base
- Includes: Impeller (RPI Part #AI1006) & Motor Capacitor (RPI Part #AIC058)

Fits: Chassis Controller
Model: C-86

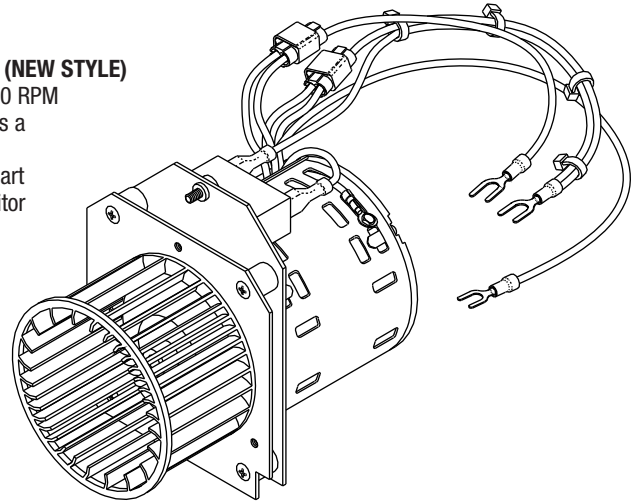

MOTOR KIT (220/240VAC; 1200 RPM)
TO FIT MODEL C86 IS ALSO AVAILABLE.
ASK FOR RPI PART #AIK009
(OEM PART #26 925 73)

RPI Part #AI1006
OEM Part #68 205 46

IMPELLER

Fits: Motor Shaft
Model: C-86

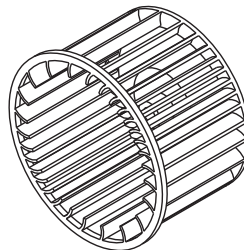

RPI Part #AIM021
OEM Part #17 776 59

PANEL METER

- 120V
- Range: 0, 1/4, 1/2, 3/4, Full
- Includes mounting bracket

Fits: Controller Front Panel
Model: C-86

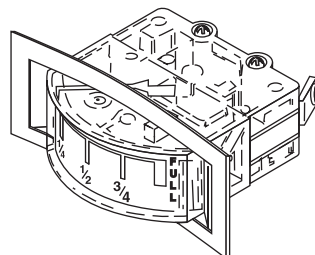

RPI Part #AIC058
OEM Part # (No OEM Part # Available)

MOTOR CAPACITOR

- 6 MFD; 250VAC; 50/60 Hz.
 - Matchbox style
- Fits:** Base Plate / RPI "new" style motors **only** – (RPI Part #'s AIK005 & AIK009) with "grey" colored case
Model: C-86

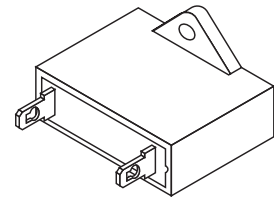

RPI Part #AIC059
OEM Part # (No OEM Part # Available)

MOTOR CAPACITOR

- 2.5 MFD; 400VAC; 60 Hz.
 - Matchbox style
- Fits:** Base Plate / RPI "old" style motors **only** – (RPI Part #'s AIK005 & AIK009) with "black" colored case
Model: C-86

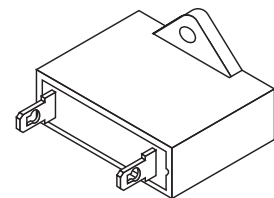

Infant Incubators

Model: Isolette® C-86 (Continued)

RPI Part #AIP063
OEM Part #17 575 14

SKIN TEMPERATURE PROBE (REUSABLE)

- 1/4" stereo phono plug
- Fits:** Controller
- Model:** C-86

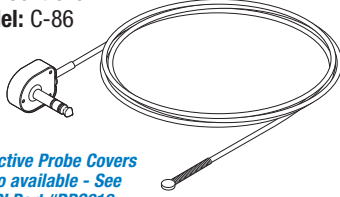

Reflective Probe Covers also available - See RPI Part #RPC619

RPI Part #RPC619
OEM Part #MU06944 & 68 209 48

REFLECTIVE PROBE COVER

- 100 per package
- Single use only
- Metalized Mylar with PSA backing; Latex Free
- Fits:** Skin Temperature Probe
- Models:** All Infant Warmer and Incubator Skin Temperature Probes



RPI Part #AIT011
OEM Part #26 928 71

THERMOSTAT (101.5°F)

- N.O.; Closes @ 101.5°F (38.61°C)
- Fits:** Thermostat Capsule
- Model:** C-86

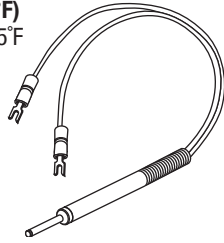

RPI Part #AIT012
OEM Part #26 928 72

THERMOSTAT (103°F)

- N.O.; Closes @ 103°F (39.44°C)
- Fits:** Thermostat Capsule
- Model:** C-86

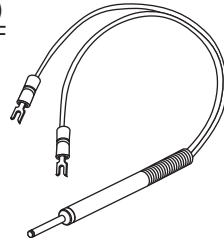

RPI Part #AIT086
OEM Part #26 681 00

RIGHT ANGLE THERMOMETER

- Graduated in Celsius 18° to 40°
- Graduated in Fahrenheit 60° to 105°
- Includes: (2) Nylon® Mounting Ring
- Fits:** Isolette Hood
- Model:** C-86

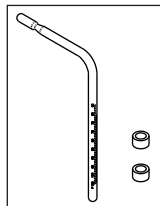

RPI Part #AIF024
OEM Part #MU03891 & 26 945 70

MICRO FILTER

- 4 per package
- ~6" x 24"
- Synthetic media - contains *no* glass fibers
- Latex free
- Fits:** Shell and Deck Assembly
- Model:** C-86

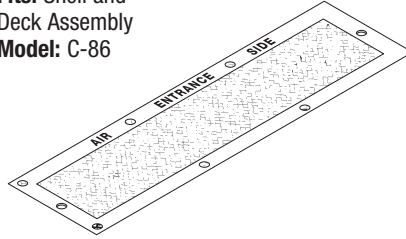

RPI Part #AIF082
OEM Part #MU06662 & 68 126 40

MICRO FILTER (DEW-ETTE®)

- 4 per package
- ~6" x 24"
- Synthetic media - contains *no* glass fibers
- Latex free
- Fits:** Shell and Deck Assembly
- Model:** C-86

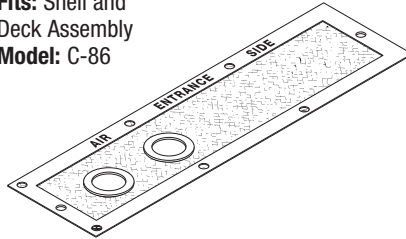

RPI Part #AIG015
OEM Part #MU01395 & 12 216 00

HOOD GASKET

- ~16" x 33.50"
- Material: Grey silicone rubber
- Fits:** Shell and Deck Assembly
- Model:** C-86

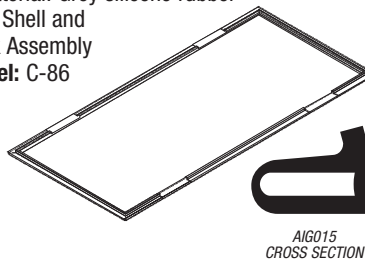

RPI Part #AIG019
OEM Part #26 630 11

ACCESS PANEL GASKET

- ~10.25" x 27"
- Material: Grey PVC
- Fits:** Access Panel
- Model:** C-86

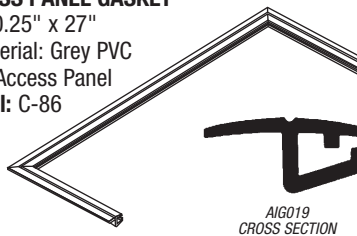

RPI Part #AIK160
OEM Part #MU08534 & 68 902 96

PAWL LATCH KIT

- Includes all parts as shown
- Fits:** Hood Assembly
- Model:** C-86

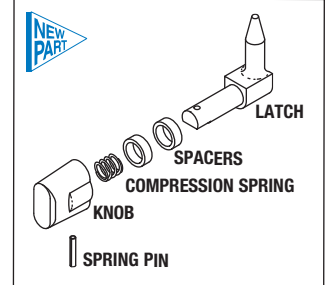

RPI Part #AIG025
OEM Part #26 654 00

ACCESS DOOR GASKET

- ~6.13" OD
- Soft flexible PVC - grey
- Fits:** Access Panel
- Model:** C-86

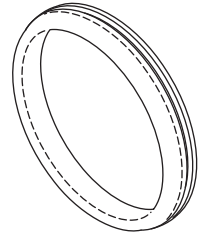

RPI Part #AID001
OEM Part #MU03817 & 26 650 00

ACCESS DOOR

- ~6.00" OD
- Clear
- Fits:** Hood
- Model:** C-86

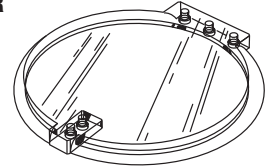

RPI Part #AIG017
OEM Part #MU03784 & 26 501 00

THERMOSTAT PLUG GASKET

- ~2.60" OD
- Sponge rubber
- Fits:** Thermostat Plug
- Model:** C-86

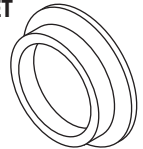

RPI Part #AIG018
OEM Part #MU03785 & 26 503 00

POWER PACK GASKET

- ~3.75"/5.50" x 12"
- Sponge rubber
- Fits:** Heater and Stiffener Plate
- Model:** C-86

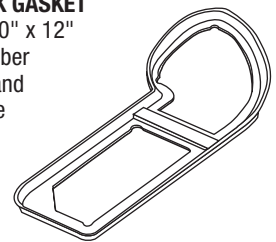

Cross section illustrations are actual size. Where practical, cut old part to match with cross section illustration.

FAX: (818) 882-7028 • E-MAIL: order@rpiparts.com • WEBSITE: www.rpiparts.com

Models: Isolette® C-100, C-100QT, C-200, C-200QT, C-300, C-400QT, C-450QT, C-500QT, C-500QT model XL, C-550QT & C-550QT model XL

RPI Part #AID001
OEM Part #MU03817 & 26 650 00

ACCESS DOOR

- ~6.00" OD; Clear
- Fits:** Access Panel and Hood (Model C-100/200); and, End and Front Door (Model C-300)
- Models:** C-100, C-200 & C-300

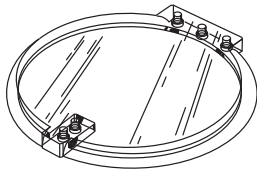

RPI Part #AIG016
OEM Part #MU06536 & 68 120 00

ACCESS DOOR GASKET

- ~6.17" OD
- Soft flexible white PVC
- Fits:** Hood Assembly
- Models:** C-100, C-200 & C-300

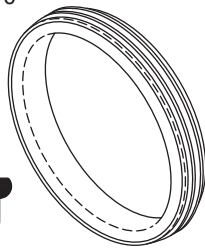

AIG016
CROSS SECTION

RPI Part #AIG027
OEM Part #MU06538 & 68 120 01

ACCESS DOOR GASKET

- ~6.94" OD
- Soft flexible white PVC
- Fits:** Access Panel
- Models:** C-100QT, C-200QT, C-400QT, C-450QT, C-500QT, C-500QT model XL, C-550QT & C-550QT model XL

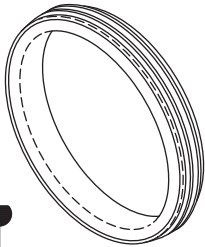

AIG027
CROSS SECTION

RPI Part #AIG028
OEM Part #MU03891 & 68 512 10

SEALING STRIP

- ~33.50" lg.; White PVC
- Fits:** Access Panel
- Models:** C-100QT, C-200QT, C-400QT, C-450QT, C-500QT & C-500QT model XL

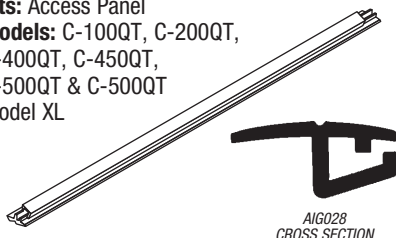

AIG028
CROSS SECTION

RPI Part #AIK160
OEM Part #MU08534 & 68 902 96

PAWL LATCH KIT

- Includes all parts as shown
- Fits:** Hood Assembly
- Models:** C-100, C-100QT, C-200, C-200QT, C-400QT, C-450QT, C-500QT, C-500QT model XL, C-550QT & C-550QT model XL

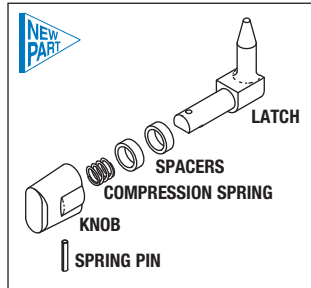

RPI Part #AIK061
OEM Part #MU10688 & 68 156 63

LARGE RETAINER KNOB

- ~.91" OD x .75" lg.
- Fits:** Access panel
- Models:** C-100QT, C-200QT, C-400QT & C-450QT

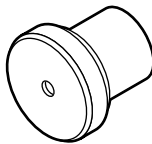

RPI Part #AIK062
OEM Part #MU06809 & 68 156 62

SMALL RETAINER KNOB

- ~.75" OD x .75" lg.
- Fits:** Access Panel
- Models:** C-100QT, C-200QT, C-400QT & C-450QT



RPI Part #RPC260
OEM Part #17 AZ 100

HOSPITAL GRADE POWER CORD

- 10 ft
- 14/3 SJT, 15A@125V
- Models:** C-100, C-100QT, C-200, C-200QT, C-300, C-400QT, C-450QT, C-500QT, C-500QT model XL, C-550QT & C-550QT model XL

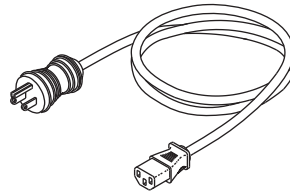

Cross section illustrations are actual size. Where practical, cut old part to match with cross section illustration.

RPI Part #AIH143
OEM Part #MU08163 (Pivot Hinge Only), 68 510 05 (Pivot Hinge Only) & 83 300 08 (Pivot Hinge Only)

PIVOT HINGE (ACCESS DOOR)

- Includes all parts as shown
- Fits:** Hood Assembly
- Models:** C-100QT, C-200QT, C-400QT, C-450QT, C-500QT, C-500QT model XL, C-550QT & C-550QT model XL

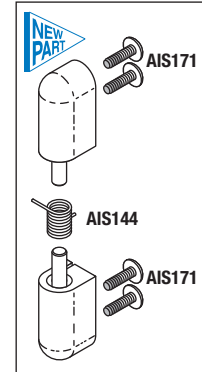

RPI Part #AIS144
OEM Part #MU08164 & 68 510 10

SPRING (TORSION)

- Material: Stainless steel
- .270" OD x .360" lg. x .030" dia. wire
- Also Included in: Pivot Hinge (Access Door) (RPI Part #AIH143)

- Fits:** Access Door Pivot Hinge
- Models:** C-100QT, C-200QT, C-400QT, C-450QT, C-500QT, C-500QT model XL, C-550QT & C-550QT model XL



RPI Part #AIS171
OEM Part #MU15131 & 99 023 64

SCREW (#6-32 x 7/16)

- 4 per package
- Material: Stainless steel supplied with pre-applied thread locker
- Size: #6-32 x 7/16" lg. Phillips Truss Head Screw
- Also included in: Pivot Hinge (Access Door) (RPI Part #AIH143)

- Models:** C-100QT, C-200QT, C-400QT, C-450QT, C-500QT, C-500QT model XL, C-550QT & C-550QT model XL

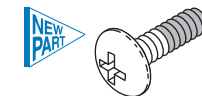

RPI Part #AIG020
OEM Part #MU12609 & 83 200 20

ACCESS GROMMET

- Material: Translucent thermoplastic rubber

- Fits:** Hood Assembly
- Models:** C-100, C-100QT, C-200, C-200QT, C-300, C-400QT, C-450QT, C-500QT, C-500QT model XL, C-550QT & C-550QT model XL

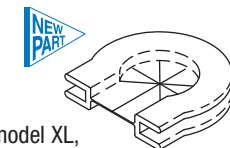

Infant Incubators

Models: Isolette® C-100, C-100QT, C-200, C-200QT, C-300, C-400QT, C-450QT, C-500QT, C-500QT model XL, C-550QT & C-550QT model XL (Continued)

RPI Part #AIP080
OEM Part #MU06933 & 68 209 20

SKIN TEMPERATURE PROBE (DISPOSABLE)

- Includes (10) probes and (10) pieces) Reflective Probe Cover (RPI Part #RPC619)
- Single use only
- 3 pin din connector

Fits: Controller

Models: C-100, C-100QT, C-450QT & C-550QT

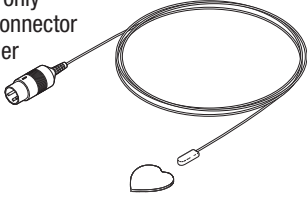

ALSO AVAILABLE BY THE CASE
RPI Part #AIP101 - 100/CASE
OEM Part #68 209 30 / MU6935

RPI Part #AIP064
OEM Part #MU06951 & 68 209 70

SKIN TEMPERATURE PROBE (REUSABLE)

- 3 pin din connector

Fits: Controller

Models: C-100, C-100QT, C-450QT & C-550QT

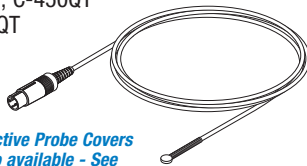

Reflective Probe Covers also available - See RPI Part #RPC619

RPI Part #RPC619
OEM Part #MU06944 & 68 209 48

REFLECTIVE PROBE COVER

- 100 per package
- Single use only
- Metalized Mylar with PSA backing; Latex Free

Fits: Skin Temperature Probe

Models: All Infant Warmer and Incubator Skin Temperature Probes



RPI Part #AIP070
OEM Part #MU06955 & 68 209 80

AIR AUXILIARY PROBE (GROUP 1)

- Loudspeaker type pin & blade connector
- Reuseable

Fits: Controller (Group 1)

Models: C-100, C-100QT, C-200, C-200QT, C-400QT & C-450QT



RPI Part #AIP141
OEM Part #MU06956 & 68 209 81

AIR AUXILIARY PROBE (GROUP 2)

- Reuseable

Fits: Controller (Group 2)

Models: C-400QT, C-450QT, C-500QT, C-500QT model XL, C-550QT & C-550QT model XL

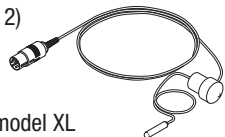

RPI Part #AIF024
OEM Part #MU03891 & 26 945 70

MICRO FILTER

- 4 per package
- ~6" x 24"
- Synthetic media - contains *no* glass fibers
- Latex free

Fits: Shell and Deck Assembly

Models: C-100, C-100QT, C-200, C-200QT, C-400QT, C-450QT, C-500QT, C-500QT model XL, C-550QT & C-550QT model XL

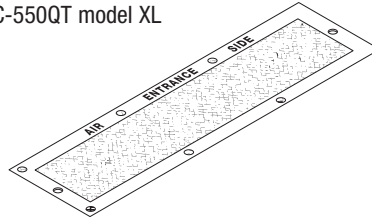

RPI Part #AIF082
OEM Part #MU06662 & 68 126 40

MICRO FILTER (DEW-ETTE®)

- 4 per package
- ~6" x 24"
- Synthetic media - contains *no* glass fibers
- Latex free

Fits: Shell and Deck Assembly

Models: C-100, C-100QT, C-200, C-200QT, C-400QT, C-450QT, C-500QT, C-500QT Model XL, C-550QT, C-550QT Model XL with Dew-ette® option

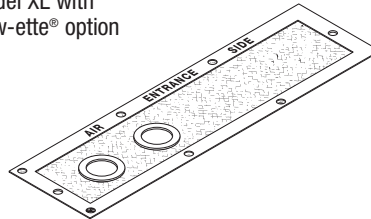

RPI Part #AIG015
OEM Part #MU01395 & 12 216 00

HOOD GASKET

- ~16" x 33.50"
- Material: Grey silicone rubber

Fits: Shell and Deck Assembly

Models: C-100, C-100QT, C-200, C-200QT, C-400QT, C-450QT, C-500QT & C-550QT model XL

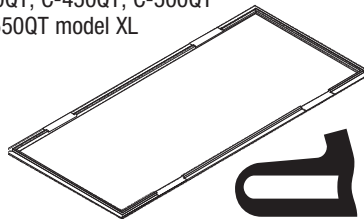

Cross section illustrations are actual size. Where practical, cut old part to match with cross section illustration.

RPI Part #AIS060
OEM Part #MU06827 & 68 157 56

"QT" HEAT SHIELD

- Clear

Fits: Panel Assembly Wall

Models: C-100QT, C-200QT, C-400QT & C-450QT

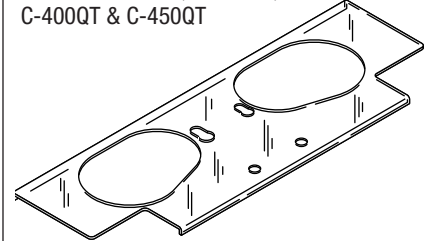

RPI Part #AIS047
OEM Part #MU03291 & 17 682 63

ROCKER SWITCH

- DPST
- 22A @ 125VAC; 16A @ 250VAC
- .250" tabs
- Color: Black

Fits: Basic Assembly

Model: C-300

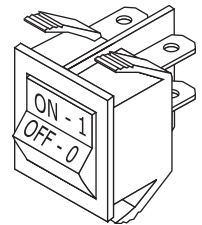

RPI Part #AIK068
OEM Part #MU02876 & 17 061 89

INSTRUMENT KNOB

- Size: ~1.13" OD; Fits .250" dia. shaft
- Color: Black
- Includes installed set screw

Fits: Controller Front Panel

Models: C-100, C-100QT, C-200 & C-200QT

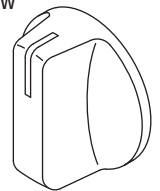

RPI Part #AIS067
OEM Part #MU06961 & 68 210 75

RESET SWITCH ASSEMBLY

- SPST
- Normally Open
- 0.5A, 125VAC
- ~ 6" lg. wires
- Red button

Fits: Controller Front Panel

Models: C-100, C-100QT, C-200 & C-200QT

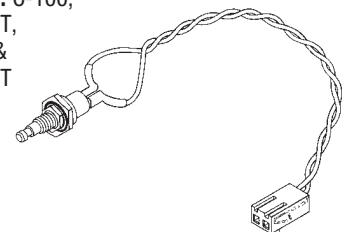

Models: Isolette® C-100, C-100QT, C-200, C-200QT, C-300, C-400QT, C-450QT, C-500QT, C-500QT model XL, C-550QT & C-550QT model XL (Continued)

RPI Part #AIK007

OEM Part #MU08632 & 68 905 70

MOTOR KIT - RPI "GREY" (NEW STYLE)

- 115VAC; 50/60 Hz., 1500 RPM
- This new style motor has a "grey" colored base
- Includes: Impeller (RPI Part #AI1008) and Motor Capacitor (RPI Part #AIC058)

Fits: Chassis Controller

Models: C-100, C-100QT, C-200, & C-200QT

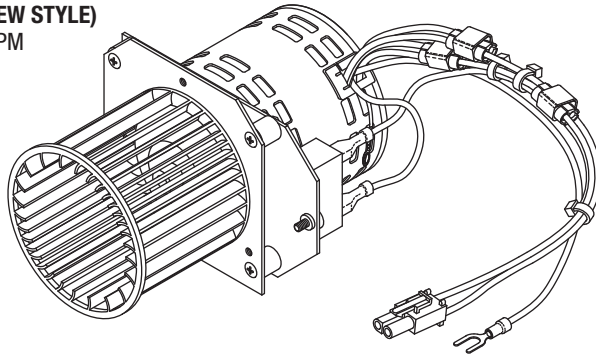

**MOTOR KIT (220/240VAC; 1200 RPM)
TO FIT MODELS C-100, C-100QT, C-200 & C-200QT IS ALSO AVAILABLE.
ASK FOR RPI PART #AIK010
(OEM Part #MU08633 & 68 905 71)**

RPI Part #AIG018

OEM Part #MU03785 & 26 503 00

POWER PACK GASKET

- ~3.75"/5.50" x 12"
- Sponge rubber
- Fits:** Heater and Stiffener Plate
- Models:** C-100, C-100QT, C-200, C-200QT, C-400QT, C-450QT, C-500QT, C-500QT model XL, C-550QT & C-550QT model XL

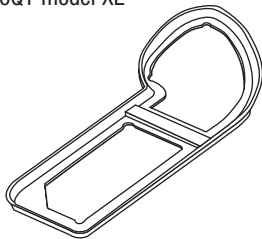

RPI Part #AIG017

OEM Part #MU03784 & 26 501 00

THERMOSTAT PLUG GASKET

- ~2.60" OD
- Sponge rubber
- Fits:** Thermostat Plug
- Models:** C-100, C-100QT, C-200, C-200QT, C-400QT, C-450QT, C-500QT, C-500QT model XL, C-550QT & C-550QT model XL

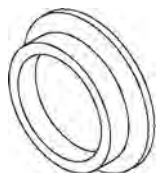

RPI Part #AI1008

OEM Part #MU06909 & 68 205 45

IMPELLER

- Fits:** Motor Shaft
- Models:** C-100, C-100QT, C-200 & C-200QT

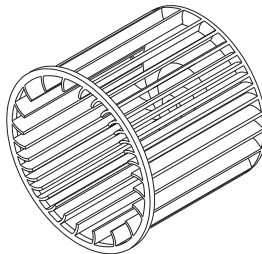

RPI Part #AIH069

OEM Part #MU06918 & 68 208 25

HEATER

- 377W, 120VAC, ~40Ω
- Fits:** Chassis Controller
- Models:** C-100, C-100QT, C-200, C-200QT, C-400QT & C-450QT

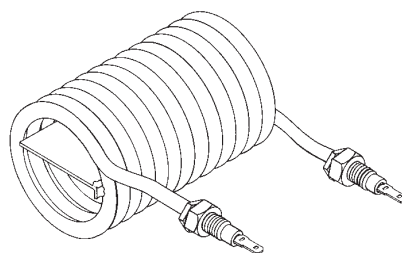

RPI Part #AIC059

OEM Part # (No OEM Part # Available)

MOTOR CAPACITOR

- 2.5 MFD; 400VAC; 60 Hz.
- Matchbox style
- Fits:** RPI "old" style motors only – (RPI Part #'s AIK007 & AIK010) with "black" colored case
- Models:** C-100, C-100QT, C-200 & C-200QT

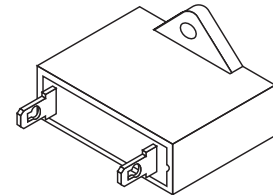

RPI Part #AIC058

OEM Part # (No OEM Part # Available)

MOTOR CAPACITOR

- 6 MFD; 250VAC; 50/60 Hz.
- Matchbox style
- Fits:** RPI "new" style motors only – (RPI Part #'s AIK007 & AIK010) with "grey" colored case
- Models:** C-100, C-100QT, C-200 & C-200QT

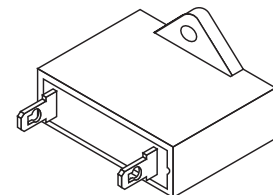

RPI Part #AIR013

OEM Part #MU08571, MU08572, 17 652 78, 68 903 83 & 68 903 84

RELAY

- Contacts: 10A @ 24-280VAC
- Input: 3-32VDC
- Size: ~2.25" L x 1.75" W x .78" H
- Includes built-in LED Input Status Indicator
- Fits:** Controller
- Models:** C-100, C-100QT, C-200 & C-200QT

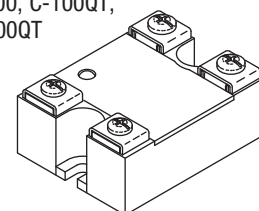

RPI Part #AIF140
OEM Part #MU12504 & 83 101 30

MICRO FILTER

- 4 per package
- ~3" x 5-1/2"
- Synthetic media - contains *no* glass fibers
- Latex free

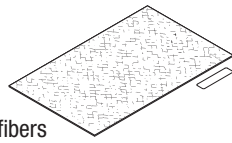

Includes installation date label

Fits: Filter Housing
Model: C2000

RPI Part #AIN169
OEM Part #MU15420 (1 Pc only) & 99 105 06 (1 Pc only)



WING NUT (#6-32)

- 6 per package
- Material: Stainless steel



Fits: Controller
Model: C2000

RPI Part #AIP133
OEM Part #MU12551 & 83 104 15

SKIN TEMPERATURE PROBE (DISPOSABLE)

- Includes (10) probes and (10) pieces Reflective Probe Cover (RPI Part #RPC619)
- Single use only
- 6 pin connector

Fits: Controller
Model: C2000

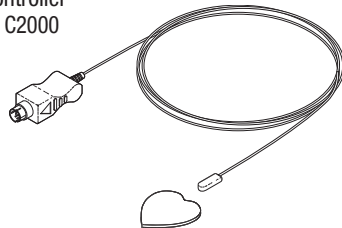

ALSO AVAILABLE BY THE CASE
RPI Part #AIP134 - 100/CASE

RPI Part #AIP135
OEM Part #MU12533 & 83 102 41

SKIN TEMPERATURE PROBE (REUSABLE)

- 6 pin connector

Fits: Controller
Model: C2000

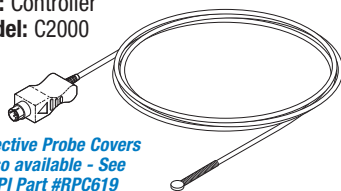

Reflective Probe Covers also available - See RPI Part #RPC619

RPI Part #RPC619
OEM Part #MU06944 & 68 209 48

REFLECTIVE PROBE COVER

- 100 per package
- Single use only
- Metalized Mylar with PSA backing; Latex Free



Fits: Skin Temperature Probe
Models: All Infant Warmer and Incubator Skin Temperature Probes

RPI Part #AIP165
OEM Part #MU12397 (Overlay Only) & 83 020 67 (Overlay Only)



FRONT PANEL ASSEMBLY

- Overlay mounted to sheet metal frame
- Includes all parts as shown

Fits: Controller
Model: C2000

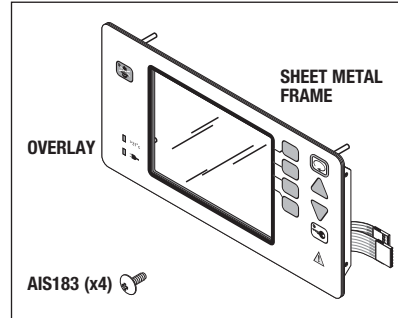

RPI Part #AIS183
OEM Part #MU15067 & 99 010 56



SCREW (#4-40 x 1/4)

- 4 per package
- Material: Stainless steel
- Size: #4-40 x 1/4" lg. Phillips Truss Head Screw



Fits: Front Panel Assembly
Model: C2000

RPI Part #AIF158
OEM Part #MU12409 (Fan Only) & 83 020 91 (Fan Only)



FAN ASSY (CONTROLLER)

- Size: 1.575" x 1.575" x .413" fan housing
- 10.8 to 13.2 VDC; 4200 RPM
- Includes all parts as shown

Fits: Controller
Model: C2000

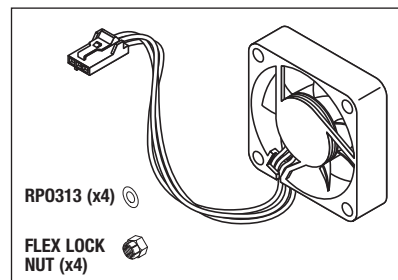

RPI Part #AIA159
OEM Part #MU12411 & 83 020 93



POWER SWITCH ASSEMBLY

- Switch: 8A @ 125VAC; DPDT

Fits: Controller
Model: C2000

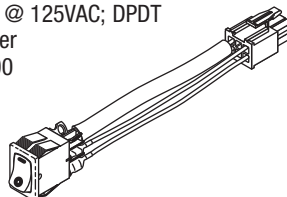

RPI Part #AIC156
OEM Part #MU12287 (Cable Only) & 83 005 30 (Cable Only)



SENSOR MODULE CABLE ASSY

- Length: ~32"
- Includes all parts as shown

Fits: Sensor Module
Model: C2000

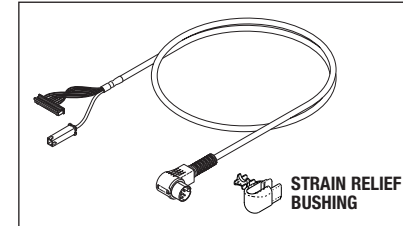

RPI Part #AIF157
OEM Part #MU12299 (Fan Only) & 83 005 46 (Fan Only)



FAN ASSY (SENSOR MODULE)

- Size: 1.575" x 1.575" x .413" fan housing
- 10.8 to 13.2 VDC; 4200 RPM
- Includes all parts as shown

Fits: Sensor Module
Model: C2000

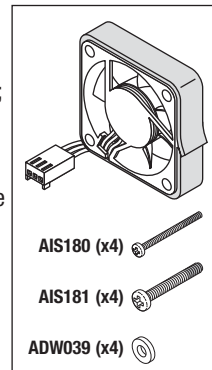

AIS180 (x4)
 AIS181 (x4)
 ADW039 (x4)

RPI Part #ADW039
OEM Part #MU15510 & 99 121 22



FLAT WASHER (#6)

- 15 per package
- Material: Nylon®
- Size: .140" ID x .320" OD x .030" thk



Model: C2000

RPI Part #AIS180
OEM Part #MU15095 & 99 012 33



SCREW (#4-40 x 1)

- 4 per package
- Material: Stainless steel supplied with pre-applied thread locker
- Size: #4-40 x 1.0" lg. Phillips Pan Head Screw

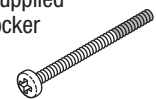

Model: C2000

RPI Part #AIS181
OEM Part #MU15153 & 99 024 98



SCREW (#6-32 x 15/16)

- 4 per package
- Material: Stainless steel supplied with pre-applied thread locker
- Size: #6-32 x 15/16" lg. Phillips Pan Head Screw

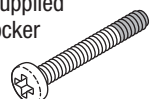

Model: C2000

Infant Incubators

Model: Isolette® C2000 (Continued)

RPI Part #AIH151
OEM Part #MU12601 (Hinge Only) & 83 200 11 (Hinge Only)

HINGE (HOOD) FRONT LEFT

- Includes all parts as shown
- Also available: Hinge (Access Panel) Front Left (RPI Part #AIH147) and Hinge Pin Kit (RPI Part #AIK167)

Fits: Hood Assembly
Model: C2000

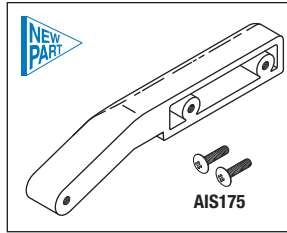

RPI Part #AIH150
OEM Part #MU12600 (Hinge Only) & 83 200 10 (Hinge Only)

HINGE (HOOD) FRONT RIGHT

- Includes all parts as shown
- Also available: Hinge (Access Panel) Front Right (RPI Part #AIH146) and Hinge Pin Kit (RPI Part #AIK167)

Fits: Hood Assembly
Model: C2000

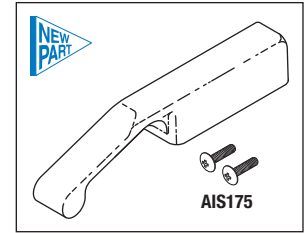

RPI Part #AIH153
OEM Part #MU12602 (Hinge Only) & 83 200 12 (Hinge Only)

HINGE (HOOD) REAR LEFT

- Includes all parts as shown
- Also available: Hinge (Access Panel) Rear Left (RPI Part #AIH149) and Hinge Pin Kit (RPI Part #AIK167)

Fits: Hood Assembly
Model: C2000

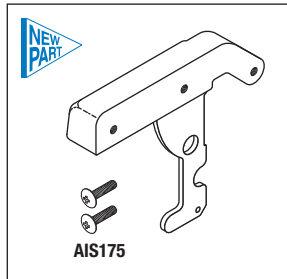

RPI Part #AIH152
OEM Part #MU12603 (Hinge Only) & 83 200 13 (Hinge Only)

HINGE (HOOD) REAR RIGHT

- Includes all parts as shown
- Also available: Hinge (Access Panel) Rear Right (RPI Part #AIH148) and Hinge Pin Kit (RPI Part #AIK167)

Fits: Hood Assembly
Model: C2000

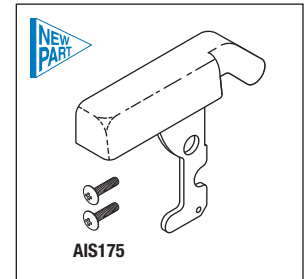

RPI Part #AIH149
OEM Part #MU12698 (Hinge Only) & 83 300 35 (Hinge Only)

HINGE (ACCESS PANEL) REAR LEFT

- Includes all parts as shown
- Also available: Hinge (Hood) Rear Left (RPI Part #AIH152) and Hinge Pin Kit (RPI Part #AIK167)

Fits: Access Panel
Model: C2000

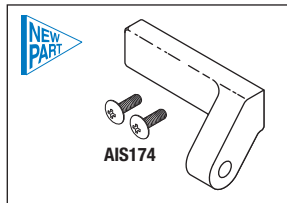

RPI Part #AIH148
OEM Part #MU12699 (Hinge Only) & 83 300 36 (Hinge Only)

HINGE (ACCESS PANEL) REAR RIGHT

- Includes all parts as shown
- Also available: Hinge (Hood) Rear Right (RPI Part #AIH153) and Hinge Pin Kit (RPI Part #AIK167)

Fits: Access Panel
Model: C2000

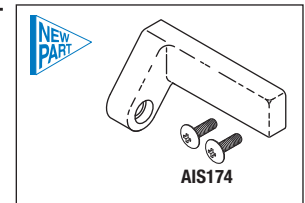

RPI Part #AIH147
OEM Part #MU12695 (Hinge Only) & 83 300 31 (Hinge Only)

HINGE (ACCESS PANEL) FRONT LEFT

- Includes all parts as shown
- Also available: Hinge (Hood) Front Left (RPI Part #AIH151) and Hinge Pin Kit (RPI Part #AIK167)

Fits: Access Panel
Model: C2000

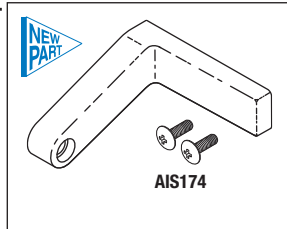

RPI Part #AIH146
OEM Part #MU12694 (Hinge Only) & 83 300 30 (Hinge Only)

HINGE (ACCESS PANEL) FRONT RIGHT

- Includes all parts as shown
- Also available: Hinge (Hood) Front Right (RPI Part #AIH150) and Hinge Pin Kit (RPI Part #AIK167)

Fits: Access Panel
Model: C2000

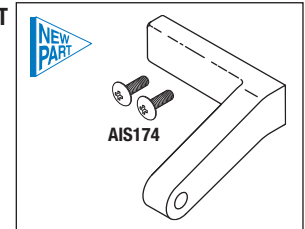

RPI Part #AIK167
OEM Part #MU15729 (Shoulder Screw Only) & 99 195 05 (Shoulder Screw Only)

HINGE PIN KIT

- Includes all parts as shown
- Fits:** Hood Assembly
Model: C2000

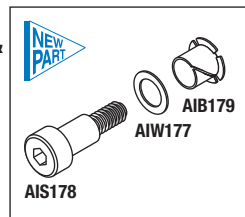

RPI Part #AIS178
OEM Part #MU15729 & 99 195 05

SHOULDER SCREW

- 2 per package
 - Material: Stainless steel supplied with pre-applied thread locker
 - Size: .250" dia. x .375" lg.; #10-24 Thread
- Model:** C2000

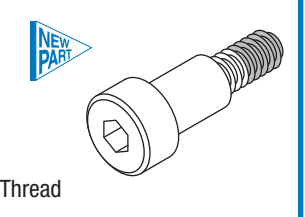

RPI Part #AIB179
OEM Part #MU12267 & 83 001 21

BEARING (FLANGED)

- 2 per package
 - Material: Nylon®
 - For .250" dia. shaft
- Model:** C2000

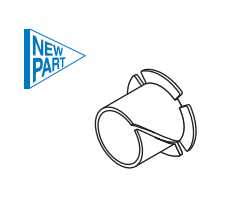

RPI Part #AIW177
OEM Part #MU15580 & 99 125 28

FLAT WASHER (1/4)

- 4 per package
 - Material: Nylon®
 - Size: .250" ID x .380" OD x .030" thk
- Model:** C2000

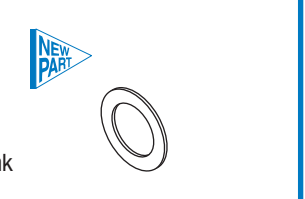

RPI Part #AIH143
OEM Part #MU08163 (Pivot Hinge Only),
68 510 05 (Pivot Hinge Only) &
83 300 08 (Pivot Hinge Only)

PIVOT HINGE (ACCESS DOOR)

- Includes all parts as shown
- Fits:** Hood Assembly
- Model:** C2000

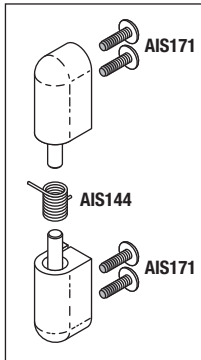

RPI Part #AIS144
OEM Part #MU08164 & 68 510 10

SPRING (TORSION)

- Material: Stainless steel
- .270" OD x .360" lg. x .030" dia. wire
- Also Included in: Pivot Hinge (Access Door) (RPI Part #AIH143)
- Fits:** Access Door Pivot Hinge
- Model:** C2000



RPI Part #AIS171
OEM Part #MU15131 & 99 023 64

SCREW (#6-32 x 7/16)

- 4 per package
- Material: Stainless steel supplied with pre-applied thread locker
- Size: #6-32 x 7/16" lg. Phillips Truss Head Screw
- Also included in: Pivot Hinge (Access Door) (RPI Part #AIH143)
- Model:** C2000

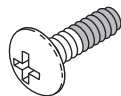

RPI Part #AIS175
OEM Part #MU15254 & 99 042 92

SCREW (#10-32 x 3/4)

- 2 per package
- Material: Stainless steel supplied with pre-applied thread locker
- Size: #10-32 x 3/4" lg. Phillips Truss Head Screw
- Also included in: Hinge (Hood) Front Right (RPI Part #AIH150), Hinge (Hood) Front Left (RPI Part #AIH151), Hinge (Hood) Rear Right (RPI Part #AIH152), Hinge (Hood) Rear Left (RPI Part #AIH153)
- Model:** C2000

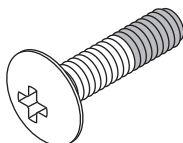

RPI Part #AIK160
OEM Part #MU08534 & 68 902 96

PAWL LATCH KIT

- Includes all parts as shown
- Fits:** Hood Assembly
- Model:** C2000

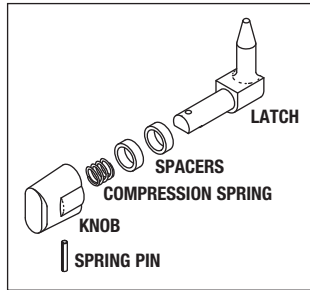

RPI Part #AIK161
OEM Part #MU13393 & 83 900 09

LATCH KIT (ACCESS DOOR)

- Includes all parts as shown
- Fits:** Hood Assembly
- Model:** C2000

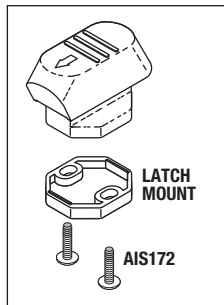

RPI Part #AIK162
OEM Part #MU12604 (Keeper Only) & 83 200 15 (Keeper Only)

KEEPER (ACCESS PNL LATCH)

- Includes all parts as shown
- Fits:** Hood Assembly
- Model:** C2000

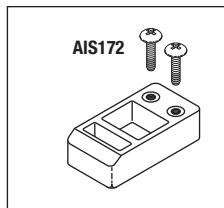

RPI Part #AIS172
OEM Part #MU15142 & 99 024 19

SCREW (#6-32 x 9/16)

- 2 per package
- Material: Stainless steel supplied with pre-applied thread locker
- Size: #6-32 x 9/16" lg. Phillips Truss Head Screw
- Also included in: Latch Kit (Access Door) (RPI Part #AIK161), Keeper (Access Pnl Latch) (RPI Part #AIK162) and Cable Clamp Kit (RPI Part #AIK163)
- Model:** C2000

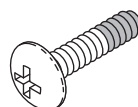

RPI Part #AIG020
OEM Part #MU12609 & 83 200 20

ACCESS GROMMET

- Material: Translucent thermoplastic rubber
- Fits:** Hood Assembly
- Model:** C2000

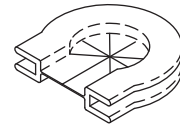

RPI Part #AIK163
OEM Part #MU11061 (Nylon Cable Clamp Only) & 81 020 20 (Nylon Cable Clamp Only)

CABLE CLAMP KIT

- Material: White Nylon® clamp
- Includes all parts as shown
- Fits:** Hood Assembly
- Model:** C2000

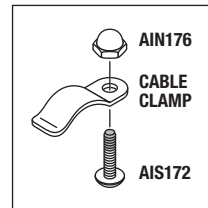

RPI Part #AIN176
OEM Part #MU15421 & 99 105 20

ACORN NUT (#6-32)

- 4 per package
- Material: Stainless steel
- Also included in: Cable Clamp Kit (RPI Part #AIK163)
- Model:** C2000



RPI Part #AIS174
OEM Part #MU15248 & 99 042 66

SCREW (#10-32 x 5/8)

- 2 per package
- Material: Stainless steel supplied with pre-applied thread locker
- Size: #10-32 x 5/8" lg. Phillips Truss Head Screw
- Also included in: Hinge (Access Panel) Front Right (RPI Part #AIH146), Hinge (Access Panel) Front Left (RPI Part #AIH147), Hinge (Access Panel) Rear Right (RPI Part #AIH148), Hinge (Access Panel) Rear Left (RPI Part #AIH149)
- Model:** C2000

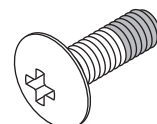

Infant Incubators

Model: Isolette® C2000 (Continued)

RPI Part #AIA154
OEM Part #MU12626 (Slide Only) & 83 200 45 (Slide Only)

SLIDE ASSY (SENSOR MODULE)

- Includes all parts as shown
- Fits:** Hood Assembly
- Model:** C2000

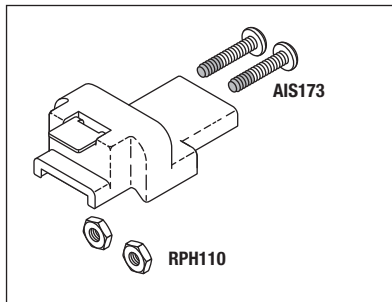

RPI Part #AIS173
OEM Part #MU15147 & 99 024 52

SCREW (#6-32 x 5/8)

- 2 per package
- Material: Stainless steel supplied with pre-applied thread locker
- Size: #6-32 x 5/8" lg. Phillips Pan Head Screw
- Also included in: Slide Assy (Sensor Module) (RPI Part #AIA154)

Model: C2000

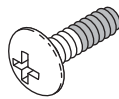

RPI Part #RPH110
OEM Part # (No OEM Part # Available)

HEX NUT (#6-32)

- 50 per package
- Material: Stainless steel
- Size: #6-32 Hex Nut
- Also included in: Hardware Kit (RPI Part #RPK402) and Slide Assy (Sensor Module) (RPI Part #AIA154)

Model: C2000



RPI Part #AIC155
OEM Part #MU13058 & 83 600 30

SCALE CABLE ASSEMBLY

- Length: ~39.5"
- Fits:** Weight Scale
- Model:** C2000

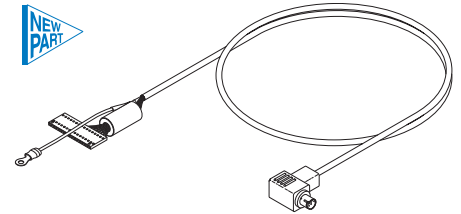

RPI Part #AIC142
OEM Part #MU12564 & 83 110 15

TUBING CAP

- 4 per package
- Material: White plastic
- Size: 1.00" OD
- Fits:** Mattress Tray Lift Bars
- Model:** C2000

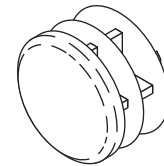

RPI Part #AIL145
OEM Part #MU12681 (Latch Only) & 83 300 09 (Latch Only)

LATCH (HEAT SHIELD)

- Includes all parts as shown
- Fits:** Hood Assembly
- Model:** C2000

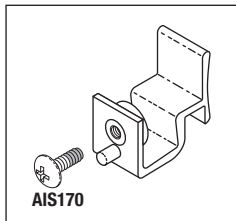

RPI Part #AIS170
OEM Part #MU15127 & 99 023 51

SCREW (#6-32 x 3/8)

- 2 per package
- Material: Stainless steel supplied with pre-applied thread locker
- Size: #6-32 x 3/8" lg. Phillips Truss Head Screw
- Also included in: Latch (Heat Shield) (RPI Part #AIL145)

Model: C2000

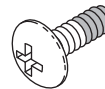

RPI Part #AIK164
OEM Part #MU07138 (Motor Mount Only) & 68 230 24 (Motor Mount Only)

MOTOR MOUNT KIT

- 4 per package
- Material: Rubber vibration mount, stainless steel hardware
- Includes all parts as shown

Fits: Chassis
Model: C2000

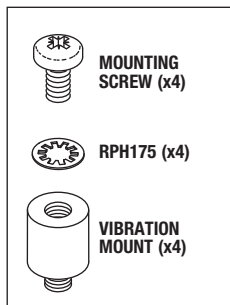

RPI Part #RPH175
OEM Part #MU15553 & 99 122 924

NO. 8 INTERNAL TOOTH WASHER

- 50 per package
- Size: #8
- Material: Stainless steel
- Type: Internal tooth lock washer
- Also included in: Lockwasher Kit (RPI Part #RPK413) and Motor Mount Kit (RPI Part #AIK164)

Model: C2000



RPI Part #AIS168
OEM Part #MU15296 (1 Pc only) & 99 055 96 (1 Pc only)

SCREW (1/4-20 x 1/2)

- 12 per package
- Material: Stainless steel supplied with pre-applied thread locker
- Size: 1/4-20 x 1/2" lg. Phillips Truss Head Screw

Fits: Chassis
Model: C2000

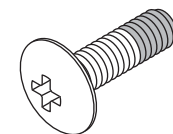

RPI Part #OMP006
OEM Part #6600-0208-700

SKIN TEMPERATURE PROBE (DISPOSABLE)

- Includes (10) probes and (10 pieces) Reflective Probe Cover (RPI Part #RPC619)
- Single use only
- 1/8" mono jack

Fits: Controller

Models: Care Plus 1000, 2000, 3000 & 4000, General Care (GC) & Infant Care (IC)

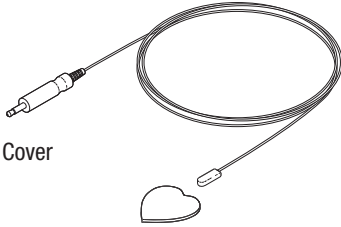

ALSO AVAILABLE BY THE CASE!

RPI Part #OMP007
OEM Part #6600-0196-700

SKIN TEMPERATURE PROBE (DISPOSABLE) - Case

- Includes: (50) probes and (50 pieces) Reflective Probe Cover (RPI Part #RPC619)

RPI Part #OMP008
OEM Part #6600-0628-700 & 0208-0697-700

SKIN TEMPERATURE PROBE (REUSABLE)

- 1/8" mono jack

Fits: Controller

Models: Care Plus 1000, 2000, 3000 & 4000, General Care (GC) & Infant Care (IC)

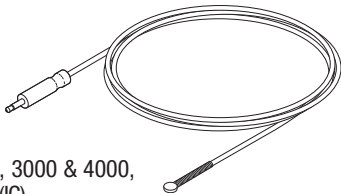

Reflective Probe Covers also available
- See RPI Part #RPC619

RPI Part #RPC619
OEM Part #0203-1980-300

REFLECTIVE PROBE COVER

- 100 per package; Single use only
- Metalized Mylar with PSA backing; Latex Free

Fits: Skin Temperature Probe

Models: All Infant Warmer and Incubator Skin Temperature Probes



RPI Part #OMP012
OEM Part #208-0161-300

SKIN TEMPERATURE PROBE (REUSABLE)

- 1/4" mono plug

Fits: Controller

Models: 190/190A

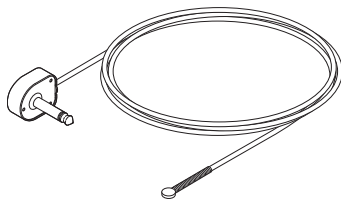

Reflective Probe Covers also available
- See RPI Part #RPC619

RPI Part #RPC619
OEM Part #0203-1980-300

REFLECTIVE PROBE COVER

- 100 per package; Single use only
- Metalized Mylar with PSA backing; Latex Free

Fits: Skin Temperature Probe

Models: All Infant Warmer and Incubator Skin Temperature Probes



RPI Part #0MK040
OEM Part #6600-0048-850

CALIBRATION KIT

- Use to calibrate Humidity Sensor
- Solution usable for up to 1 year after mixing
- Includes: Vial with sodium chloride and rubber elbow

Fits: Humidity Sensor

Models: Care Plus 1000, 2000, 3000 & 4000

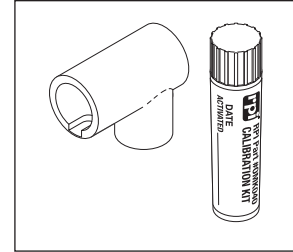

RPI Part #0MF013
OEM Part #0217-2871-600

AIR FILTER

- 5 per package; ~9" x 13-1/4"
- Synthetic media (Does not contain glass fibers)
- Latex free

Fits: Filter Housing

Models: General Care (GC) & Infant Care (IC)

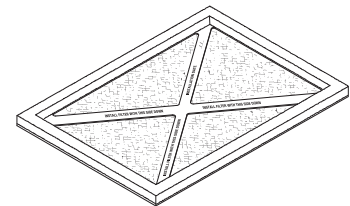

RPI Part #0MF016
OEM Part #6600-0105-300

MICRO FILTER

- ~6" x 11"
- Synthetic media (Does not contain glass fibers)
- Latex free

Fits: Filter Housing

Models: Care Plus 1000 & 2000

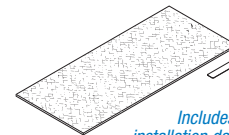

Includes installation date label

RPI Part #0MF014
OEM Part #6600-0043-800

MICRO FILTER

- ~6-3/4" x 11-5/8"
- Synthetic media (Does not contain glass fibers)
- Latex free

Fits: Filter Housing

Models: 190, 190A, Care Plus 3000 & 4000

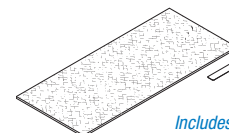

Includes installation date label

RPI Part #OMP009
OEM Part #6600-0873-700

SKIN TEMPERATURE PROBE (DISPOSABLE)

- Single use only
- 3 pin connector
- Includes: (10) probes and (10 pieces) Reflective Probe Cover (RPI Part #RPC619)

Fits: Probe Panel

Models: Giraffe OmniBed & Giraffe Incubator

ALSO AVAILABLE BY THE CASE!

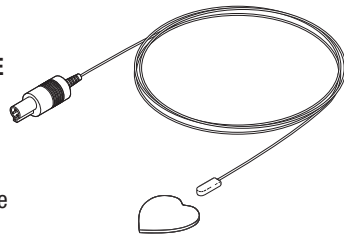

RPI Part #OMP010
OEM Part #6600-0874-700

SKIN TEMPERATURE PROBE (DISPOSABLE) - CASE of 50

- Includes: (50) probes and (50 pieces) Reflective Probe Cover (RPI Part #RPC619)

RPI Part #OMP011
OEM Part #6600-0875-700

SKIN TEMPERATURE PROBE (REUSABLE)

- 3 pin connector
- Also available: Reflective Probe Covers (RPI Part #RPC619)

Fits: Probe Panel

Models: Giraffe OmniBed & Giraffe Incubator

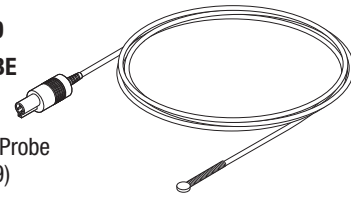

RPI Part #RPC619
OEM Part #0203-1980-300

REFLECTIVE PROBE COVER

- 100 per package; Single use only
- Metalized Mylar with PSA backing; Latex Free

Fits: Skin Temperature Probe

Models: All Infant Warmer and Incubator Skin Temperature Probes



RPI Part #OMF015
OEM Part #6600-0207-850

MICRO FILTER

- 10 per package
- 1-1/2" x 5-1/2"
- Synthetic media (Does not contain glass fibers); Latex free
- RPI Advantage! PM Sticker is included for recording date that Filter was replaced.

Fits: Filter Housing

Models: Giraffe OmniBed & Giraffe Incubator

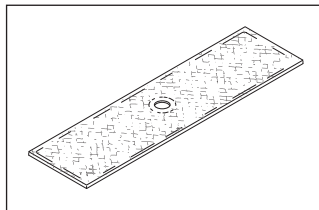

RPI Part #OMG017
OEM Part #6600-1248-500

CORNER GROMMET

- Material: Translucent thermoplastic rubber

Fits: End Panel

Models: Giraffe OmniBed & Giraffe Incubator

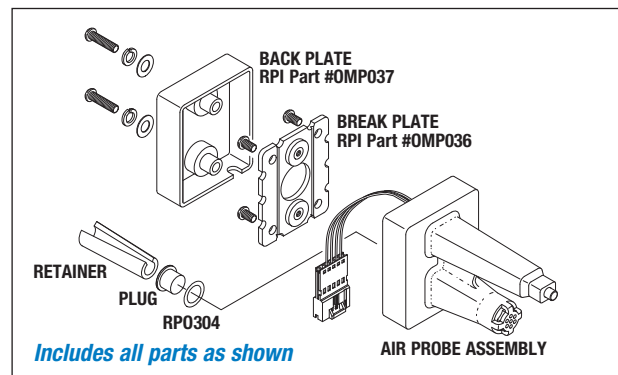
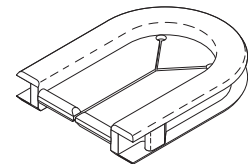

RPI Part #OMP018
OEM Part #6600-1512-700

COMPARTMENT AIR PROBE

- Also available: Humidity Sensor (RPI Part #OMS038)

Fits: Rear Wall Panel

Models: Giraffe OmniBed & Giraffe Incubator

RPI Part #OMP036
OEM Part #6600-1473-500 (Break Plate Only)/6600-0706-406 (Screw Only)

BREAK PLATE

- Includes all parts as shown
- Included in: Compartment Air Probe (RPI Part #OMP018)

Fits: Compartment Air Probe

Models: Giraffe OmniBed & Giraffe Incubator

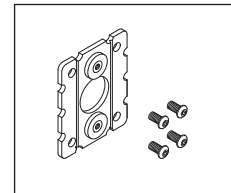

RPI Part #OMP037
OEM Part #6600-1474-500

BACK PLATE

- Includes all parts as shown
- Included in: Air Compartment Probe (RPI Part #OMP018)

Fits: Compartment Air Probe

Models: Giraffe OmniBed & Giraffe Incubator

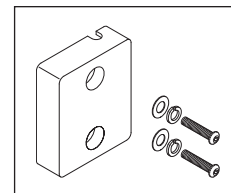

RPI Part #OMS038
OEM Part #6600-0784-700 (Sensor Only)/6600-0540-400 (O-ring Only)/6600-1475-500 (Retainer Only)

HUMIDITY SENSOR

- Includes all parts as shown
- Also available: Calibration Kit (RPI Part #OMK040) and Compartment Air Probe (RPI Part #OMP018)

Fits: Compartment Air Probe

Models: Giraffe OmniBed & Giraffe Incubator

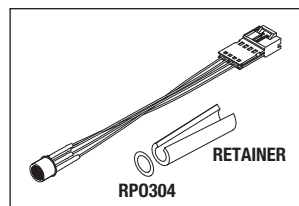

RPI Part #OMK040
OEM Part #6600-0048-850

CALIBRATION KIT

- Use to calibrate Humidity Sensor (RPI Part #OMS038)
- Solution usable for up to 1 year after mixing
- Includes: Vial with sodium chloride and rubber elbow

Fits: Humidity Sensor

Models: Giraffe OmniBed & Giraffe Incubator

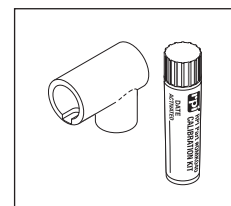

Infant Incubators

Models: Giraffe® Incubator & Giraffe® OmniBed®

Includes all parts as shown

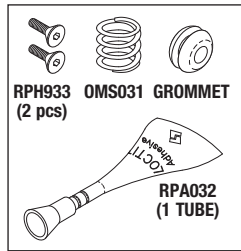
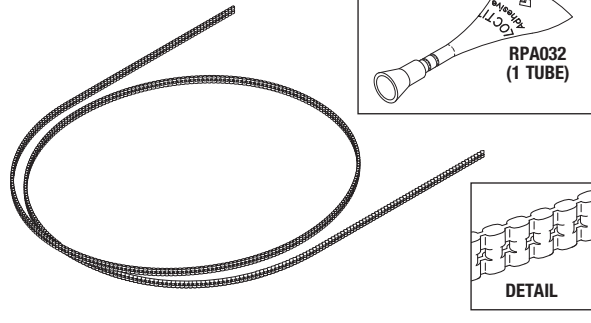

RPI Part #OMB030
OEM Part #6600-1372-500 (Lift Belt Only)/**6600-1071-400** (Belt Tensioner Spring Only)/**6600-1187-400** (Grommet Only)

LIFT BELT

- Length: 75"; Pitch: 0.1475"; Width: 0.23"
 - Material: Molded polyurethane with twin stainless steel cores
 - Also available: Belt Block Kit (RPI Part #OMK060), Arrow Clip (RPI Part #RPC902), and Buoyancy Spring Kit (Right) (RPI Part #OMK057)
- Fits:** Lift Rail Belt Channel (Right)
Models: Giraffe OmniBed

RPI Part #OMS031
OEM Part #6600-1071-400

BELT TENSIONER SPRING

- Size: .54"OD x .75" lg. x .06" wire
 - Material: Stainless steel
 - Included in: Lift Belt (RPI Part #OMB030)
- Fits:** Lift Belt/Lift Rail Channel
Models: Giraffe OmniBed



Includes all parts as shown

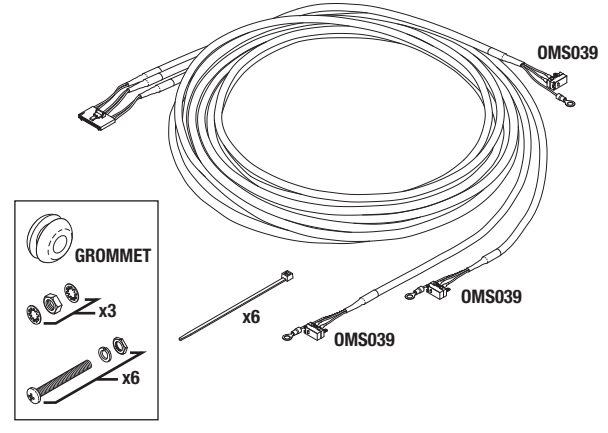

RPI Part #OMH032
OEM Part #6600-0718-700/6600-1187-400 (Grommet Only)

HOOD HARNESS

Fits: Lift Rail Cable Channel
Models: Giraffe OmniBed

RPI Part #OMS039
OEM Part #6600-0718-700 (Complete Hood Harness)/**6600-1187-400** (Grommet Only)

MICROSWITCH

- 0.1 A @ 48VAC; SPDT
 - Includes: Mounting hardware, shrink tubing, and heater door opening rod grommet
 - Included in: Hood Harness (RPI Part #OMH032)
 - Replace the complete Hood Harness (RPI Part #OMH032) or just replace the Microswitches, you decide - it's the RPI advantage!
- Fits:** Hood Harness/Lift Rail Channel
Models: Giraffe OmniBed

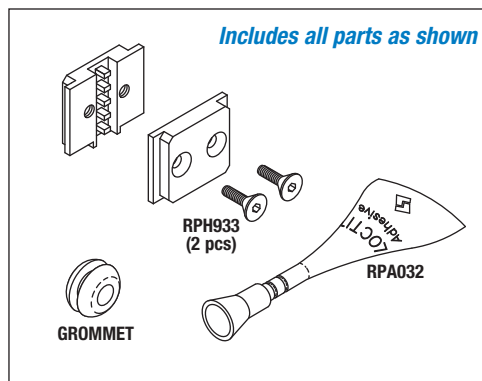
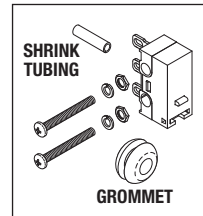

RPI Part #OMK060
OEM Part #6600-1357-500 (Belt Adjuster, Bottom only), **6600-1358-500** (Block Adjuster, Top only), **6600-1151-400** (Screw, M3 x 10 only) & **6600-1187-400** (Grommet only)

BELT BLOCK KIT

- Material: Brass
 - Includes: Belt Block Set, (2 pcs) Screw (M3 x 10) (RPI Part #RPH933), Grommet, and (1 Tube) Threadlocker 242 (RPI Part #RPA032)
 - Also available: Lift Belt (RPI Part #OMB030)
- Fits:** Lift Belt
Models: Giraffe OmniBed

RPI Part #RPA032
OEM Part #6600-1357-500 (Belt Adjuster, Bottom only), **6600-1358-500** (Block Adjuster, Top only) & **6600-1151-400** (Screw, M3 X 10 only)

THREADLOCKER 242

- 5 per package; .02 fl. oz. (.5ml) per tube
 - Prevents rust and corrosion
 - Removable adhesive by Loctite®
 - MSDS available on RPI website
- Fits:** Lift Belt
Models: Giraffe OmniBed

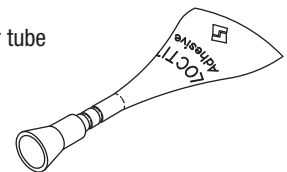

RPI Part #RPH933
OEM Part # (No OEM Part # Available)

SCREW (M3 x 10mm S/S Flat Hd. Allen) - 25/PKG

- Material: Stainless steel
- Fits:** Belt Block
Models: Giraffe Incubator & Giraffe OmniBed



RPI Part #RPC902
OEM Part #6600-1056-400

ARROW CLIP - 6/ PKG

- Hole dia.: .250"; Material: Nylon
 - Size: .50" dia. head x .57" lg.
- Fits:** Soffit
Models: Giraffe OmniBed



Includes all parts as shown

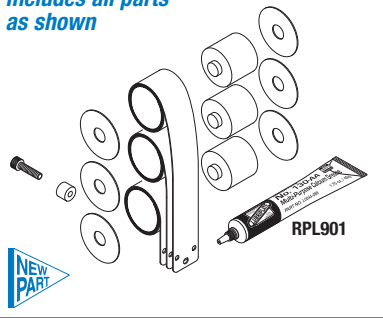

RPI Part #OMK058
OEM Part #6600-1708-500 (Delrin Washer only), **6600-1464-500** (Upper Buoyancy Spring only), **6600-1465-500** (Lower Buoyancy Spring only), **6600-1725-500** (Left Buoyancy Spring only), **6600-1103-400** (Spacer only), **6600-1152-400** (Screw only) & **6600-1317-500** (Spring Spool only)

BUOYANCY SPRING KIT (LEFT)

- Includes: Upper Buoyancy Spring, Lower Buoyancy Spring, Left Buoyancy Spring, Spacer, Screw (M5 x 20), (6) Delrin Washers, (3) Spring Spools and Lubriplate (130AA) (RPI Part #RPL901)

Fits: Left Upright

Models: Giraffe OmniBed



RPI Part #RPL901
OEM Part #0616-0203-300 (10 oz. Tube)

LUBRIPLATE® (130AA)

- 1.75 oz. resealable tube
- MSDS available on RPI website
- Included in: Buoyancy Spring Kit (Right) (RPI Part #OMK057) and Buoyancy Spring Kit (Left) (RPI Part #OMK058)

Models: Giraffe Incubator & Giraffe OmniBed

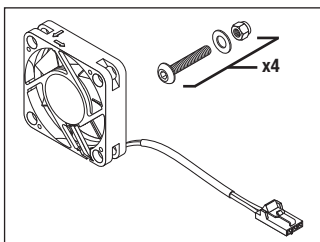

RPI Part #OMF024
OEM Part #6600-1523-700

COOLING FAN

- Size: 1.575" x 1.575" x .41" fan housing
- 6.0-13.8 VDC; 5800 RPM
- Includes: Mounting hardware

Fits: Heat Sink Vent

Models: Giraffe OmniBed & Giraffe Incubator

Includes all parts as shown

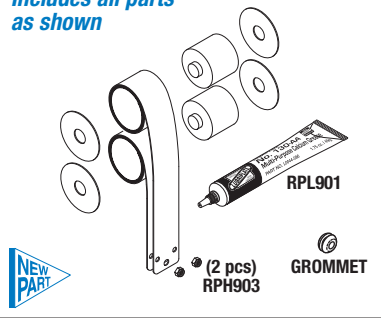

RPI Part #OMK057
OEM Part #6600-1708-500 (Delrin Washer only), **6600-1464-500** (Upper Buoyancy Spring only), **6600-1465-500** (Lower Buoyancy Spring only), **6600-1317-500** (Spring Spool only), **6600-1187-400** (Grommet only) & **6600-0714-401** (Lock Nut only)

BUOYANCY SPRING KIT (RIGHT)

- Includes: Upper Buoyancy Spring, Lower Buoyancy Spring, (4) Delrin Washers, (2) Spring Spools, (2) Lock Nuts (M3) (RPI Part #RPH903), Lubriplate (130AA) (RPI Part #RPL901), and Grommet

Fits: Right Upright (Motor Side)

Models: Giraffe OmniBed



RPI Part #RPH903
OEM Part # (No OEM Part # Available)

LOCKNUT (M3 - Nylok®)

- 10 per package
- Size: M3
- Material: Stainless steel with nylon insert
- Included in: Buoyancy Spring Kit (Right) (RPI Part #OMK057)

Models: Giraffe Incubator & Giraffe OmniBed

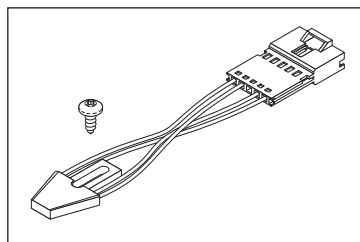

RPI Part #OMS019
OEM Part #6600-0820-700 (Sensor Only)/
6600-0709-405 (Screw Only)

AIR FLOW SENSOR

- IR Emitter / Detector pair
- Includes all parts as shown

Fits: Lower Chassis

Models: Giraffe OmniBed & Giraffe Incubator

Includes all parts as shown

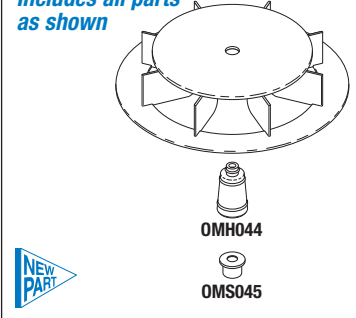

RPI Part #OMK046
OEM Part #6600-1738-500 (Fan Blade only) & **6600-1440-500** (Hub only)

FAN AND HUB KIT

- Includes: Fan Hub (RPI Part #OMH044), Fan Seal (RPI Part #OMS045), and Fan Blade

Fits: Fan Motor Shaft

Models: Giraffe Incubator & Giraffe OmniBed

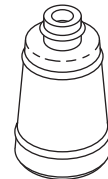

RPI Part #OMH044
OEM Part #6600-1440-500

FAN HUB

- Material: Gray rubber
- Included in: Fan and Hub Kit (RPI Part #OMK046)

Fits: Fan Blade

Models: Giraffe Incubator & Giraffe OmniBed



RPI Part #OMS045
OEM Part #6600-1557-500

FAN SEAL

- Material: Black Silicone Rubber
- Included in: Fan and Hub Kit (RPI Part #OMK046)

Fits: Fan Motor Shaft

Models: Giraffe Incubator & Giraffe OmniBed



RPI Part #RPC902
OEM Part #6600-1056-400

ARROW CLIP

- 6 per package
- Hole dia.: .250"
- Material: Nylon
- Size: .50" dia. head x .57" lg.

Fits: Soffit

Models: Giraffe OmniBed

Infant Incubators

Models: Giraffe® Incubator & Giraffe® OmniBed®

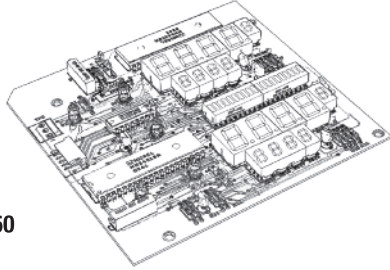

RPI Part #OMB056
OEM Part #6600-0215-850

LED PC BOARD
Fits: Display Module
Models: Giraffe Incubator & Giraffe OmniBed

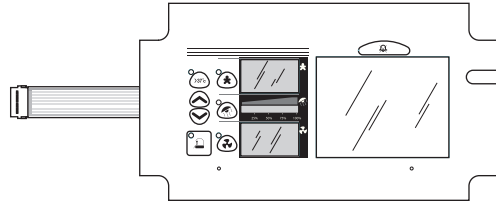

*For Use With
OmniBed!*

RPI Part #OMP021
OEM Part #6600-1007-700

TOUCH PANEL ASSEMBLY
• Size: 7.12" x 13"
• For use with OmniBed
Fits: Display Module
Models: Giraffe OmniBed

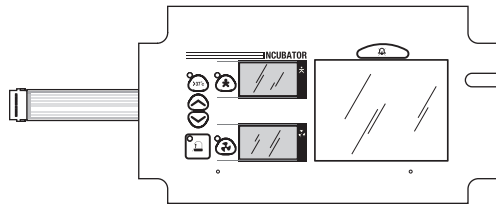

*For Use With
Incubator!*

RPI Part #OMP022
OEM Part #6600-1254-600

TOUCH PANEL ASSEMBLY
• Size: 7.12" x 13"
• For use with Incubator
Fits: Display Module
Models: Giraffe Incubator



RPI Part #OMS025
OEM Part #6600-0736-701
CANOPY LIFT SWITCH (LEFT)
Fits: Upper Chassis
Models: Giraffe OmniBed



RPI Part #OMS026
OEM Part #6600-0736-702
CANOPY LIFT SWITCH (RIGHT)
Fits: Upper Chassis
Models: Giraffe OmniBed

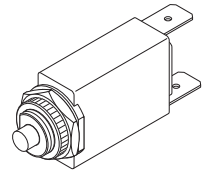

RPI Part #OMB035
OEM Part #6600-0562-603

CIRCUIT BREAKER (3.5A)
• 3.5 Amps
• 1/4" Tabs
• Includes: Mounting hardware
Fits: Connection Panel
Models: Giraffe OmniBed & Giraffe Incubator

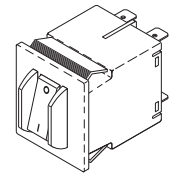

RPI Part #OMS034
OEM Part #6600-1014-602

POWER SWITCH/CIRCUIT BREAKER
• Rocker switch (on-off)
• 12A @ 125/250VAC; DPST; Trip amps: 16.2
• Black switch body with white legend: I/O
• 1/4" Tabs
Fits: Lower Electrical Enclosure
Models: Giraffe OmniBed & Giraffe Incubator

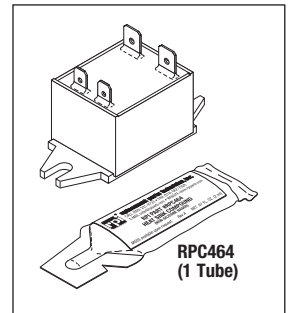

RPI Part #OMR033
OEM Part #6600-1003-600

SOLID STATE RELAY
• Size: 1.20" x 1" x .90"; 1/4" Tabs
• 12A @ 24-280VAC; SPST-N.O.
• Control voltage: 3-30 VDC
• Includes all parts as shown
Fits: Electrical Enclosure
Models: Giraffe OmniBed & Giraffe Incubator

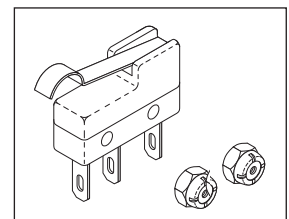

RPI Part #OMS023
OEM Part #6600-1154-600 (Switch Only)/
6600-1165-400 (Locking Nut Only)

DOOR SWITCH
• 1A @ 125VAC; SPDT; 1/8" Tabs
• Includes: Mounting hardware
Fits: Heater Doors
Models: Giraffe OmniBed

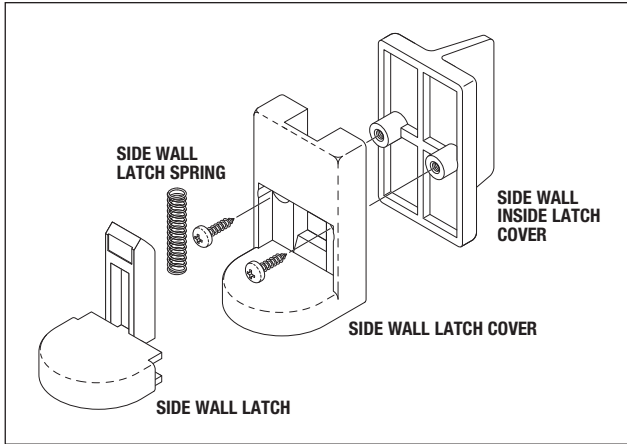

RPI Part #OMK028
OEM Part #6600-1406-500 (Inside Latch Cover only) /
6600-1403-500 (Side Wall Latch only) / **6600-1405-500**
 (Latch Spring only) / **6600-1404-500** (Latch Cover only)

SIDE WALL LATCH KIT

- Includes all parts as shown
- Fits:** Side Wall
- Models:** Giraffe OmniBed & Giraffe Incubator

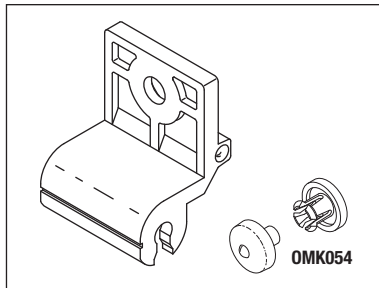

RPI Part #OMK053
OEM Part #6600-1149-500 (Side Wall Hinge only), **6600-1436-500**
 (Wall Hinge Snap only) & **6600-1429-500** (Wall Hinge Post only)

SIDE WALL HINGE KIT

- Includes: Side Wall Hinge, and Wall Hinge & Post Kit (RPI Part #OMK054)
- Fits:** Hood Assembly
- Models:** Giraffe Incubator & Giraffe OmniBed

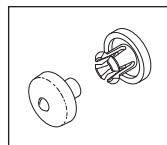

RPI Part #OMK054
OEM Part #6600-1436-500 (Wall Hinge Snap only) &
6600-1429-500 (Wall Hinge Post only)

WALL HINGE & POST KIT

- Included in: Side Wall Hinge Kit (RPI Part #OMK053)
- Fits:** Side Wall Hinge and Hood Assembly
- Models:** Giraffe Incubator & Giraffe OmniBed

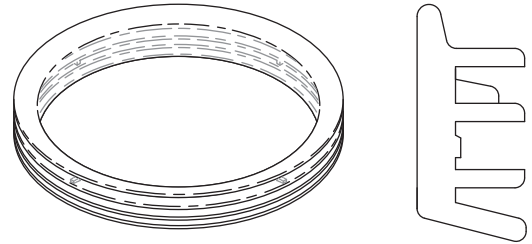

RPI Part #OMS052
OEM Part #6600-1249-500

PORTHOLE SEAL

- Material: Translucent thermoplastic rubber
- Fits:** Hood Assembly
- Models:** Giraffe Incubator & Giraffe OmniBed

OMS052
 CROSS SECTION
 SHOWN ACTUAL SIZE



RPI Part #OMD051
OEM Part #6600-1238-500

PORTHOLE DOOR

- Material: Clear plastic
- Fits:** Hood Assembly
- Models:** Giraffe Incubator & Giraffe OmniBed

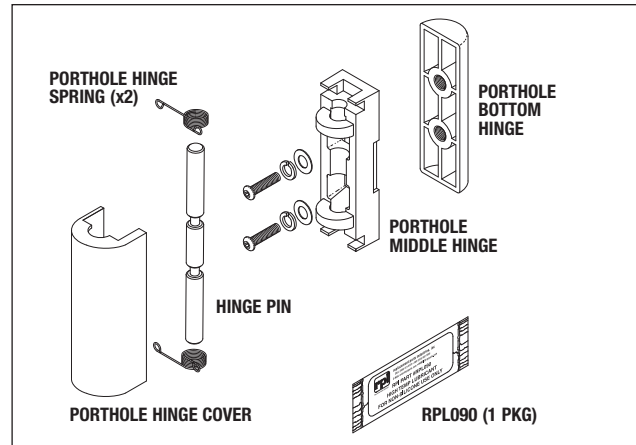
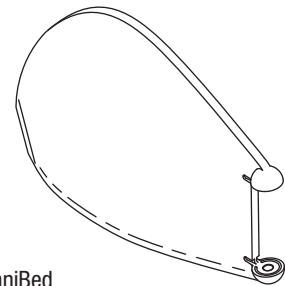

RPI Part #OMK029
OEM Part #6600-1239-500 (Hinge Bottom only) / **6600-1242-500** (Hinge Cover only) / **6600-1240-500** (Middle Hinge only) / **6600-1041-400** (Hinge Pin only) / **6600-1040-400** (Left Spring only) / **6600-1026-400** (Right Spring only)

PORTHOLE HINGE KIT

- Includes all parts as shown
- Fits:** Side Panels
- Models:** Giraffe OmniBed & Giraffe Incubator

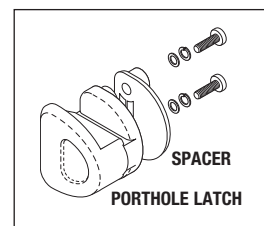

RPI Part #OMK027
OEM Part #6600-0738-700

PORTHOLE LATCH ASSEMBLY KIT

- Includes all parts as shown
- Fits:** Side and Front Panels
- Models:** Giraffe OmniBed & Giraffe Incubator

Infant Incubators

Models: Giraffe® Incubator & Giraffe® OmniBed®

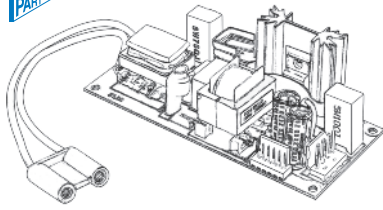

RPI Part #OMB061
OEM Part #6600-0248-850

BALLAST (50W REGULATED)

- 50 VDC, 50 W
- Used with 50W Solarc™ lamp only
- Also available: Lamp (52V, 50W) (RPI Part #LMP029)

Fits: Chassis

Models: Giraffe Spot PT Lite

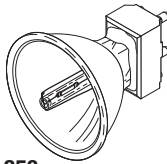

RPI Part #LMP029
OEM Part #6600-0235-850

LAMP (52VDC, 50W)

- Metal Halide Solarc™ brand
- 2 Pin
- Also available: Ballast (50W regulated) (RPI Part #OMB061)

Fits: Lamp Ballast

Models: Giraffe Spot PT Lite

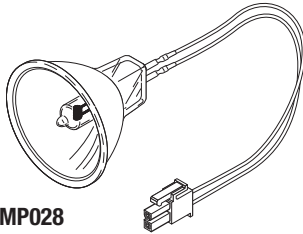

RPI Part #LMP028
OEM Part #6600-0680-200

LAMP (12VDC, 100W)

- 6 per package
- Includes: Attached wire harness and connector
- Halogen

Fits: Lamp holder

Models: Biliblanket Plus & Biliblanket Plus High Output

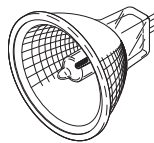

RPI Part #LMP027
OEM Part #6600-0912-200
Industry Part #EXT

LAMP

- 12V, 50W
- Base: 2-Pin; Type: Halogen; EXT

Fits: Exam Light

Models: Giraffe Exam Light, Giraffe OmniBed & Giraffe Incubator

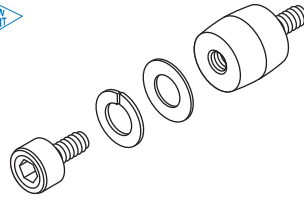

INCLUDES (6) OF EACH PART SHOWN

RPI Part #OMK050

OEM Part #6600-1099-400 (Isolator Only),
6600-0712-403 (Flat Washer Only), **6600-0713-403** (Lock Washer Only) & **6600-0707-407** (Screw Only)

LIFT MOTOR ISOLATOR KIT

- 6 per package
- Size: .39" (10mm) Dia x .39" (10mm) Ht.
- Includes: (6) Lift Motor Isolators, and mounting hardware

Fits: Right Hand Upright

Models: Giraffe OmniBed

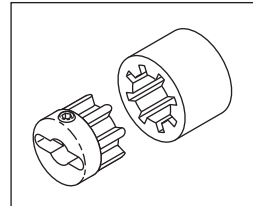

RPI Part #OMC049
OEM Part #6600-1176-400

GEARBOX COUPLER

- Includes: Cross-Clamp Hub, and Urethane Gear Grip Sleeve

Fits: Lift Motor

Models: Giraffe OmniBed

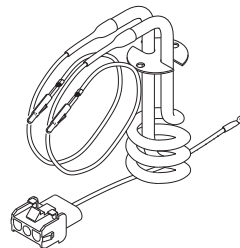

RPI Part #OMH005
OEM Part #6600-0220-850

HEATING ASSEMBLY

- 460W, 99VAC, ~21Ω
- Includes Connector and Ground Wire Assembly

Fits: Hood Assembly

Models: Giraffe OmniBed & Giraffe Incubator

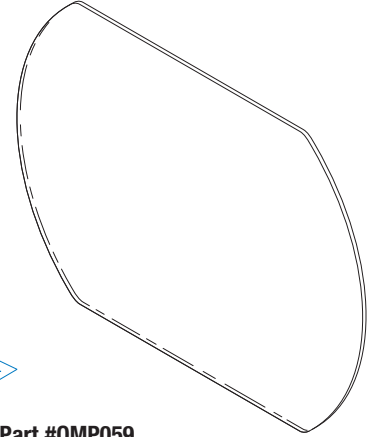

RPI Part #OMP059
OEM Part #6600-1365-500

PLATE

- Size: 25.75" x 19.25" x .13" Thk.
- Material: Clear plastic

Fits: Bed Assembly

Models: Giraffe Incubator & Giraffe OmniBed

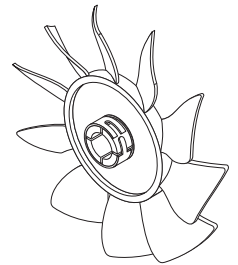

RPI Part #OMF043
OEM Part #6600-1433-500

FAN BLADE

- Size: 2.25" dia.
- Includes: Spring clip

Fits: Fan motor

Models: Giraffe Incubator & Giraffe OmniBed

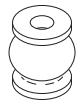

RPI Part #OMM047
OEM Part #6600-1000-400

MOTOR MOUNT

- 4 per package
- Size: .59" dia. x .63" Ht.

Fits: Fan Motor Bracket

Models: Giraffe Incubator & Giraffe OmniBed

RPI Part #AIM021
OEM Part #17 776 59

PANEL METER

- 120V
- Range: 0, 1/4, 1/2, 3/4, Full
- Includes mounting bracket

Fits: Controller Front Panel
Model: ICS

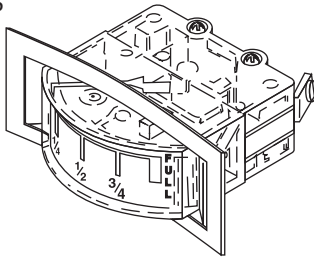

RPI Part #AIS049
OEM Part #17 681 61

SLIDE SWITCH

- DPST
- 6A AC, 0.5A DC @ 125V
- #6 clearance mounting holes

Fits: Servo Controller (SC78-1)
Model: ICS

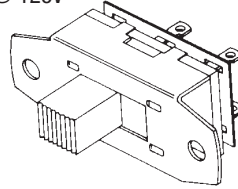

RPI Part #AIS050
OEM Part #17 681 88

SLIDE SWITCH

- DPST
- 6A AC, 0.5A DC @ 125V
- #6-32 mounting holes

Fits: Servo Controller (SC78-2)
Model: ICS

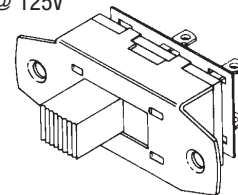

RPI Part #AIH039
OEM Part #78 902 70

HEATING ELEMENT

- ~10.50" lg.
- 560W, 120VAC, ~25Ω
- Includes all parts as shown

Fits: Heating Element Retainer
Model: ICS

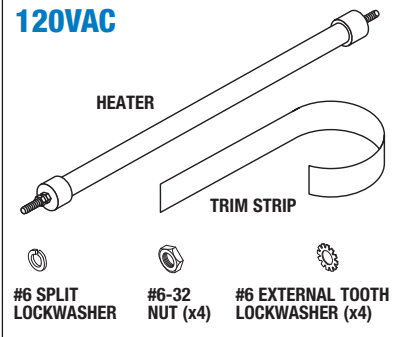

RPI Part #AIS042
OEM Part #17 724 32

BULB SOCKET

- Includes mounting hardware
- 5/16-32 lens thread
- 3/8-32 mounting thread
- 1/8" tabs

Fits: Servo Controller Panel
Model: ICS

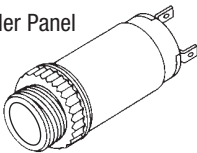

RPI Part #AIH100
OEM Part #78 200 44

HEATING ELEMENT

- ~10.50" lg.
- 560W, 220VAC, ~84Ω
- Includes all parts as shown

Fits: Heating Element Retainer
Model: ICS

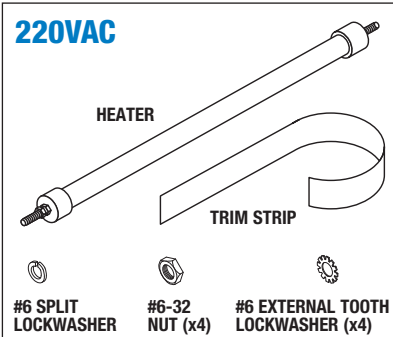

RPI Part #AIB041
OEM Part #17 806 45
Industry Part #GE345

BULB

- T-1-3/4 midget flanged
- 6VDC, .04A

Fits: Bulb socket
Model: ICS



RPI Part #AIS051
OEM Part #17 681 33

SLIDE SWITCH

- SPST
- 1A@125VDC; 6A@125VAC; 3A@250VAC
- #6 clearance mounting holes

Fits: Servo Controller (SC78-1)
Model: ICS

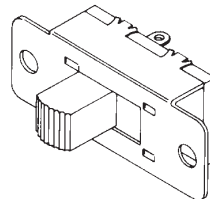

RPI Part #AIS052
OEM Part #17 681 87

SLIDE SWITCH

- DPDT
- 3A AC, 0.5A DC @ 125V
- #6-32 mounting holes

• Momentary
Fits: Servo Controller (SC78-2)
Model: ICS

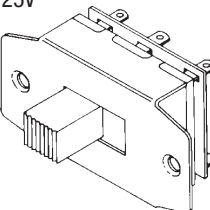

RPI Part #AIC043
OEM Part #17 806 44

LENS CAP (WHITE)

- .33" OD
- 5/16-32 thread

Fits: Bulb Socket
Model: ICS

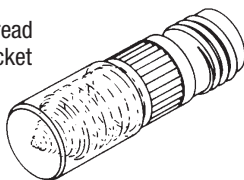

RPI Part #AIC044
OEM Part #17 806 46

LENS CAP (RED)

- .33" OD
- 5/16-32 thread

Fits: Bulb Socket
Model: ICS

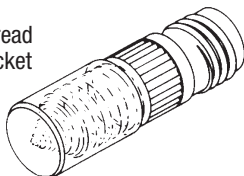

RPI Part #AIP063
OEM Part #17 575 14

SKIN TEMPERATURE PROBE (REUSABLE)

- 1/4" stereo phono plug

Fits: Controller
Model: ICS

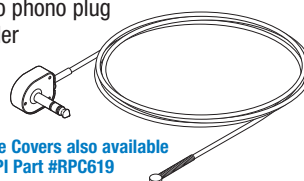

Reflective Probe Covers also available
- See RPI Part #RPC619

RPI Part #RPC619
OEM Part #MU06944 & 68 209 48

REFLECTIVE PROBE COVER

- 100 per package
 - Single use only
 - Metalized Mylar with PSA backing; Latex Free
- Fits:** Skin Temperature Probe
Models: All Infant Warmer and Incubator Skin Temperature Probes



Infant Warmers

Model: 7810 (Radiant Warmer), 7820 (Radiant Warmer), 7830 (Radiant Warmer), 7840 (Radiant Warmer) & IICS (PM 78-1)

RPI Part #AIH040
OEM Part #MU09712, 78 263 00 & 78 263 10

HEATING ELEMENT

- ~15" lg.
- 600W, 120VAC, ~24Ω

Fits: Heater Socket Assembly

Models: 7810 (Radiant Warmer), 7820 (Radiant Warmer), 7830 (Radiant Warmer), 7840 (Radiant Warmer) & IICS (PM 78-1)

120VAC

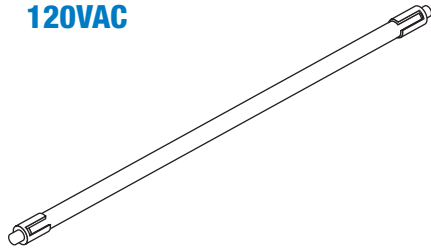

RPI Part #AIH094
OEM Part #MU09713, 78 263 11 & 78 263 01

HEATING ELEMENT

- ~15" lg.
- 600W, 220VAC, ~96Ω

Fits: Heater Socket Assembly

Models: 7810 (Radiant Warmer), 7820 (Radiant Warmer), 7830 (Radiant Warmer), 7840 (Radiant Warmer) & IICS (PM 78-1)

220VAC

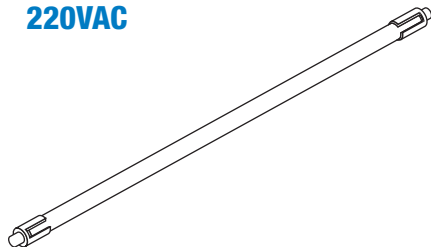

RPI Part #AIA055
OEM Part #MU10688 & 78 931 82

HEATER SOCKET ASSEMBLY

- Ceramic socket
- ~5-1/2" lg. wire

Fits: Heater/Reflector Assembly

Models: 7810 (Radiant Warmer), 7820 (Radiant Warmer), 7830 (Radiant Warmer), 7840 (Radiant Warmer) & IICS (PM 78-1)

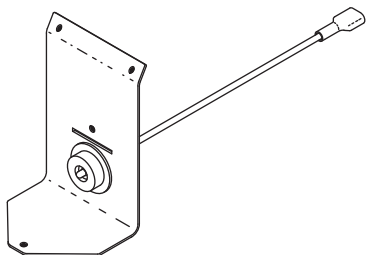

RPI Part #AIP080
OEM Part #MU06933 & 68 209 20

SKIN TEMPERATURE PROBE (DISPOSABLE)

- Includes (10) probes and (10) pieces Reflective Probe Cover (RPI Part #RPC619)
- Single use only
- 3 pin din connector

Fits: Controller

Models: 7810 (Radiant Warmer), 7820 (Radiant Warmer), 7830 (Radiant Warmer), 7840 (Radiant Warmer) & IICS (PM 78-1)

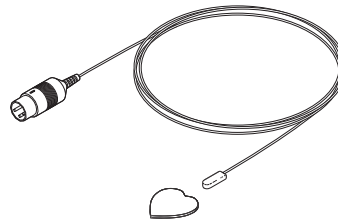

ALSO AVAILABLE BY THE CASE
RPI Part #AIP101 - 100/CASE
OEM Part #38 209 30 / MU06935

RPI Part #AIP064
OEM Part #MU06951 & 68 209 70

SKIN TEMPERATURE PROBE (REUSABLE)

- 3 pin din connector

Fits: Controller

Models: 7810 (Radiant Warmer), 7820 (Radiant Warmer), 7830 (Radiant Warmer), 7840 (Radiant Warmer) & IICS (PM 78-1)

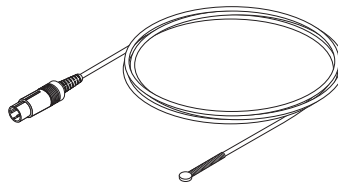

Reflective Probe Covers also available - See RPI Part #RPC619

RPI Part #RPC619
OEM Part #MU06944 & 68 209 48

REFLECTIVE PROBE COVER

- 100 per package
- Single use only
- Metalized Mylar with PSA backing; Latex Free

Fits: Skin Temperature Probe

Models: All Infant Warmer and Incubator Skin Temperature Probes



RPI Part #AIRO13
OEM Part #MU08571, MU08572, 17 652 78, 68 903 83 & 68 903 84

RELAY

- Contacts: 10A @ 24-280VAC
- Input: 3-32VDC
- Size: ~2.25" L x 1.75" W x .78" H
- Includes built-in LED Input Status Indicator

Fits: Controller

Models: 7810 (Radiant Warmer), 7820 (Radiant Warmer), 7830 (Radiant Warmer), 7840 (Radiant Warmer) & IICS (PM 78-1)

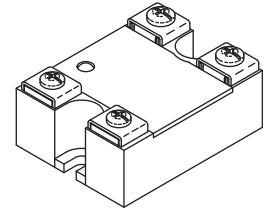

RPI Part #AIS047
OEM Part #MU3291 & 17 682 63

ROCKER SWITCH

- DPST
- 22A @ 125VAC; 16A @ 250VAC
- .250" tabs
- Color: Black

Fits: Basic Assembly

Models: 7810 (Radiant Warmer), 7820 (Radiant Warmer), 7830 (Radiant Warmer), 7840 (Radiant Warmer) & IICS (PM 78-1)

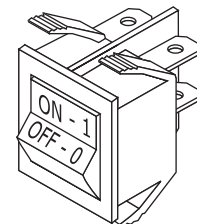

RPI Part #LMP014
OEM Part #MU03690 & 17 807 41

LAMP

- 12V, 50W
- Base: 2-pin
- Type: Halogen; EXN

Fits: Connector Assembly

Models: 7810 (Radiant Warmer), 7820 (Radiant Warmer), 7830 (Radiant Warmer), 7840 (Radiant Warmer) & IICS (PM 78-1)

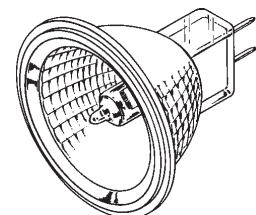

Model: Resuscitaire® RW82-1

RPI Part #AIH097
OEM Part #MU11222 & 81 202 70

HEATING ELEMENT

- ~15.50" lg.
- 741W, 120VAC, ~19Ω

Fits: Heater Connector Assembly in Hood

Model: Resuscitaire (RW82-1)

120VAC

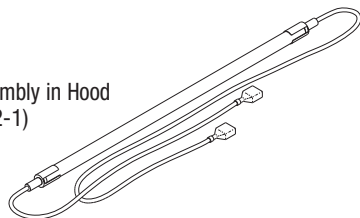

RPI Part #AIH127
OEM Part #MU11223 & 81 202 80

HEATING ELEMENT

- ~15.50" lg.
- 741W, 220VAC, ~62Ω

Fits: Heater Connector Assembly in Hood

Model: Resuscitaire (RW82-1)

220VAC

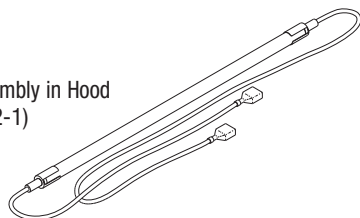

RPI Part #AIP130
OEM Part #MU11228, 81 300 06 & 81 300 08

SKIN TEMPERATURE PROBE (DISPOSABLE)

- Includes (10) probes and (10 pieces) Reflective Probe Cover (RPI Part #RPC619)
- 6 pin din plug
- Single use only

Fits: Controller

Model: Resuscitaire (RW82-1)

ALSO AVAILABLE BY THE CASE
RPI Part #AIP131 - 100/CASE
OEM Part #MU11229 & 81 300 09

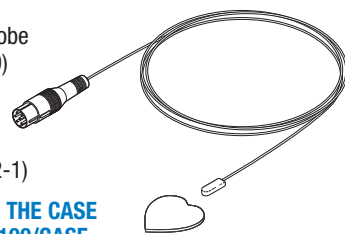

RPI Part #AIP132
OEM Part #MU11225 & 81 300 05

SKIN TEMPERATURE PROBE (REUSABLE)

- 6 pin din plug

Fits: Controller

Model: Resuscitaire (RW82-1)

*Reflective Probe Covers also available
- See RPI Part #RPC619*

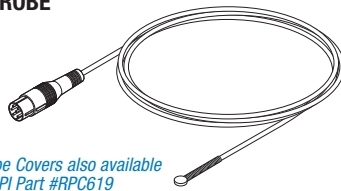

RPI Part #RPC619
OEM Part #MU06944 & 68 209 48

REFLECTIVE PROBE COVER

- 100 per package
- Single use only
- Metalized Mylar with PSA backing; Latex Free

Fits: Skin Temperature Probe

Models: All Infant Warmer and Incubator Skin Temperature Probes



Model: Versalet® 7700

RPI Part #AIH102
OEM Part #MU14092 & 84 607 83

HEATING ELEMENT

- ~18" lg.
- 350W, 120VAC, ~39Ω

Fits: Overhead Assembly

Model: Versalet 7700

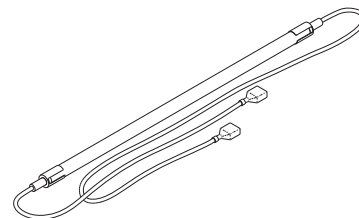

RPI Part #AIP133
OEM Part #MU12551 & 83 104 15

SKIN TEMPERATURE PROBE (DISPOSABLE)

- Includes (10) probes and (10 pieces) Reflective Probe Cover (RPI Part #RPC619)
- 6 pin connector
- Single use only

Fits: Controller

Model: Versalet 7700

ALSO AVAILABLE BY THE CASE
RPI Part #AIP134 - 100/CASE
OEM Part # (No OEM Part # Available)

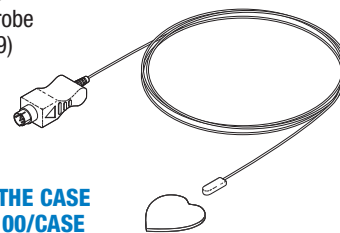

RPI Part #AIF140
OEM Part #MU12504 & 83 101 30

MICRO FILTER

- 4 per package
- ~3" x 5-1/2"
- Synthetic media - contains *no* glass fibers
- Latex free

Fits: Filter Housing

Model: Versalet 7700

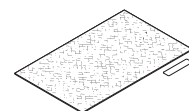

Includes installation date label

RPI Part #AIP135
OEM Part #MU12533 & 83 102 41

SKIN TEMPERATURE PROBE (REUSABLE)

- 6 pin connector

Fits: Controller

Model: Versalet 7700

*Reflective Probe Covers also available
- See RPI Part #RPC619*

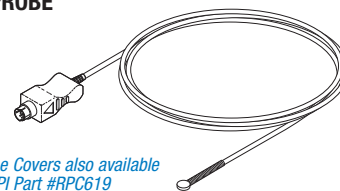

RPI Part #RPC619
OEM Part #MU06944 & 68 209 48

REFLECTIVE PROBE COVER

- 100 per package
- Single use only
- Metalized Mylar with PSA backing; Latex Free

Fits: Skin Temperature Probe

Models: All Infant Warmer and Incubator Skin Temperature Probes



Infant Warmers

Model: Versalet® 7700 (Continued)

RPI Part #AIL145
OEM Part #MU12681 (Latch Only) & 83 300 09 (Latch Only)

LATCH (HEAT SHIELD)

- Includes all parts as shown
- Fits:** Hood Assembly
- Model:** Versalet 7700

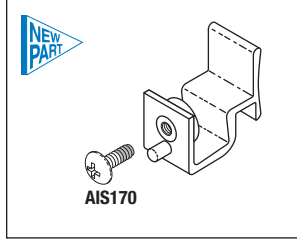

RPI Part #AIS170
OEM Part #MU15127 & 99 023 51

SCREW (#6-32 x 3/8)

- 2 per package
- Material: Stainless steel supplied with pre-applied thread locker
- Size: #6-32 x 3/8" Ig. Phillips Truss Head Screw
- Also included in: Latch (Heat Shield) (RPI Part #AIL145)
- Model:** Versalet 7700

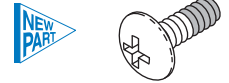

RPI Part #AIF157
OEM Part #MU12299 (Fan Only) & 83 005 46 (Fan Only)

FAN ASSY (SENSOR MODULE)

- Size: 1.575" x 1.575" x .413" fan housing
- 10.8 to 13.2 VDC; 4200 RPM
- Includes all parts as shown

Fits: Sensor Module
Model: Versalet 7700

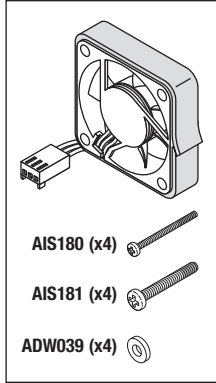

RPI Part #AIS180
OEM Part #MU15095 & 99 012 33

SCREW (#4-40 x 1)

- 4 per package
- Material: Stainless steel supplied with pre-applied thread locker
- Size: #4-40 x 1.0" Ig. Phillips Pan Head Screw
- Model:** Versalet 7700

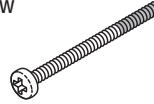

RPI Part #AIS181
OEM Part #MU15153 & 99 024 98

SCREW (#6-32 x 15/16)

- 4 per package
- Material: Stainless steel supplied with pre-applied thread locker
- Size: #6-32 x 15/16" Ig. Phillips Pan Head Screw
- Model:** Versalet 7700

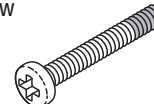

RPI Part #ADW039
OEM Part #MU15510 & 99 121 22

FLAT WASHER (#6)

- 15 per package
- Material: Nylon®
- Size: .140" ID x .320" OD x .030" thk
- Model:** Versalet 7700



RPI Part #AIC156
OEM Part #MU12287 (Cable Only) & 83 005 30 (Cable Only)

SENSOR MODULE CABLE ASSY

- Length: ~32"
- Includes all parts as shown
- Fits:** Sensor Module
- Model:** Versalet 7700

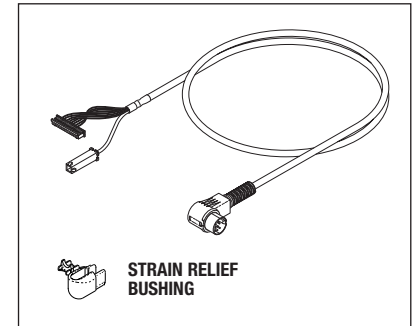

NOTES: _____

RPI Part #0MH001
OEM Part #6600-0014-850

HEATING ELEMENT

- ~19" lg.
- 540W, 104VAC, ~19Ω
- Includes (2) #10-32 x .31" lg. screws

Fits: Overhead Assembly

Models: Infant Warmer Systems (IWS) 2001, 3000, 3050, 3100, 3150, 3300 (Panda), 3400 & 3500 - with HCA or HCC Serial Numbers

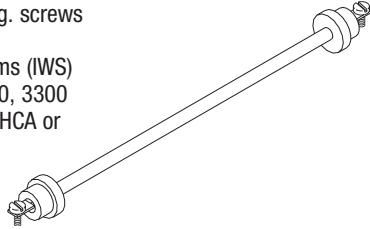

RPI Part #0MH003
OEM Part #6600-0284-800

HEATING ELEMENT

- ~19"
- 440W, 104VAC, ~23Ω
- Includes (2) #10-32 x .31" lg. screws

Fits: Overhead Assembly

Models: Infant Warmer Systems (IWS) 2001, 3000, 3050, 3100, 3150, 3300 (Panda), 3400 & 3500 - with HAJ or AAN Serial Number

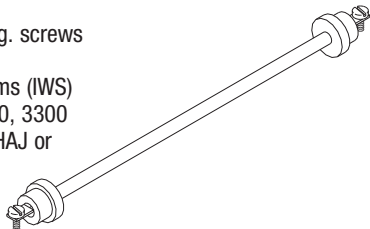

RPI Part #0MH004
OEM Part #6600-0280-800

HEATING ELEMENT

- ~23" lg.
- 540W, 104VAC, ~19Ω
- Includes (2) #10-32 x .31" lg. screws

Fits: Overhead Assembly

Models: Infant Warmer Systems (IWS) 4000, 4300, 4400 & 5000

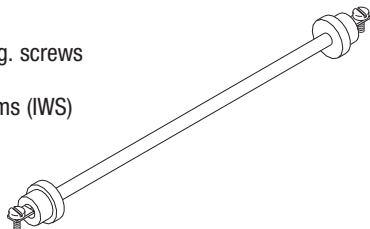

RPI Part #LMP014
OEM Part #0208-0516-300

LAMP

- 12V, 50W
- Base: 2-pin
- Type: Halogen; EXN

Fits: Connector Assembly

Model: Infant Warmer Systems (IWS) 2001, 3000, 3050, 3100, 3150, 3300 (Panda), 3400, 3500, 4000, 4300, 4400 & 5000

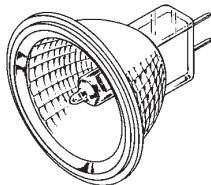

RPI Part #OMP006
OEM Part #6600-0208-700

SKIN TEMPERATURE PROBE (DISPOSABLE)

- Includes (10) probes and (10 pieces) Reflective Probe Cover (RPI Part #RPC619)

- Single use only
- 1/8" mono jack

Fits: Controller

Models: Infant Warmer Systems (IWS) 2001, 3000, 3050, 3100, 3150, 3300 (Panda), 3400, 3500, 4000, 4300, 4400 & 5000

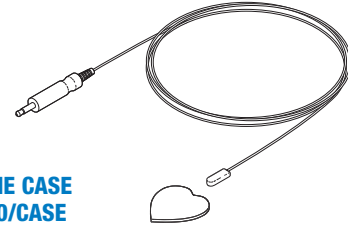

ALSO AVAILABLE BY THE CASE
RPI Part #OMP007 - 50/CASE
OEM Part #6600-0196-700

RPI Part #OMP008
OEM Part #6600-0628-700 & 0208-0697-700

SKIN TEMPERATURE PROBE (REUSABLE)

- 1/8" mono jack

Fits: Controller

Models: Infant Warmer Systems (IWS) 2001, 3000, 3050, 3100, 3150, 3300 (Panda), 3400, 3500, 4000, 4300, 4400 & 5000

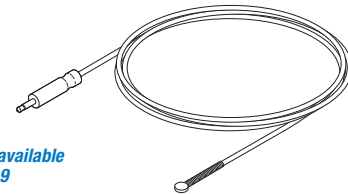

*Reflective Probe Covers also available
- See RPI Part #RPC619*

RPI Part #RPC619
OEM Part #0203-1980-300 (Ohio•Ohmeda•GE)

REFLECTIVE PROBE COVER

- 100 per package
- Single use only
- Metalized Mylar with PSA backing; Latex Free

Fits: Skin Temperature Probe

Models: All Infant Warmer and Incubator Skin Temperature Probes



RPI is your best source for quality replacement parts.

Phototherapy Lights

Air Shields • Hill-Rom • Drager Models: PT1400, PT1400-1, PT1400-2, PT1400-2E, PT533, PTM-78-2 & IICS Phototherapy System 7850

RPI Part #LMP016
OEM Part #43 003 65

- LAMP (120V, 250W)**
- Blue Phototherapy/Procedure Light
 - Base: 2 pin
 - Type: Halogen, ENH
- Models:** PT1400 & PT1400-1

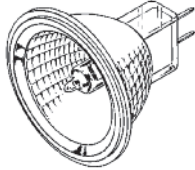

RPI Part #LMP017
OEM Part #43 004 70

- LAMP (20V, 150W)**
- Cream Phototherapy/Procedure Light
 - Base: 2 pin
 - Type: Halogen, DDL
- Models:** PT1400-2 & PT1400-2E

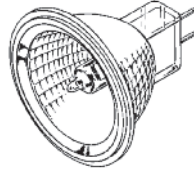

RPI Part #LMP018
OEM Part #0208-0516-300/17 807 45

- LAMP (12V, 50W)**
- Base: 2 pin
 - Type: Halogen, EXZ/CC
- Models:** IICS Phototherapy System 7850 & PTM-78-2

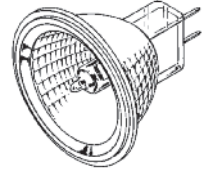

RPI Part #LMP019
OEM Part #17 806 61

- FLUORESCENT LAMP (BLUE)**
- 20W, 120V
 - 1.50" OD x 24" lg.
- Model:** PT533

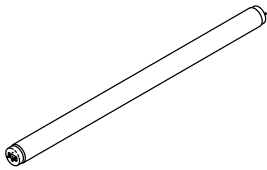

RPI Part #LMP020
OEM Part #17 806 94

- FLUORESCENT LAMP (WHITE)**
- 20W, 120V
 - 1.50" OD x 24" lg.
- Model:** PT533

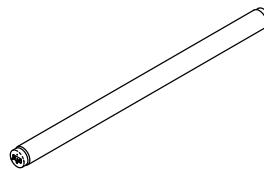

Since 1972, health-care professionals have relied on RPI for quality replacement parts.

GE • Ohmeda Models: Biliblanket Plus, Biliblanket Plus High Output, & Giraffe® Spot PT Lite

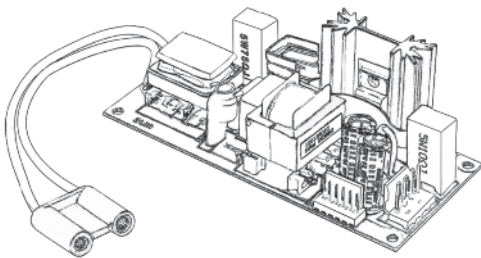

RPI Part #OMB061
OEM Part #6600-0248-850

- BALLAST (50W REGULATED)**
- 50 VDC, 50 W
 - Used with 50W Solarc™ lamp only
 - Also available: Lamp (52V, 50W) (RPI Part #LMP029)
- Fits:** Chassis
Models: Giraffe Spot PT Lite

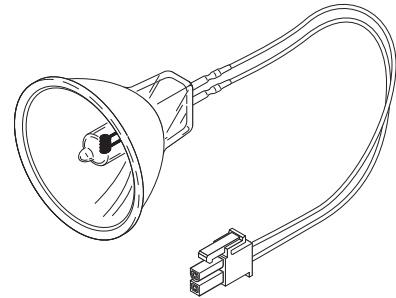

RPI Part #LMP028
OEM Part #6600-0680-200

- LAMP (12VDC, 100W)**
- 6 per package
 - Includes: Attached wire harness and connector
 - Halogen
- Fits:** Lamp holder
Models: Biliblanket Plus & Biliblanket Plus High Output

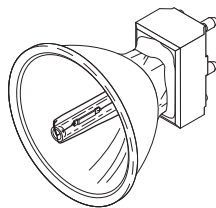

RPI Part #LMP029
OEM Part #6600-0235-850

- LAMP (52VDC, 50W)**
- Metal Halide Solarc™ brand
 - 2 Pin
 - Also available: Ballast (50W regulated) (RPI Part #OMB061)
- Fits:** Lamp Ballast
Models: Giraffe Spot PT Lite

Call Us Toll-Free Monday–Friday, 8:00 AM–4:30 PM (Pacific Time), (800) 221-9723

