



RPI Part #ADK190

OEM Part # (No OEM Part # Available)

CONTROL BLOCK KIT (MAJOR)

• Includes all parts as shown

Fits: Handpiece Control Block

Models: Hanpiece Control Block - Century Plus

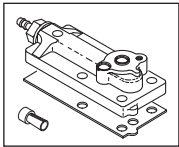

RPI Part #ADA166

OEM Part #38.0546.00

CONTROL BLOCK CAP ASSEMBLY

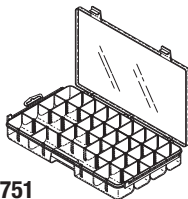

RPI Part #RPC751

OEM Part # (No OEM Part # Available)

STORAGE CASE

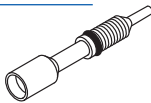

(4x)

RPI Part #ADS233

OEM Part #38.0516.00

STEM (WATER FLOW ADJ.)

(4 pieces)

RPI Part #ADV161

OEM Part #38-0518-00

CARTRIDGE (CHECK VALVE)

(4 pieces)

RPI Part #ADV162

OEM Part #38-0517-00

CARTRIDGE (AIR BLEED VALVE)

(4 pieces)

RPI Part #ADV163

OEM Part #38-0520-00

CARTRIDGE (WATER VALVE)

(1 pack of 3)

RPI Part #ADA165

OEM Part #38.0514.00

WATER VALVE ACTUATOR



(1 pack of 3)

RPI Part #ADP188

OEM Part #38.0646.00 (Kit)

PLUG (CHECK VALVE)



(1 pack of 3)

RPI Part #ADP189

OEM Part #38.0646.00 (Kit)

PLUG (WATER VALVE)



(1 pack of 3)

RPI Part #ADS168

OEM Part #38.0510.00

STEM (DRIVE AIR ADJ.)

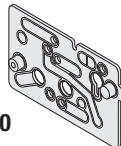

(1 pack of 5)

RPI Part #ADG158

OEM Part #38-0550-00

RED GASKET



(1 pack of 5)

RPI Part #ADS169

OEM Part #002-118-00

BUTTON HEAD CAP SCREW

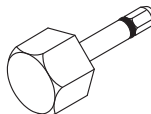

(1 PACK OF 5)

RPI Part #ADT242

OEM Part #38.1808.01 & 98.0867.02

STEM ADJUSTMENT TOOL



(1 pack of 3)

RPI Part #ADW186

OEM Part #004-078-00

FLAT WASHER



(1 pack of 5)

RPI Part #RPL090

OEM Part #98.0090.01

HIGH TEMP LUBRICANT



(1 pack of 10)

RPI Part #ADB011

OEM Part #023-001-01

BARB

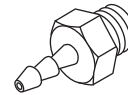

(1 pack of 10)

RPI Part #ADB012

OEM Part #023-004-01 & 023.004.03

BARB

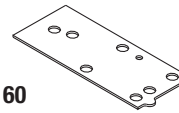

(1 pack of 10)

RPI Part #ADD160

OEM Part #38-0519-01

DIAPHRAGM

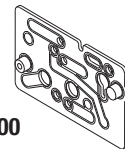

(1 pack of 10)

RPI Part #ADG159

OEM Part #38-0507-00

CLEAR GASKET



(1 pack of 10)

RPI Part #ADP057

OEM Part #021-016-01 & 021.016.01

HEX PLUG



(1 pack of 10)

RPI Part #ADS052

OEM Part #001-002-00

TRUSS HEAD SLOTTED SCREW



(1 pack of 10)

RPI Part #ADS195

OEM Part #013-021-00

COMPRESSION SPRING



Shown Actual Size

(1 pack of 12)

RPI Part #RP0309

OEM Part #030-001-00

O-RING



Shown Actual Size

(1 pack of 12)

RPI Part #RP0311

OEM Part #030-003-00

O-RING



(1 pack of 15)

RPI Part #ADW039

OEM Part #004-036-00

FLAT WASHER

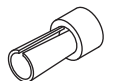

(1 pack of 20)

RPI Part #ADC034

OEM Part #025.007.01

UNI-CLAMP

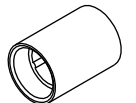

(1 pack of 20)

RPI Part #ADC035

OEM Part #025-015-01

SLEEVE CLAMP



(1 pack of 25)

RPI Part #ADS117

OEM Part #001-024-00

SOCKET HEAD CAP SCREW



(1 pack of 25)

RPI Part #ADS118

OEM Part #001-021-00

SOCKET HEAD CAP SCREW



(1 PACK OF 50)

RPI Part #ADW038

OEM Part #004-005-00

FLAT WASHER